

# FULLER® 18 SPEED

MODEL RTLO-14918, RTLO16918, RTLO-18918, RTLO-20918, RTLO-20918-T2

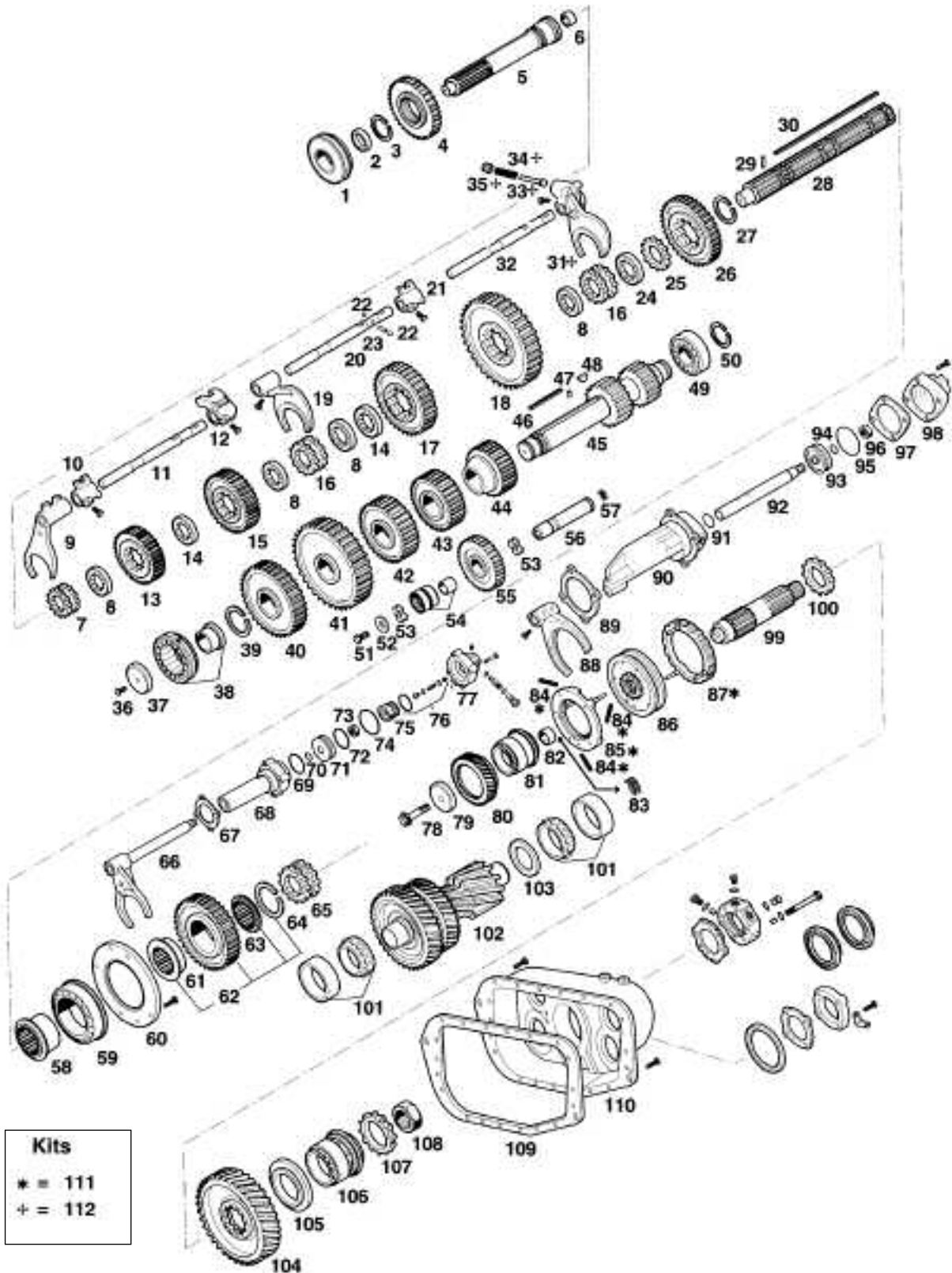

PARTS LISTED IN THIS CATALOG ARE NOT NECESSARILY MANUFACTURED BY THE ORIGINAL EQUIPMENT MANUFACTURER AND ANY REFERENCE TO THE TRADEMARKS OR PART NUMBERS OF OTHERS ARE FOR CROSS REFERENCE INFORMATIONAL PURPOSES ONLY. THE TRADEMARKS OF OTHERS REFERRED TO HEREIN ARE OWNED BY THEIR RESPECTIVE COMPANIES AND ARE NOT AFFILIATED IN ANY WAY WITH MIDWEST TRUCK & AUTO PARTS, INC.® MOTIVE GEAR® AND WORLD AMERICAN® ARE THE REGISTERED TRADEMARKS OF MIDWEST TRUCK & AUTO PARTS, INC.® USE OF THE ® IN CONNECTION WITH A MARK OF MIDWEST TRUCK & AUTO PARTS, INC.® INDICATES THAT THE MARK IS REGISTERED IN AT LEAST THE UNITED STATES. NO REPRESENTATION IS MADE WITH RESPECT TO THE SOURCE OF MANUFACTURE OF ANY PARTICULAR PART. © 2005, MIDWEST TRUCK & AUTO PARTS, INC.® ALL RIGHTS RESERVED.

# FULLER® 18 SPEED

FIG.	PART#	DESCRIPTION	RTLO-14918	RTLO-16918	RTLO-18918	RTLO-20918	RTLO-20918-T2
1	212SLV	BEARING			X	X	X
2	16463	SPACER	X	X	X	X	X
3	14750	SNAP RING	X	X	X	X	X
4	4300238	GEAR MAIN DRIVE 52T	X				
4	4304510	GEAR MAIN DRIVE		X	X	X	X
5	<b>INPUT SHAFTS (SEE PG. 331)</b>		X	X	X	X	X
6	16566	BUSHING	X	X	X	X	X
7	22026	SLIDING CLUTCH	X	X	X	X	X
8	4302398	WASHER	X	X	X	X	X
9	20450	SHIFT YOKE	X	X	X	X	X
10	20120	SHIFTING BLOCK	X	X	X	X	X
11	18928	YOKE BAR	X	X	X	X	X
12	19063	SHIFTING BLOCK	X	X	X	X	X
13	4302393	GEAR M/S 42T	X				
13	4304514	GEAR M/S	X	X	X	X	
14	4303603	WASHER	X	X	X	X	X
15	4302394	GEAR M/S 50T	X	X			
15	4302670	GEAR M/S		X			
15	4304516	GEAR M/S 50T				X	X
16	16118	SLIDING CLUTCH	X	X	X	X	X
17	4303420	GEAR M/S	X	X			
17	4303701	GEAR M/S		X	X	X	
18	4303409	GEAR M/S	X	X	X	X	X
19	18922	SHIFT YOKE	X	X	X	X	X
20	18927	YOKE BAR	X	X	X	X	X
21	14658	SHIFTING BLOCK	X	X	X	X	X
22	X-14-1200	BALL	X	X	X	X	X
23	1634	PIN	X	X	X	X	X
24	4300382	WASHER	X	X	X	X	X
25	4302047	SPACER	X	X	X	X	X
26	16756	REVERSE GEAR M/S 46T	X	X	X	X	X
27	14750	SNAP RING	X	X	X	X	X
28	S-2562	MAIN SHAFT 17T	X	X			
28	S-2560	MAIN SHAFT			X	X	X
29	62504	PIN 3X16	X	X	X	X	X
30	4300120	KEY	X	X	X	X	X
31	16131	REVERSE YOKE	X	X	X	X	X
32	18926	YOKE BAR	X	X	X	X	X
33	10019	PIN	X	X	X	X	X
34	6392	SPRING	X	X	X	X	X
35	8968	PLUG	X	X	X	X	X
36	X-7-1005	BOLT 5/8"	X	X	X	X	X

PARTS LISTED IN THIS CATALOG ARE NOT NECESSARILY MANUFACTURED BY THE ORIGINAL EQUIPMENT MANUFACTURER AND ANY REFERENCE TO THE TRADEMARKS OR PART NUMBERS OF OTHERS ARE FOR CROSS REFERENCE INFORMATIONAL PURPOSES ONLY. THE TRADEMARKS OF OTHERS REFERRED TO HEREIN ARE OWNED BY THEIR RESPECTIVE COMPANIES AND ARE NOT AFFILIATED IN ANY WAY WITH MIDWEST TRUCK & AUTO PARTS, INC.® MOTIVE GEAR® AND WORLD AMERICAN® ARE THE REGISTERED TRADEMARKS OF MIDWEST TRUCK & AUTO PARTS, INC.® USE OF THE ® IN CONNECTION WITH A MARK OF MIDWEST TRUCK & AUTO PARTS, INC.® INDICATES THAT THE MARK IS REGISTERED IN AT LEAST THE UNITED STATES. NO REPRESENTATION IS MADE WITH RESPECT TO THE SOURCE OF MANUFACTURE OF ANY PARTICULAR PART. © 2005, MIDWEST TRUCK & AUTO PARTS, INC.® ALL RIGHTS RESERVED.

# FULLER®

## 18 SPEED (Cont'd)

FIG.	PART#	DESCRIPTION	RTLO-14918	RTLO-16918	RTLO-18918	RTLO-20918	RTLO-20918-T2
37	19548	LOCKING DISK	X	X	X	X	X
38	BS500192S	BEARING	X	X	X	X	X
39	19198	SNAP RING	X	X	X	X	X
40	21018	GEAR C/S 66T	X				
40	4304060	GEAR C/S	X				
40	4302666	GEAR C/S		X			
40	4304512	GEAR C/S			X	X	
41	15953	GEAR C/S PTO 47T LH PTO (LEFT)	X	X	X	X	X
41	20840	GEAR C/S PTO 45T RH PTO (RIGHT)	X	X	X	X	X
42	4300191	GEAR C/S 73T	X				
42	4303666	GEAR C/S	X	X			
42	4304508	GEAR C/S			X	X	
43	21264	GEAR C/S 46T	X	X			
43	4300247	GEAR C/S		X			
43	4304518	GEAR C/S			X	X	
44	21025	GEAR C/S 1ST 39T	X	X			
44	4304520	GEAR C/S		X	X	X	
45	19549	COUNTERSHAFT 17T	X				
45	K-2953	COUNTERSHAFT KIT W/KEYS	X				
45	K-2947	COUNTERSHAFT KIT		X	X	X	X
46	19673	KEY	X	X	X	X	X
47	62511	PIN	X	X	X	X	X
48	X-6-E	KEY	X	X	X	X	X
49	MU1308TV	BEARING	X				
49	4302712	BEARING		X	X	X	X
50	14317	SNAP RING	X				
50	4302082	SNAP RING		X	X	X	X
51	X-7-1008	SCREW 5/8"	X	X	X	X	X
52	14283	WASHER	X	X	X	X	X
53	4302982	WASHER	X	X	X	X	X
54	FWA1830	BEARING	X	X	X	X	X
55	16757	REVERSE GEAR 27T	X	X	X	X	X
56	4302981	REVERSE GEAR PIN	X	X	X	X	X
57	4303336	RETAINING RING					
58	4303673	SPACER	X				
58	4304499	SPACER		X	X	X	X
59	6217-3BBN	BEARING	X				
59	5566510	BEARING		X	X	X	X
60	4300894	RETAINER RING	X				
60	4304497	RETAINER RING		X	X	X	X
61	4300911	SPACER	X				
61	4304500	SPACER		X	X	X	X
62	K-2808	GEAR AUX. DRIVE	X	X	X		

PARTS LISTED IN THIS CATALOG ARE NOT NECESSARILY MANUFACTURED BY THE ORIGINAL EQUIPMENT MANUFACTURER AND ANY REFERENCE TO THE TRADEMARKS OR PART NUMBERS OF OTHERS ARE FOR CROSS REFERENCE INFORMATIONAL PURPOSES ONLY. THE TRADEMARKS OF OTHERS REFERRED TO HEREIN ARE OWNED BY THEIR RESPECTIVE COMPANIES AND ARE NOT AFFILIATED IN ANY WAY WITH MIDWEST TRUCK & AUTO PARTS, INC.® MOTIVE GEAR® AND WORLD AMERICAN® ARE THE REGISTERED TRADEMARKS OF MIDWEST TRUCK & AUTO PARTS, INC.® USE OF THE ® IN CONNECTION WITH A MARK OF MIDWEST TRUCK & AUTO PARTS, INC.® INDICATES THAT THE MARK IS REGISTERED IN AT LEAST THE UNITED STATES. NO REPRESENTATION IS MADE WITH RESPECT TO THE SOURCE OF MANUFACTURE OF ANY PARTICULAR PART. © 2005, MIDWEST TRUCK & AUTO PARTS, INC.® ALL RIGHTS RESERVED.

# FULLER®

## 18 SPEED (Cont'd)

FIG.	PART#	DESCRIPTION	RTLO-14918	RTLO-16918	RTLO-18918	RTLO-20918	RTLO-20918-T2
62	4304084	GEAR AUX. DRIVE (ONLY GEAR)				X	X
63	4303185	WASHER	X	X	X	X	X
64	4301254	SNAP RING	X	X	X	X	X
65	4300907	SLIDING CLUTCH	X	X	X	X	X
66	A-6304	WELDED YOKE ASSY	X	X	X	X	X
67	4303583	GASKET	X	X	X	X	X
68	4303582	CYLINDER	X	X	X	X	X
69	21208	O-RING	X	X	X	X	X
70	13653	O-RING	X	X	X	X	X
71	4301964	PISTON	X	X	X	X	X
72	21209	O-RING	X	X	X	X	X
73	X-1-805	NUT	X	X	X	X	X
74	5568534	O-RING	X	X	X	X	X
75	4304033	SEAL PLATE	X	X	X	X	X
76	K-3329	REPAIR KIT	X	X	X	X	X
77	K-3331	REPAIR KIT	X	X	X	X	X
78	X-7-1007	BOLT	X	X	X	X	X
79	4301843	RETAINER	X	X	X	X	X
80	4303421	GEAR	X	X	X		
80	4304086	GEAR				X	X
81	4300902	BEARING	X	X	X	X	X
82	4301844	BEARING SLEEVE	X	X	X	X	X
83	4303424	SNAP RING	X	X	X	X	X
84	14897	SPRING	X	X	X	X	X
85	A-4938	SYNCHRONIZER RING	X	X	X	X	X
86	4303386	SLIDING CLUTCH	X	X	X	X	X
87	A-4937	SYNCHRONIZER RING	X	X	X	X	X
88	22823	SHIFT YOKE	X	X	X	X	X
89	14347	GASKET	X	X	X	X	X
90	A-6690	CYLINDER ASSY	X	X	X	X	X
91	14765	O-RING	X	X	X	X	X
92	4303596	YOKE BAR	X	X	X	X	X
93	14341	PISTON	X	X	X	X	X
94	14345	O-RING	X	X	X	X	X
95	14344	O-RING	X	X	X	X	X
96	X-1-1010	NUT 5/8"	X	X	X	X	X
97	22826	GASKET	X	X	X	X	X
98	4303926	COVER	X	X	X	X	X
99	4303705	MAIN SHAFT	X	X	X	X	X
100	4301842	WASHER	X	X	X	X	X
101	4301851	BEARING	X				
102	K-3221	AUX. COUNTERSHAFT ASSY W/WASHER		X	X		

PARTS LISTED IN THIS CATALOG ARE NOT NECESSARILY MANUFACTURED BY THE ORIGINAL EQUIPMENT MANUFACTURER AND ANY REFERENCE TO THE TRADEMARKS OR PART NUMBERS OF OTHERS ARE FOR CROSS REFERENCE INFORMATIONAL PURPOSES ONLY. THE TRADEMARKS OF OTHERS REFERRED TO HEREIN ARE OWNED BY THEIR RESPECTIVE COMPANIES AND ARE NOT AFFILIATED IN ANY WAY WITH MIDWEST TRUCK & AUTO PARTS, INC.® MOTIVE GEAR® AND WORLD AMERICAN® ARE THE REGISTERED TRADEMARKS OF MIDWEST TRUCK & AUTO PARTS, INC.® USE OF THE ® IN CONNECTION WITH A MARK OF MIDWEST TRUCK & AUTO PARTS, INC.® INDICATES THAT THE MARK IS REGISTERED IN AT LEAST THE UNITED STATES. NO REPRESENTATION IS MADE WITH RESPECT TO THE SOURCE OF MANUFACTURE OF ANY PARTICULAR PART. © 2005, MIDWEST TRUCK & AUTO PARTS, INC.® ALL RIGHTS RESERVED.

**FULLER®**  
**18 SPEED (Cont'd)**

FIG.	PART#	DESCRIPTION	RTLO-14918	RTLO-16918	RTLO-18918	RTLO-20918	RTLO-20918-T2
102	K-3220	AUX. COUNTERSHAFT ASSY W/WASHER				X	X
102	A-6888	AUX. COUNTERSHAFT ASSY	X	X	X	X	X
103	4303124	WASHER	X	X	X	X	X
104	4301795	GEAR M/S 52T	X	X	X	X	X
105	4300912	SPACER	X	X	X	X	X
106	5556503	BEARING	X	X	X	X	X
107	20191	SPACER	X	X	X	X	X
108	4302321	NUT	X	X	X	X	X
109	14335	GASKET	X	X	X	X	X
110	4303586	COVER	X	X	X	X	X
111	K-1946	SYNCHRONIZER KIT	X	X	X	X	X
112	S-1219	YOKE ASSY	X	X	X	X	X
113	K-1947	SYNCHRO KIT W/SLIDING CLUTCH (OLD)	X	X	X	X	X
113	K-1948	SYNCHRO KIT W/SLIDING CLUTCH (NEW)	X	X	X	X	X

**CALL YOUR SALES REP FOR BEARING & SEAL KITS**

PARTS LISTED IN THIS CATALOG ARE NOT NECESSARILY MANUFACTURED BY THE ORIGINAL EQUIPMENT MANUFACTURER AND ANY REFERENCE TO THE TRADEMARKS OR PART NUMBERS OF OTHERS ARE FOR CROSS REFERENCE INFORMATIONAL PURPOSES ONLY. THE TRADEMARKS OF OTHERS REFERRED TO HEREIN ARE OWNED BY THEIR RESPECTIVE COMPANIES AND ARE NOT AFFILIATED IN ANY WAY WITH MIDWEST TRUCK & AUTO PARTS, INC.® MOTIVE GEAR® AND WORLD AMERICAN® ARE THE REGISTERED TRADEMARKS OF MIDWEST TRUCK & AUTO PARTS, INC.® USE OF THE ® IN CONNECTION WITH A MARK OF MIDWEST TRUCK & AUTO PARTS, INC.® INDICATES THAT THE MARK IS REGISTERED IN AT LEAST THE UNITED STATES. NO REPRESENTATION IS MADE WITH RESPECT TO THE SOURCE OF MANUFACTURE OF ANY PARTICULAR PART. © 2005, MIDWEST TRUCK & AUTO PARTS, INC.® ALL RIGHTS RESERVED.