

# FULLER® 10 SPEED MODEL 7608LL SERIES

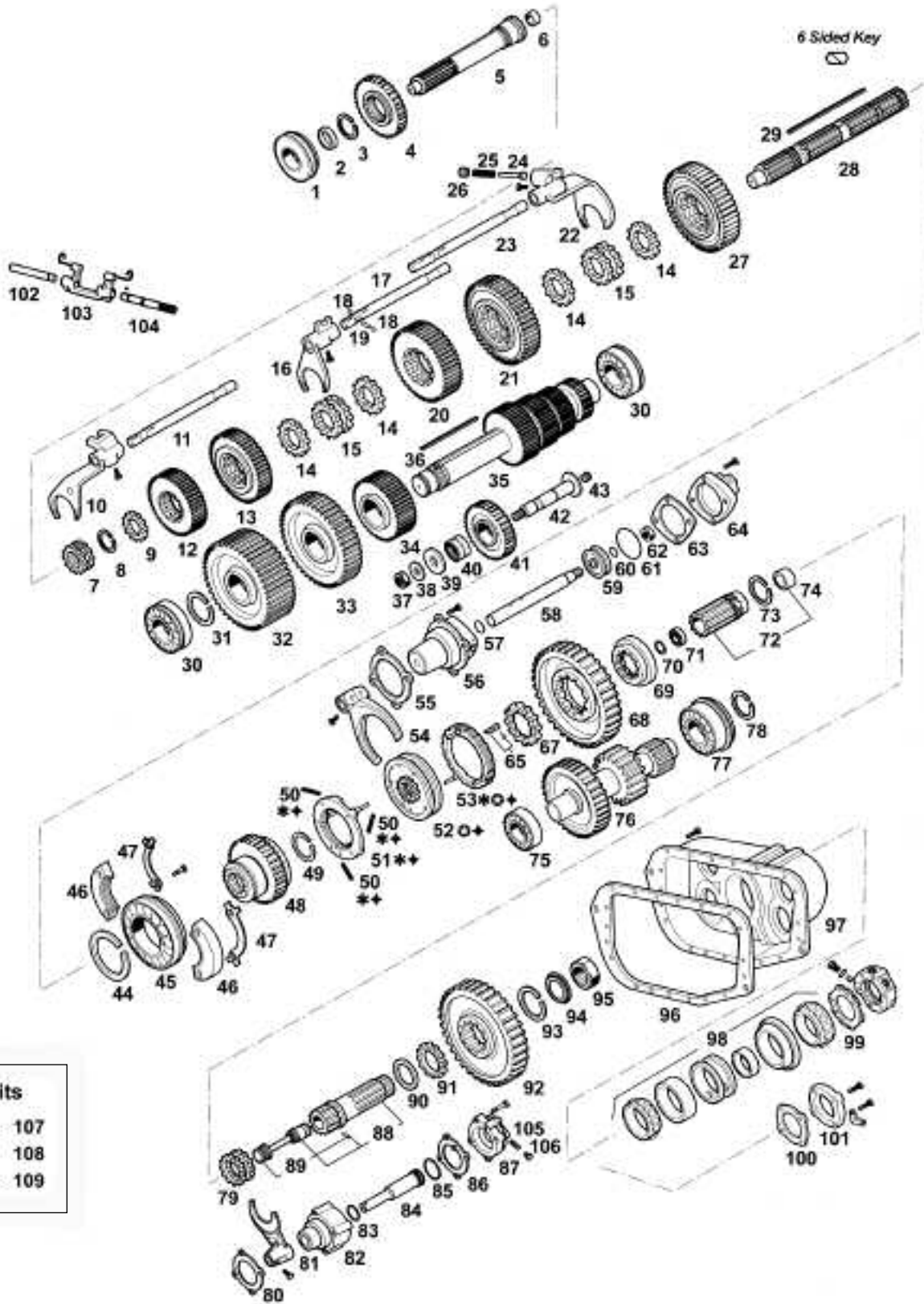

PARTS LISTED IN THIS CATALOG ARE NOT NECESSARILY MANUFACTURED BY THE ORIGINAL EQUIPMENT MANUFACTURER AND ANY REFERENCE TO THE TRADEMARKS OR PART NUMBERS OF OTHERS ARE FOR CROSS REFERENCE INFORMATIONAL PURPOSES ONLY. THE TRADEMARKS OF OTHERS REFERRED TO HEREIN ARE OWNED BY THEIR RESPECTIVE COMPANIES AND ARE NOT AFFILIATED IN ANY WAY WITH MIDWEST TRUCK & AUTO PARTS, INC.® MOTIVE GEAR® AND WORLD AMERICAN® ARE THE REGISTERED TRADEMARKS OF MIDWEST TRUCK & AUTO PARTS, INC.® USE OF THE ® IN CONNECTION WITH A MARK OF MIDWEST TRUCK & AUTO PARTS, INC.® INDICATES THAT THE MARK IS REGISTERED IN AT LEAST THE UNITED STATES. NO REPRESENTATION IS MADE WITH RESPECT TO THE SOURCE OF MANUFACTURE OF ANY PARTICULAR PART. © 2005, MIDWEST TRUCK & AUTO PARTS, INC.® ALL RIGHTS RESERVED.

# FULLER® 10 SPEED

FIG.	PART#	DESCRIPTION	7608LL SERIES
1	81568	BEARING	×
2	20778	SPACER	×
3	15973	SNAP RING	×
4	20671	GEAR MAIN DRIVE	×
5	<b>INPUT SHAFTS (SEE PGS. 323-326)</b>		
6	15977	BUSHING	×
7	21662	SLIDING CLUTCH	×
8	15980	SNAP RING	×
9	21664	WASHER S.6, 58-6, 63 MM (ORANGE)	×
9	21665	WASHER S.6, 68-6, 73 MM (PURPLE)	×
9	21666	WASHER S.6, 81-6, 86 MM (YELLOW)	×
9	21667	WASHER S.6, 93-6, 98 MM (BLACK)	×
9	21668	WASHER S.7, 7.06-7,11 MM (RED)	×
10	20622	SHIFT YOKE 3RD	×
11	15101	YOKE BAR	×
12	21672	GEAR M/S	×
13	20833	GEAR M/S	×
14	20617	WASHER (ORANGE)	×
14	20618	WASHER (PURPLE)	×
14	20619	WASHER (YELLOW)	×
14	20620	WASHER (BLACK)	×
14	20621	WASHER (RED)	×
15	20615	SLIDING CLUTCH	×
16	20624	SHIFT YOKE	×
17	15100	YOKE BAR	×
18	X-14-1200	BALL	×
19	1634	PIN	×
20	20593	GEAR M/S	×

FIG.	PART#	DESCRIPTION	7608LL SERIES
21	20794	GEAR M/S	×
22	20626	SHIFT YOKE	×
23	15910	YOKE BAR	×
24	10019	PIN	×
25	6392	SPRING	×
26	8968	PLUG	×
27	20597	REVERSE GEAR	×
28	20614	MAIN SHAFT	×
29	A-4989	KEY & PIN ASSY	×
30	MU1307GUM	BEARING	×
31	14286	SNAP RING	×
32	20576	GEAR C/S	×
33	20583	GEAR C/S	×
34	20587	GEAR C/S	×
35	A-5030	COUNTERSHAFT ASSY	×
36	20604	KEY	×
37	X-1-1008	NUT	×
38	20613	WASHER	×
39	20612	WASHER	×
40	WJ162116	BEARING	×
41	20608	REVERSE GEAR	×
42	20610	REVERSE GEAR PIN	×
43	5202	PLUG	×
44	15994	SNAP RING	×
45	117L	BEARING	×
46	23064	RETAINER	×
47	23066	LOCK WASHER	×
48	22371	GEAR AUX. DRIVE	×
49	14993	SNAP RING	×
50	14897	SPRING	×
51	A-4938	SYNCHRONIZER RING	×
52	20323	SLIDING CLUTCH	
53	A-4937	SYNCHRONIZER RING	×

PARTS LISTED IN THIS CATALOG ARE NOT NECESSARILY MANUFACTURED BY THE ORIGINAL EQUIPMENT MANUFACTURER AND ANY REFERENCE TO THE TRADEMARKS OR PART NUMBERS OF OTHERS ARE FOR CROSS REFERENCE INFORMATIONAL PURPOSES ONLY. THE TRADEMARKS OF OTHERS REFERRED TO HEREIN ARE OWNED BY THEIR RESPECTIVE COMPANIES AND ARE NOT AFFILIATED IN ANY WAY WITH MIDWEST TRUCK & AUTO PARTS, INC.® MOTIVE GEAR® AND WORLD AMERICAN® ARE THE REGISTERED TRADEMARKS OF MIDWEST TRUCK & AUTO PARTS, INC.® USE OF THE ® IN CONNECTION WITH A MARK OF MIDWEST TRUCK & AUTO PARTS, INC.® INDICATES THAT THE MARK IS REGISTERED IN AT LEAST THE UNITED STATES. NO REPRESENTATION IS MADE WITH RESPECT TO THE SOURCE OF MANUFACTURE OF ANY PARTICULAR PART. © 2005, MIDWEST TRUCK & AUTO PARTS, INC.® ALL RIGHTS RESERVED.

# FULLER®

## 10 SPEED (Cont'd)

FIG.	PART#	DESCRIPTION	7608LL SERIES
54	16775	SHIFT YOKE	×
54	22823	SHIFT YOKE (LATEST)	×
55	14347	GASKET	×
56	16777	AUXILIARY CYLINDER	×
57	14765	O-RING	×
58	16776	YOKE BAR	×
59	14341	PISTON	×
60	14345	O-RING	×
61	14344	O-RING	×
62	X-1-1010	NUT	×
63	14349	GASKET	×
64	19690	CYLINDER COVER	×
65	A-3697	KEY & PIN ASSY	×
67	15932	WASHER S.5, 13-5, 18 MM (BLACK)	×
67	17257	WASHER S.5, 23-5, 28 MM (PURPLE)	×
67	17258	WASHER S.5, 33-5, 38 MM (YELLOW)	×
68	22370	GEAR M/S	×
69	18193	COUPLER M/S	×
70	14291	SNAP RING	×
71	204	BEARING	×
72	K-1546	MAIN SHAFT KIT	×
73	18135	SNAP RING	×
74	16516	BUSHING	×
75	23261	BEARING	×
76	A-5317	COUNTERSHAFT ASSY	×
77	1310L	BEARING	×
78	16723	SNAP RING	×
79	15959	SLIDING CLUTCH	×
80	14632	GASKET	×
81	16517	SHIFT YOKE	×

FIG.	PART#	DESCRIPTION	7608LL SERIES
82	21210	AUXILIARY CYLINDER	×
83	21208	O-RING	×
84	21233	YOKE BAR	×
85	21209	O-RING	×
86	17073	GASKET	×
87	4300927	CYLINDER COVER	×
88	A-4738	OUTPUT SHAFT 18T	×
89	K-1644	REPL. QUILL KIT	×
90	14332	WASHER	×
91	18250	SPACER	×
92	20022	GEAR 46T	×
93	14327	SNAP RING	×
94	16310	WASHER S.7, 93 MM	×
95	22254	NUT	×
96	14335	GASKET	×
97	S-1300	REAR HOUSING	×
98	A3071	BEARING	×
99	15532	GASKET	×
100	17097	GASKET	×
101	16724	COVER	×
102	14494	PEDAL SHAFT	×
103	12817	YOKE-CLUTCH RELEASE	×
104	1984	PEDAL SHAFT	×
104	1983	PEDAL SHAFT	×
105	19974	INSERT VALVE	×
106	15719	PLUG	×
107	K-1946	SYNCHRONIZER KIT	×
108	T20099	SYNCHRO CLUTCH ASSY	×
109	K-1947	SYNCHRO KIT W/ SLIDING CLUTCH (OLD)	×
109	K-1948	SYNCHRO KIT W/ SLIDING CLUTCH (NEW)	×

PARTS LISTED IN THIS CATALOG ARE NOT NECESSARILY MANUFACTURED BY THE ORIGINAL EQUIPMENT MANUFACTURER AND ANY REFERENCE TO THE TRADEMARKS OR PART NUMBERS OF OTHERS ARE FOR CROSS REFERENCE INFORMATIONAL PURPOSES ONLY. THE TRADEMARKS OF OTHERS REFERRED TO HEREIN ARE OWNED BY THEIR RESPECTIVE COMPANIES AND ARE NOT AFFILIATED IN ANY WAY WITH MIDWEST TRUCK & AUTO PARTS, INC.® MOTIVE GEAR® AND WORLD AMERICAN® ARE THE REGISTERED TRADEMARKS OF MIDWEST TRUCK & AUTO PARTS, INC.® USE OF THE ® IN CONNECTION WITH A MARK OF MIDWEST TRUCK & AUTO PARTS, INC.® INDICATES THAT THE MARK IS REGISTERED IN AT LEAST THE UNITED STATES. NO REPRESENTATION IS MADE WITH RESPECT TO THE SOURCE OF MANUFACTURE OF ANY PARTICULAR PART. © 2005, MIDWEST TRUCK & AUTO PARTS, INC.® ALL RIGHTS RESERVED.