

# EATON®

MODELS: 15040S - 19050S - 19055S - 21065S - 22065S

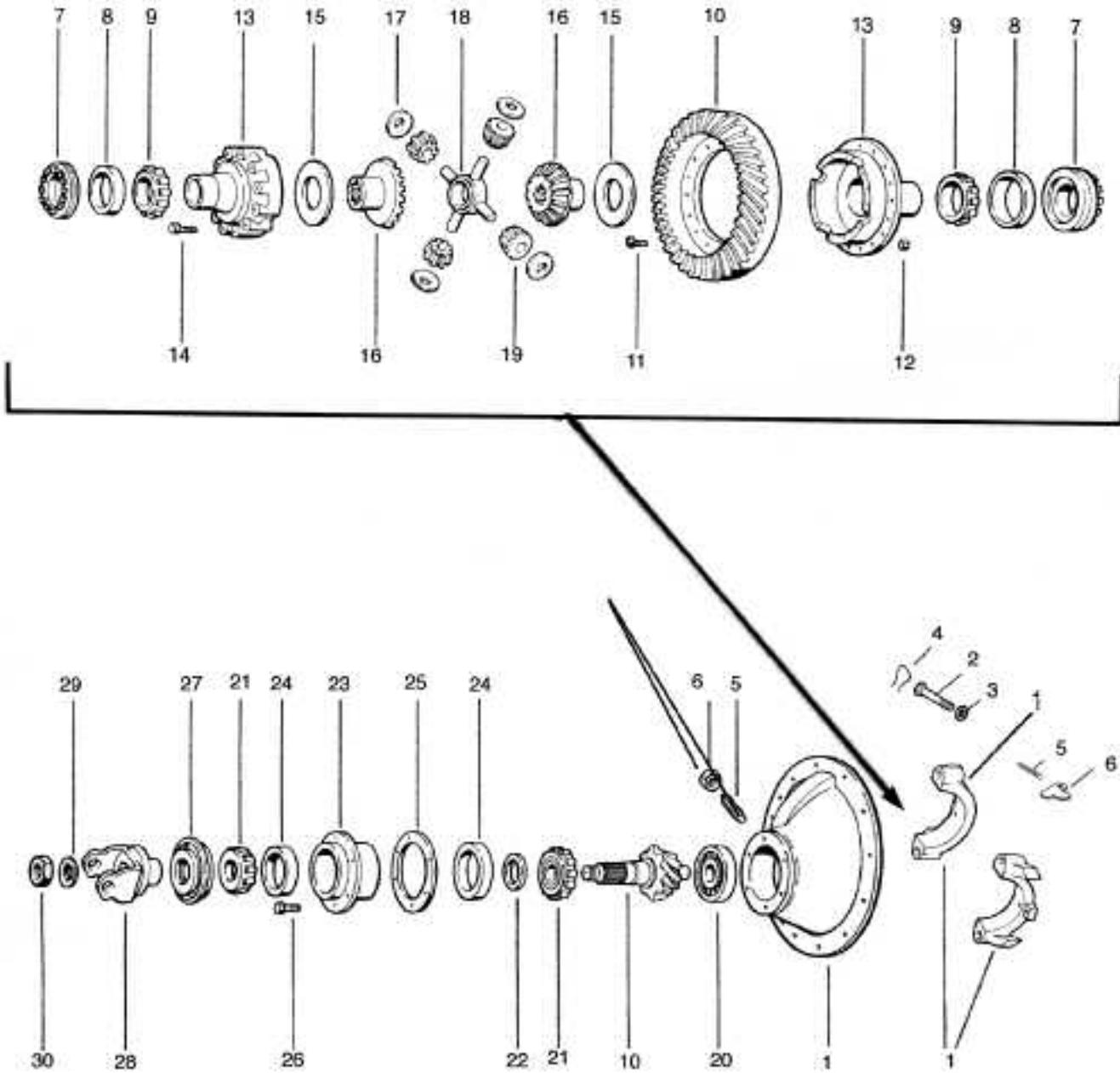

PARTS LISTED IN THIS CATALOG ARE NOT NECESSARILY MANUFACTURED BY THE ORIGINAL EQUIPMENT MANUFACTURER AND ANY REFERENCE TO THE TRADEMARKS OR PART NUMBERS OF OTHERS ARE FOR CROSS REFERENCE INFORMATIONAL PURPOSES ONLY. THE TRADEMARKS OF OTHERS REFERRED TO HEREIN ARE OWNED BY THEIR RESPECTIVE COMPANIES AND ARE NOT AFFILIATED IN ANY WAY WITH MIDWEST TRUCK & AUTO PARTS, INC.® MOTIVE GEAR® AND WORLD AMERICAN® ARE THE REGISTERED TRADEMARKS OF MIDWEST TRUCK & AUTO PARTS, INC.® USE OF THE ® IN CONNECTION WITH A MARK OF MIDWEST TRUCK & AUTO PARTS, INC.® INDICATES THAT THE MARK IS REGISTERED IN AT LEAST THE UNITED STATES. NO REPRESENTATION IS MADE WITH RESPECT TO THE SOURCE OF MANUFACTURE OF ANY PARTICULAR PART. © 2005, MIDWEST TRUCK & AUTO PARTS, INC.® ALL RIGHTS RESERVED.

# EATON®

MODELS: 15040S - 19050S - 19055S - 21065S - 22065S

ITEM NO.	PART NAME	QTY PER AXLE	15040S	19050S	19055S 21065S 22065S	REMARKS
	<b>Bearing, Seal &amp; Gasket Kit</b>	1	RA400R	RA221R	121769	
1	Diff. Carrier & Bearing Caps Carrier Casting No (NSS) Units built after 5-1-1990 Units built after 5-1-1990	1	121737 210316	121754 210393	121774 126044 - -	Includes Items 1-3, 5-6 Includes Items 1-3 Includes Items 1-3
2	Bearing Capscrew	4	210134	210095	210095	
3	Flat Washer	4	210175	210288	210288	
4	Cotter Pin	2	126156	126156	126156	
5	Ring Gear Thrust Screw	1	126193	126193	126193	
6	Thrust Screw Jam Nut	1	210184	210184	210184	
7	Diff. Bearing Adjuster (RH) Diff. Bearing Adjuster (LH)	1 1	210108 210389	210108 210389	210179 210009	Plain Case Side Flange Case Side
8	Diff. Bearing Cup (RH) Diff. Bearing Cup (LH)	1 1	3920 493	3920 493	493 592A	
9	Diff. Bearing Cone (LH) Diff. Bearing Cone (RH)	1 1	497 3994	497 3994	598 497	
10	RING GEAR & DRIVE PINION SET	1	<b>MATCHED PARTS: (SEE SEPARATE LISTING ON PAGE 4)</b>			
	RING GEAR BOLT & NUT KIT	1	121736	121753	121772	Includes Items 11-12
11	Bolt	16	126218	126219	126220	
12	Nut	16	126217	126216	126216	
	WHEEL DIFF CASE KIT	1				Includes Items 13-14
	Ratio Variance					
	3.36 - 3.90		122233			
	4.11 - 4.88		121734			
	5.29 - 7.17		121735			
	3.36 - 4.11			121750		Includes 210389
	4.33   5.29			121751		Diff. Brg.
	5.57 - 7.17			121752		Adjuster
	3.08 - 3.55				211407	
	3.70 - 4.33				121770	
	4.63 - 7.17				121771	
13	Diff. Case (Flange Half) (NSS) Ratio Variance	1				
	3.36 - 3.90		126037			
	4.11 - 4.88		126036			
	5.29 - 7.17		126035			
	3.36 - 4.11			210390		
	4.33 - 5.29			210391		
	5.57 - 7.17			210392		
	3.08 - 3.55				126190	
	3.70 - 4.33				126191	
	4.63 - 7.17				126192	
	Diff. Case (Plain Half) (NSS)	1	126996	126014	210017	
14	Diff. Case Capscrew	12	210469	210469	210091	
	WHEEL DIFF. KIT	1	114467	121748		Includes Items 15-19
					114469	19055S
					114470	21065S/22065S
	WHEEL DIFF. LESS SIDE GEAR KIT	1	118746	121749	118748	Includes Items 15, 17, & 19
15	Side Gear Thrust Washer	2	20850	126004	27827	
16	Diff. Side Gear	2				
	34 Involute Splines		110522			
	36 Involute Splines			126000		
	39 Involute Splines				110525	19055S
	41 Involute Splines				110527	21065S/22065S
17	Side Pinion Thrust Washer	4	25968	126003	27810	
18	Spider	1	20766	126002	38289	
19	Side Pinion	4	102512	126001	104139	
20	Pinion Pilot Bearing	1	MUB1305TDM	RUB1570UM	MUB1308UM	
21	Pinion Bearing Cone (Inner)	1	55175C	72200C	78215C	

**NLA** = No Longer Available  
**NSS** = Not Sold Separately

PARTS LISTED IN THIS CATALOG ARE NOT NECESSARILY MANUFACTURED BY THE ORIGINAL EQUIPMENT MANUFACTURER AND ANY REFERENCE TO THE TRADEMARKS OR PART NUMBERS OF OTHERS ARE FOR CROSS REFERENCE INFORMATIONAL PURPOSES ONLY. THE TRADEMARKS OF OTHERS REFERRED TO HEREIN ARE OWNED BY THEIR RESPECTIVE COMPANIES AND ARE NOT AFFILIATED IN ANY WAY WITH MIDWEST TRUCK & AUTO PARTS, INC.® MOTIVE GEAR® AND WORLD AMERICAN® ARE THE REGISTERED TRADEMARKS OF MIDWEST TRUCK & AUTO PARTS, INC.® USE OF THE ® IN CONNECTION WITH A MARK OF MIDWEST TRUCK & AUTO PARTS, INC.® INDICATES THAT THE MARK IS REGISTERED IN AT LEAST THE UNITED STATES. NO REPRESENTATION IS MADE WITH RESPECT TO THE SOURCE OF MANUFACTURE OF ANY PARTICULAR PART. © 2005, MIDWEST TRUCK & AUTO PARTS, INC.® ALL RIGHTS RESERVED.

# EATON®

MODELS: 15040S - 19050S - 19055S - 21065S - 22065S (Cont'd)

ITEM NO.	PART NAME	QTY PER AXLE			19055S	REMARKS
			15040S	19050S	21065S 22065S	
21	Pinion Bearing Cone (Outer)	1	HM903249	HM903249	55200C	
22	Pinion Bearing Spacer	AR	<b>CALL YOUR SALES REP</b>			
23	Pinion Bearing Cage & Cup Assy Case (NSS)	1	210340 210339	210189 210188	210011 210010	Includes Item 24
24	Pinion Bearing Cup (Inner)	1	55437	72487	78551	
	Pinion Bearing Cup (Outer)	1	HM903210	HM903210	55437	
25	Pinion Bearing Cage Shim	AR				
		.003"	107567	107567	67920	
		.005"	107568	107568	67921	
		.010"	107569	107569	67922	
		.020"	107570	107570	67923	
		.030"	<b>NLA</b>	<b>NLA</b>	67924	
26	Bearing Cage Capscrew	6	210115	210115	210094	
	OIL SEAL & SHIM KIT	1	115551	115551	121773	Includes Items 25 & 27 & RTV
27	Pinion Oil Seal	1	9773	9773	9773	
28	Input Yoke	1	<b>CALL YOUR SALES REP</b>			
29	Washer	1	210114	210114	210090	
30	Pinion Nut	1	210133	210133	210089	
	Gasket Compound	AR	107276	107276	107276	

PARTS LISTED IN THIS CATALOG ARE NOT NECESSARILY MANUFACTURED BY THE ORIGINAL EQUIPMENT MANUFACTURER AND ANY REFERENCE TO THE TRADEMARKS OR PART NUMBERS OF OTHERS ARE FOR CROSS REFERENCE INFORMATIONAL PURPOSES ONLY. THE TRADEMARKS OF OTHERS REFERRED TO HEREIN ARE OWNED BY THEIR RESPECTIVE COMPANIES AND ARE NOT AFFILIATED IN ANY WAY WITH MIDWEST TRUCK & AUTO PARTS, INC.® MOTIVE GEAR® AND WORLD AMERICAN® ARE THE REGISTERED TRADEMARKS OF MIDWEST TRUCK & AUTO PARTS, INC.® USE OF THE ® IN CONNECTION WITH A MARK OF MIDWEST TRUCK & AUTO PARTS, INC.® INDICATES THAT THE MARK IS REGISTERED IN AT LEAST THE UNITED STATES. NO REPRESENTATION IS MADE WITH RESPECT TO THE SOURCE OF MANUFACTURE OF ANY PARTICULAR PART. © 2005, MIDWEST TRUCK & AUTO PARTS, INC.® ALL RIGHTS RESERVED.

# EATON®

MODELS: 15040S - 19050S - 19055S - 21065S - 22065S (Cont'd)

## MODELS

**MODEL: 15040S**  
**Drive Pinion Spline - 34, 1.750" Dia.**

<u>RATIO</u>	<u>PART#</u>	<u>TEETH COUNT</u>
3.36	122347	37-11
3.55	122348	39-11
3.70	122349	37-10
3.90	122350	39-10
4.11	122231	37-9
4.33	122232	39-9
4.63	122351	37-9
4.88	121738	39-8
5.29	121739	37-7
5.57	122331	39-7
5.83	121740	35-6
6.17	121741	37-6
6.50	122019	39-6
7.17	121742	43-6

**MODEL: 19050S**  
**Drive Pinion Spline - 34, 1.750" Dia.**

<u>RATIO</u>	<u>PART#</u>	<u>TEETH COUNT</u>
3.36	122017	37-11
3.55	122014	39-11
3.70	122016	37-10
3.90	121755	39-10
4.11	121756	37-9
4.33	121757	39-9
4.63	121758	37-8
4.88	121759	39-8
5.29	121760	37-7
5.57	121761	39-7
5.83	121762	35-6
6.17	121763	37-6
6.50	121764	39-6
7.17	121765	43-6

**MODEL: 19055S - 19055D - 21065S -  
21065D - 22065S - 22065D**  
**Drive Pinion Spline - 39, 2.000" Dia.**

<u>RATIO</u>	<u>PART#</u>	<u>TEETH COUNT</u>
3.08	122352	37-12
3.25	122353	39-12
3.36	122354	37-11
3.55	122355	39-11
3.70	122211	37-10
3.90	121775	39-10
4.11	122209	37-9
4.33	122109	39-9
4.63	122099	37-8
4.88	121776	39-8
5.29	121777	37-7
5.57	121778	39-7
5.83	122018	35-6
6.17	121779	37-6
6.50	121780	39-6
7.17	121781	43-6

NLA = No Longer Available

NSS = Not Sold Separately

PARTS LISTED IN THIS CATALOG ARE NOT NECESSARILY MANUFACTURED BY THE ORIGINAL EQUIPMENT MANUFACTURER AND ANY REFERENCE TO THE TRADEMARKS OR PART NUMBERS OF OTHERS ARE FOR CROSS REFERENCE INFORMATIONAL PURPOSES ONLY. THE TRADEMARKS OF OTHERS REFERRED TO HEREIN ARE OWNED BY THEIR RESPECTIVE COMPANIES AND ARE NOT AFFILIATED IN ANY WAY WITH MIDWEST TRUCK & AUTO PARTS, INC.® MOTIVE GEAR® AND WORLD AMERICAN® ARE THE REGISTERED TRADEMARKS OF MIDWEST TRUCK & AUTO PARTS, INC.® USE OF THE ® IN CONNECTION WITH A MARK OF MIDWEST TRUCK & AUTO PARTS, INC.® INDICATES THAT THE MARK IS REGISTERED IN AT LEAST THE UNITED STATES. NO REPRESENTATION IS MADE WITH RESPECT TO THE SOURCE OF MANUFACTURE OF ANY PARTICULAR PART. © 2005, MIDWEST TRUCK & AUTO PARTS, INC.® ALL RIGHTS RESERVED.