

# FULLER® 13 SPEED

MODELS RT-11613, RTO-11613, RTOO-11613, RT-14613, RT-14613B, RTO-14613, RTOO-14613, RT-14813, RT-15613, RT-15613B, RTO-15613

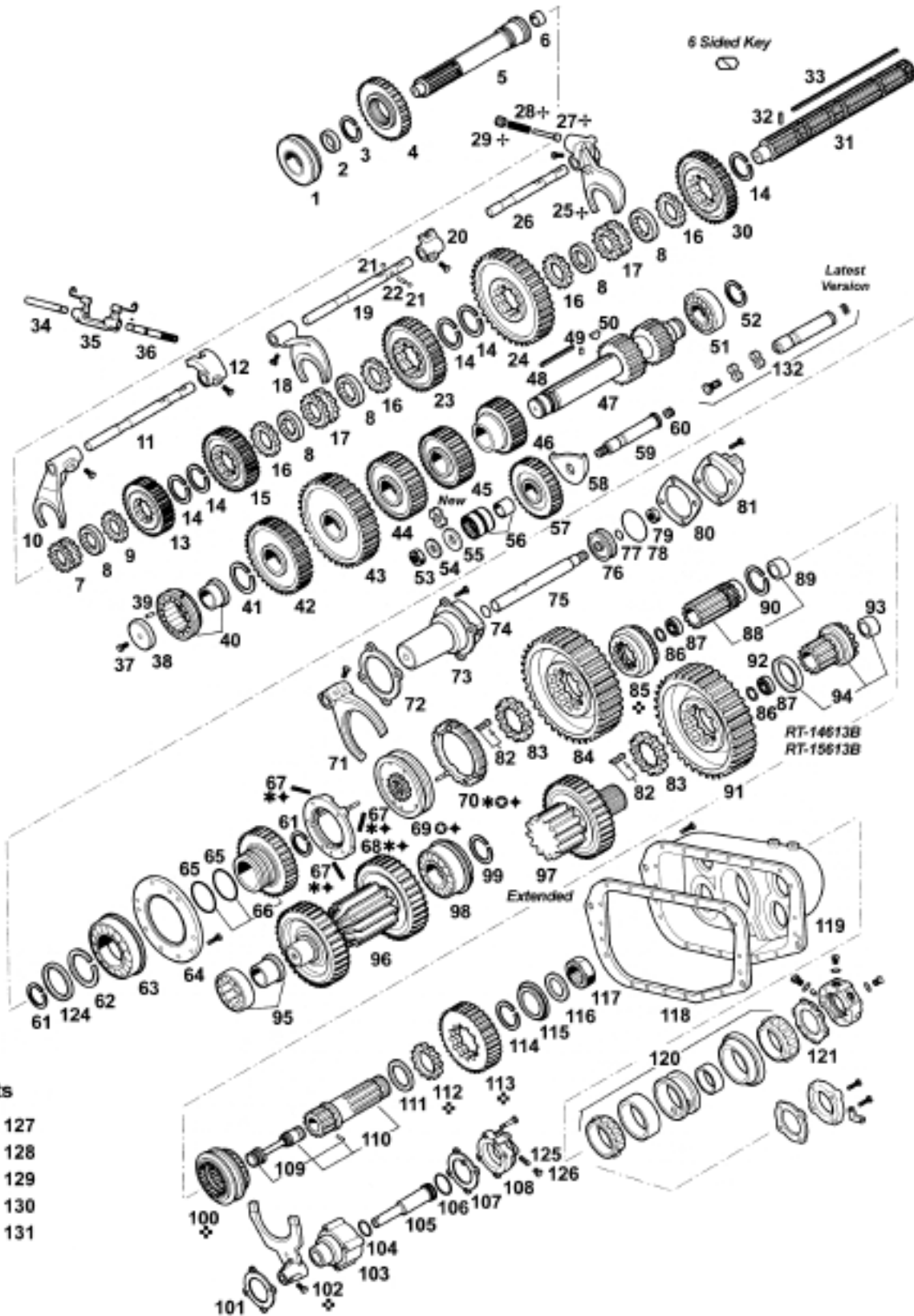

PARTS LISTED IN THIS CATALOG ARE NOT NECESSARILY MANUFACTURED BY THE ORIGINAL EQUIPMENT MANUFACTURER AND ANY REFERENCE TO THE TRADEMARKS OR PART NUMBERS OF OTHERS ARE FOR CROSS REFERENCE INFORMATIONAL PURPOSES ONLY. THE TRADEMARKS OF OTHERS REFERRED TO HEREIN ARE OWNED BY THEIR RESPECTIVE COMPANIES AND ARE NOT AFFILIATED IN ANY WAY WITH MIDWEST TRUCK & AUTO PARTS, INC.® MOTIVE GEAR® AND WORLD AMERICAN® ARE THE REGISTERED TRADEMARKS OF MIDWEST TRUCK & AUTO PARTS, INC.® USE OF THE ® IN CONNECTION WITH A MARK OF MIDWEST TRUCK & AUTO PARTS, INC.® INDICATES THAT THE MARK IS REGISTERED IN AT LEAST THE UNITED STATES. NO REPRESENTATION IS MADE WITH RESPECT TO THE SOURCE OF MANUFACTURE OF ANY PARTICULAR PART. © 2005, MIDWEST TRUCK & AUTO PARTS, INC.® ALL RIGHTS RESERVED.

# FULLER® 13 SPEED

FIG. PART#	DESCRIPTION	RT-11613	RTO-11613	RTOO-11613	RT-14613	RT-14613B	RTO-14613	RTOO-14613	RT-14813	RT-15613	RT-15613	RT-15613B	RTO-15613
1	212SLV BEARING	X	X	X	X	X	X	X	X	X	X	X	X
2	16463 SPACER	X	X	X	X	X	X	X	X	X	X	X	X
3	14750 SNAPRING	X	X	X	X	X	X	X	X	X	X	X	X
4	20458 GEAR MAIN DRIVE 48T	X	X		X	X	X		X	X			X
4	21019 GEAR MAIN DRIVE 52T			X									
4	21019 GEAR MAIN DRIVE 52T						X						
4	22961 GEAR MAIN DRIVE 52T						X						
4	F96482 GEAR MAIN DRIVE											X	X
5	<b>INPUT SHAFTS (SEE PGS. 327-328)</b>												
6	16566 BUSHING	X	X	X	X	X	X	X	X	X			X
7	16118 SLIDING CLUTCH	X	X	X	X	X	X		X	X	X	X	X
7	16118 SLIDING CLUTCH							X					
7	22026 SLIDING CLUTCH							X					
8	14711 WASHER S.6, 299-6, 350 MM (WHITE)	X	X	X	X	X	X	X	X	X	X	X	X
8	14712 WASHER S.6, 426-6 477 MM (GREEN)	X	X	X	X	X	X	X	X	X	X	X	X
8	14713 WASHER S.6, 553-6, 604 MM (ORANGE)	X	X	X	X	X	X	X	X	X	X	X	X
8	14714 WASHER S.6, 680-6, 731 MM (PURPLE)	X	X	X	X	X	X	X	X	X	X	X	X
8	14715 WASHER S.6, 807-6, 858 MM (YELLOW)	X	X	X	X	X	X	X	X	X	X	X	X
8	14716 WASHER S.6, 934-6, 985 MM (BLACK)	X	X	X	X	X	X	X	X	X	X	X	X
9	14749 SPACER	X	X	X	X	X	X		X	X	X	X	X
9	14749 SPACER							X					
9	22032 SPACER							X					
10	16136 SHIFT YOKE	X	X	X	X	X	X	X	X	X	X	X	X
11	16134 YOKE BAR	X	X	X	X	X	X	X	X	X	X	X	X
12	14659 SHIFTING BLOCK	X	X	X	X	X	X	X	X	X	X	X	X
13	20391 GEAR M/S 3RD 58T	X	X		X	X	X		X	X			X
13	21261 GEAR M/S 42T			X									
13	21261 GEAR M/S 42T							X					
13	23102 GEAR M/S 42T							X					

PARTS LISTED IN THIS CATALOG ARE NOT NECESSARILY MANUFACTURED BY THE ORIGINAL EQUIPMENT MANUFACTURER AND ANY REFERENCE TO THE TRADEMARKS OR PART NUMBERS OF OTHERS ARE FOR CROSS REFERENCE INFORMATIONAL PURPOSES ONLY. THE TRADEMARKS OF OTHERS REFERRED TO HEREIN ARE OWNED BY THEIR RESPECTIVE COMPANIES AND ARE NOT AFFILIATED IN ANY WAY WITH MIDWEST TRUCK & AUTO PARTS, INC.® MOTIVE GEAR® AND WORLD AMERICAN® ARE THE REGISTERED TRADEMARKS OF MIDWEST TRUCK & AUTO PARTS, INC.® USE OF THE ® IN CONNECTION WITH A MARK OF MIDWEST TRUCK & AUTO PARTS, INC.® INDICATES THAT THE MARK IS REGISTERED IN AT LEAST THE UNITED STATES. NO REPRESENTATION IS MADE WITH RESPECT TO THE SOURCE OF MANUFACTURE OF ANY PARTICULAR PART. © 2005, MIDWEST TRUCK & AUTO PARTS, INC.® ALL RIGHTS RESERVED.

# FULLER®

## 13 SPEED (Cont'd)

FIG. PART#	DESCRIPTION	RT-11613	RTO-11613	RTOO-11613	RT-14613	RT-14613B	RTO-14613	RTOO-14613	RT-14813	RT-15613	RT-15613	RT-15613B	RTO-15613
13 F96480	GEAR M/S										X	X	
14 14750	SNAP RING	X	X	X	X	X	X	X	X	X	X	X	X
15 20390	GEAR M/S 2ND 56T	X	X			X	X	X		X	X		X
15 19622	GEAR M/S 2ND SPD 50T			X				X					
15 F96478	GEAR M/S									X	X		
16 14749	SPACER	X	X	X	X	X	X	X	X	X	X	X	X
17 16118	SLIDING CLUTCH	X	X	X	X	X	X	X	X	X	X	X	X
18 16135	SHIFT YOKE 2ND	X	X	X	X	X	X	X	X	X	X	X	X
19 16133	YOKE BAR	X	X	X	X	X	X	X	X	X	X	X	X
20 14658	SHIFTING BLOCK	X	X	X	X	X	X	X	X	X	X	X	X
21 X-14-1200	BALL	X	X	X	X	X	X	X	X	X	X	X	X
22 1634	PIN	X	X	X	X	X	X	X	X	X	X	X	X
23 20389	GEAR M/S 1ST 60T	X	X		X	X	X		X	X			X
23 21024	GEAR M/S 1ST SPD 60T			X				X					
23 F96476	GEAR M/S											X	X
24 16754	GEAR M/S LOW 44T	X	X	X	X	X	X	X	X	X			X
24 F96309	GEAR M/S									X	X		
25 16131	REVERSE YOKE	X	X	X	X	X	X	X	X	X	X	X	X
26 16132	YOKE BAR	X	X	X	X	X	X	X	X	X	X	X	X
27 10019	PIN	X	X	X	X	X	X	X	X	X	X	X	X
28 6392	SPRING	X	X	X	X	X	X	X	X	X	X	X	X
29 8968	PLUG	X	X	X	X	X	X	X	X	X	X	X	X
30 16756	REVERSE GEAR M/S 46T	X	X	X	X	X	X	X	X				X
30 F96310	REVERSE GEAR									X	X		
31 S-1341	MAIN SHAFT ASSY 17T	X	X	X	X	X	X	X	X	X	X	X	X
32 62504	PIN 3X16	X	X	X	X	X	X	X	X	X	X	X	X
33 17109	KEY	X	X	X	X	X	X	X	X	X	X	X	X
34 14494	PEDAL SHAFT	X	X	X	X	X	X	X	X				
35 12817	YOKE-CLUTCH RELEASE	X	X	X	X	X	X	X	X				
36 1984	PEDAL SHAFT	X	X	X	X	X	X	X	X				
36 1983	PEDAL SHAFT	X	X	X	X	X	X	X	X				
37 X-7-1005	BOLT 5/8"	X	X	X	X	X	X	X	X	X	X	X	X
38 19668	LOCKING DISK	X											
38 19548	LOCKING DISK		X	X	X	X	X	X	X	X	X	X	X

PARTS LISTED IN THIS CATALOG ARE NOT NECESSARILY MANUFACTURED BY THE ORIGINAL EQUIPMENT MANUFACTURER AND ANY REFERENCE TO THE TRADEMARKS OR PART NUMBERS OF OTHERS ARE FOR CROSS REFERENCE INFORMATIONAL PURPOSES ONLY. THE TRADEMARKS OF OTHERS REFERRED TO HEREIN ARE OWNED BY THEIR RESPECTIVE COMPANIES AND ARE NOT AFFILIATED IN ANY WAY WITH MIDWEST TRUCK & AUTO PARTS, INC.® MOTIVE GEAR® AND WORLD AMERICAN® ARE THE REGISTERED TRADEMARKS OF MIDWEST TRUCK & AUTO PARTS, INC.® USE OF THE ® IN CONNECTION WITH A MARK OF MIDWEST TRUCK & AUTO PARTS, INC.® INDICATES THAT THE MARK IS REGISTERED IN AT LEAST THE UNITED STATES. NO REPRESENTATION IS MADE WITH RESPECT TO THE SOURCE OF MANUFACTURE OF ANY PARTICULAR PART. © 2005, MIDWEST TRUCK & AUTO PARTS, INC.® ALL RIGHTS RESERVED.

# FULLER®

## 13 SPEED (Cont'd)

FIG. PART#	DESCRIPTION	<i>RT-11613</i>	<i>RTO-11613</i>	<i>RTOO-11613</i>	<i>RT-14613</i>	<i>RT-14613B</i>	<i>RTO-14613</i>	<i>RTOO-14613</i>	<i>RT-14813</i>	<i>RT-15613</i>	<i>RT-15613</i>	<i>RT-15613B</i>	<i>RTO-15613</i>
39 62511	PIN	X	X	X	X	X	X	X	X	X	X	X	X
40 1309L	BEARING	X											
40 MS1309GEXR	BEARING		X	X	X	X	X	X	X	X	X	X	X
41 19198	SNAP RING	X	X	X	X	X	X	X	X	X	X	X	X
42 20459	GEAR C/S 69T	X	X		X	X	X		X	X			X
42 21018	GEAR C/S 66T			X				X					
42 F96483	GEAR C/S										X	X	
43 15953	GEAR C/S PTO 47T LH PTO - (LEFT)	X	X	X	X	X	X	X	X	X	X	X	X
43 20840	GEAR C/S PTO 45T RH PTO - (RIGHT)	X	X	X	X	X	X	X	X	X	X	X	X
44 21020	GEAR C/S 62T	X	X		X	X	X		X	X			X
44 21262	GEAR C/S 73T			X				X					
44 F96481	GEAR C/S										X	X	
45 20482	GEAR C/S 2ND 44T	X	X		X	X	X		X	X			X
45 21264	GEAR C/S 46T			X				X					
45 F96479	GEAR C/S										X	X	
46 20471	GEAR C/S 1ST 35T	X	X		X	X	X		X	X			X
46 21025	GEAR C/S 1ST 39T			X				X					
46 F96477	GEAR C/S										X	X	
47 19549	COUNTERSHAFT 17T	X	X	X	X	X	X	X	X	X			X
47 K-2953	COUNTERSHAFT KIT W/KEYS	X	X	X	X	X	X	X	X	X			X
47 F96315	COUNTERSHAFT										X	X	
48 19673	KEY	X	X	X	X	X	X	X	X	X	X	X	X
49 62511	PIN	X	X	X	X	X	X	X	X	X	X	X	X
50 X-6-E	KEY	X	X	X	X	X	X	X	X	X	X	X	X
51 MU1308TV	BEARING	X	X	X	X	X	X	X	X	X	X	X	X
52 14317	SNAP RING	X	X	X	X	X	X	X	X	X	X	X	X
53 X-1-1008	NUT	X	X	X	X	X	X	X	X	X	X	X	X
54 14283	WASHER	X	X	X	X	X	X	X	X	X	X	X	X
55 14282	WASHER (OLD)	X	X	X	X	X	X	X	X	X	X	X	X
55 4302982	WASHER - (NEW)	X	X	X	X	X	X	X	X	X	X	X	X
56 FWA1830	BEARING	X	X	X	X	X	X	X	X	X	X	X	X

PARTS LISTED IN THIS CATALOG ARE NOT NECESSARILY MANUFACTURED BY THE ORIGINAL EQUIPMENT MANUFACTURER AND ANY REFERENCE TO THE TRADEMARKS OR PART NUMBERS OF OTHERS ARE FOR CROSS REFERENCE INFORMATIONAL PURPOSES ONLY. THE TRADEMARKS OF OTHERS REFERRED TO HEREIN ARE OWNED BY THEIR RESPECTIVE COMPANIES AND ARE NOT AFFILIATED IN ANY WAY WITH MIDWEST TRUCK & AUTO PARTS, INC.® MOTIVE GEAR® AND WORLD AMERICAN® ARE THE REGISTERED TRADEMARKS OF MIDWEST TRUCK & AUTO PARTS, INC.® USE OF THE ® IN CONNECTION WITH A MARK OF MIDWEST TRUCK & AUTO PARTS, INC.® INDICATES THAT THE MARK IS REGISTERED IN AT LEAST THE UNITED STATES. NO REPRESENTATION IS MADE WITH RESPECT TO THE SOURCE OF MANUFACTURE OF ANY PARTICULAR PART. © 2005, MIDWEST TRUCK & AUTO PARTS, INC.® ALL RIGHTS RESERVED.

# FULLER®

## 13 SPEED (Cont'd)

FIG. PART#	DESCRIPTION	RT-11613	RTO-11613	RTOO-11613	RT-14613	RT-14613B	RTO-14613	RTOO-14613	RT-14813	RT-15613	RTO-15613	RT-15613B	RTO-15613
57 16757	REVERSE GEAR 27T	X	X	X	X	X	X	X	X	X	X		X
57 F96316	REVERSE GEAR										X	X	
58 16403	WASHER	X	X	X	X	X	X	X	X	X	X	X	X
59 16405	REVERSE GEAR PIN	X	X	X	X	X	X	X	X	X	X	X	X
60 5202	PLUG	X	X	X	X	X	X	X	X	X	X	X	X
61 16763	SNAP RING	X	X	X	X	X	X	X	X	X	X	X	X
62 16628	SNAP RING	X	X	X	X	X	X	X	X	X	X	X	X
63 118L	BEARING	X	X	X	X	X	X	X	X	X	X	X	X
64 16138	RETAINER RING	X	X	X	X	X	X	X	X	X	X	X	X
65 17453	RETAINER RING	X	X	X	X	X	X	X	X	X	X	X	X
66 K-1788	AUX. DRIVE GEAR KIT 40T	X	X		X		X			X			X
66 K-1789	AUX. DRIVE GEAR KIT 44T			X				X					
66 21234	GEAR AUX. DRIVE 40T					X							
66 T20303	AUX. DRIVE GEAR KIT 40T					X							
66 K-2316	AUX. DRIVE GEAR KIT 40T								X				
66 F96474	AUX. DRIVE GEAR KIT									X	X		
67 14897	SPRING	X	X	X	X	X	X	X	X	X	X	X	X
68 A-4938	SYNCHRONIZER RING	X	X	X	X	X	X	X	X	X	X	X	X
69 16759	SLIDING CLUTCH - (OLD)	X	X	X	X	X	X	X	X	X	X	X	X
69 20323	SLIDING CLUTCH - (NEW)	X	X	X	X	X	X	X	X	X	X	X	X
70 A-4416	SYNCHRONIZER RING - (OLD)	X	X	X	X	X	X	X	X	X	X	X	X
70 A-4937	SYNCHRONIZER RING - (NEW)	X	X	X	X	X	X	X	X	X	X	X	X
71 16775	SHIFT YOKE	X	X	X	X	X	X	X	X	X	X	X	X
71 22823	SHIFT YOKE (LATEST)	X	X	X	X	X	X	X	X	X	X	X	X
72 14347	GASKET	X	X	X	X	X	X	X	X	X	X	X	X
73 16777	AUXILIARY CYLINDER	X	X	X	X	X	X	X	X	X	X	X	X
74 14765	O-RING	X	X	X	X	X	X	X	X	X	X	X	X
75 16776	YOKE BAR	X	X	X	X	X	X	X	X	X	X	X	X
76 14341	PISTON	X	X	X	X	X	X	X	X	X	X	X	X
77 14345	O-RING	X	X	X	X	X	X	X	X	X	X	X	X

PARTS LISTED IN THIS CATALOG ARE NOT NECESSARILY MANUFACTURED BY THE ORIGINAL EQUIPMENT MANUFACTURER AND ANY REFERENCE TO THE TRADEMARKS OR PART NUMBERS OF OTHERS ARE FOR CROSS REFERENCE INFORMATIONAL PURPOSES ONLY. THE TRADEMARKS OF OTHERS REFERRED TO HEREIN ARE OWNED BY THEIR RESPECTIVE COMPANIES AND ARE NOT AFFILIATED IN ANY WAY WITH MIDWEST TRUCK & AUTO PARTS, INC.® MOTIVE GEAR® AND WORLD AMERICAN® ARE THE REGISTERED TRADEMARKS OF MIDWEST TRUCK & AUTO PARTS, INC.® USE OF THE ® IN CONNECTION WITH A MARK OF MIDWEST TRUCK & AUTO PARTS, INC.® INDICATES THAT THE MARK IS REGISTERED IN AT LEAST THE UNITED STATES. NO REPRESENTATION IS MADE WITH RESPECT TO THE SOURCE OF MANUFACTURE OF ANY PARTICULAR PART. © 2005, MIDWEST TRUCK & AUTO PARTS, INC.® ALL RIGHTS RESERVED.

# FULLER®

## 13 SPEED (Cont'd)

FIG. PART#	DESCRIPTION	<i>RT-11613</i>	<i>RTO-11613</i>	<i>RTOO-11613</i>	<i>RT-14613</i>	<i>RT-14613B</i>	<i>RTO-14613</i>	<i>RTOO-14613</i>	<i>RT-14813</i>	<i>RT-15613</i>	<i>RT-15613</i>	<i>RT-15613B</i>	<i>RTO-15613</i>
78 14344	O-RING	X	X	X	X	X	X	X	X	X	X	X	X
79 X-1-1010	NUT	X	X	X	X	X	X	X	X	X	X	X	X
80 14349	GASKET	X	X	X	X	X	X	X	X	X	X	X	X
81 19690	CYLINDER COVER	X	X	X	X	X	X	X	X	X	X	X	X
82 A-3697	KEY & PIN ASSY	X	X	X	X	X	X	X	X	X	X	X	X
83 15932	WASHER S.5, 13-5, 18 MM (BLACK)	X	X	X	X	X	X	X	X	X	X	X	X
83 17257	WASHER S.5, 23-5, 28 MM (PURPLE)	X	X	X	X	X	X	X	X	X	X	X	X
83 17258	WASHER S.5, 33-5, 38 MM (YELLOW)	X	X	X	X	X	X	X	X	X	X	X	X
84 19221	GEAR M/S 56T	X	X										
84 19257	GEAR M/S 48T			X									
84 20388	GEAR M/S 56T				X		X		X	X			X
84 19214	GEAR M/S 48T							X					
85 19131	COUPLER M/S	X	X	X	X		X	X	X	X	X		X
86 14291	SNAP RING	X	X	X	X		X	X	X	X	X		X
87 204	BEARING	X	X	X	X		X	X	X	X	X		X
88 K-1546	MAIN SHAFT KIT	X	X	X	X		X	X	X	X	X		X
89 16516	BUSHING	X	X	X	X		X	X	X	X	X		X
90 18135	SNAP RING	X	X	X	X		X	X	X	X	X		X
91 F96414	GEAR M/S 56T					X							
91 F96472	GEAR M/S										X	X	
92 F96528	RING					X						X	
93 F96526	BUSHING					X						X	
94 T20213	MAIN SHAFT KIT					X						X	
95 MR1307EL	BEARING D.80X35X21	X	X	X	X	X	X	X	X	X	X	X	X
96 A-4956	AUX. COUNTERSHAFT ASSY	X			X					X			
96 A-4957	AUX. COUNTERSHAFT ASSY		X			X							X
96 A-4726	AUX. COUNTERSHAFT ASSY			X				X					
96 A-5466	AUX. COUNTERSHAFT ASSY								X				

PARTS LISTED IN THIS CATALOG ARE NOT NECESSARILY MANUFACTURED BY THE ORIGINAL EQUIPMENT MANUFACTURER AND ANY REFERENCE TO THE TRADEMARKS OR PART NUMBERS OF OTHERS ARE FOR CROSS REFERENCE INFORMATIONAL PURPOSES ONLY. THE TRADEMARKS OF OTHERS REFERRED TO HEREIN ARE OWNED BY THEIR RESPECTIVE COMPANIES AND ARE NOT AFFILIATED IN ANY WAY WITH MIDWEST TRUCK & AUTO PARTS, INC.® MOTIVE GEAR® AND WORLD AMERICAN® ARE THE REGISTERED TRADEMARKS OF MIDWEST TRUCK & AUTO PARTS, INC.® USE OF THE ® IN CONNECTION WITH A MARK OF MIDWEST TRUCK & AUTO PARTS, INC.® INDICATES THAT THE MARK IS REGISTERED IN AT LEAST THE UNITED STATES. NO REPRESENTATION IS MADE WITH RESPECT TO THE SOURCE OF MANUFACTURE OF ANY PARTICULAR PART. © 2005, MIDWEST TRUCK & AUTO PARTS, INC.® ALL RIGHTS RESERVED.

# FULLER®

## 13 SPEED (Cont'd)

FIG. PART#	DESCRIPTION	RT-11613	RTO-11613	RTOO-11613	RT-14613	RT-14613B	RTO-14613	RTOO-14613	RT-14813	RT-15613	RT-15613	RT-15613B	RTO-15613
97 A-5105	AUX. COUNTERSHAFT ASSY	X			X								
97 A-5106	AUX. COUNTERSHAFT ASSY		X				X						
97 A-5107	AUX. COUNTERSHAFT ASSY			X				X					
97 U14622	AUX. COUNTERSHAFT ASSY					X							
97 U-15043	AUX. COUNTERSHAFT ASSY									X		X	
98 1310L	BEARING	X	X	X	X	X	X	X	X	X	X	X	X
99 16723	SNAP RING	X	X	X	X	X	X	X	X	X	X	X	X
100 19132	SLIDING CLUTCH	X	X	X	X	X	X	X	X	X	X	X	X
101 14632	GASKET	X	X	X	X	X	X	X	X	X	X	X	X
102 19128	SHIFT YOKE	X	X	X	X	X	X	X	X	X	X	X	X
103 17070	AUXILIARY CYLINDER	X	X	X	X	X	X	X	X	X	X	X	X
103 21210	AUXILIARY CYLINDER	X	X	X	X	X	X	X	X	X	X	X	X
104 14644	O-RING	X	X	X	X	X	X	X	X	X	X	X	X
104 21208	O-RING	X	X	X	X	X	X	X	X	X	X	X	X
105 16961	YOKE BAR	X	X	X	X	X	X	X	X	X	X	X	X
105 21211	YOKE BAR	X	X	X	X	X	X	X	X	X	X	X	X
106 14621	O-RING	X	X	X	X	X	X	X	X	X	X	X	X
106 21209	O-RING	X	X	X	X	X	X	X	X	X	X	X	X
107 17073	GASKET	X	X	X	X	X	X	X	X	X	X	X	X
108 4300927	CYLINDER COVER	X	X	X	X	X	X	X	X	X	X	X	X
109 K-1644	REPL. QUILL KIT	X	X	X	X	X	X	X	X	X	X	X	X
110 A-4738	OUTPUT SHAFT 18T - 10 SPL.	X	X	X									
110 A-4414	OUTPUT SHAFT 18T - 10 SPL.				X		X	X	X				
110 T20201	OUTPUT SHAFT ASSY 18/54T - 54 SPL.					X				X		X	
110 A-4975	OUTPUT SHAFT 18T - 10 SPL.								X				X
111 14332	WASHER	X	X	X									

PARTS LISTED IN THIS CATALOG ARE NOT NECESSARILY MANUFACTURED BY THE ORIGINAL EQUIPMENT MANUFACTURER AND ANY REFERENCE TO THE TRADEMARKS OR PART NUMBERS OF OTHERS ARE FOR CROSS REFERENCE INFORMATIONAL PURPOSES ONLY. THE TRADEMARKS OF OTHERS REFERRED TO HEREIN ARE OWNED BY THEIR RESPECTIVE COMPANIES AND ARE NOT AFFILIATED IN ANY WAY WITH MIDWEST TRUCK & AUTO PARTS, INC.® MOTIVE GEAR® AND WORLD AMERICAN® ARE THE REGISTERED TRADEMARKS OF MIDWEST TRUCK & AUTO PARTS, INC.® USE OF THE ® IN CONNECTION WITH A MARK OF MIDWEST TRUCK & AUTO PARTS, INC.® INDICATES THAT THE MARK IS REGISTERED IN AT LEAST THE UNITED STATES. NO REPRESENTATION IS MADE WITH RESPECT TO THE SOURCE OF MANUFACTURE OF ANY PARTICULAR PART. © 2005, MIDWEST TRUCK & AUTO PARTS, INC.® ALL RIGHTS RESERVED.

# FULLER®

## 13 SPEED (Cont'd)

FIG. PART#	DESCRIPTION	<i>RT-11613</i>	<i>RTO-11613</i>	<i>RTOO-11613</i>	<i>RT-14613</i>	<i>RT-14613B</i>	<i>RTO-14613</i>	<i>RTOO-14613</i>	<i>RT-14813</i>	<i>RT-15613</i>	<i>RT-15613</i>	<i>RT-15613B</i>	<i>RTO-15613</i>
111 18019	WASHER				X	X	X	X	X	X	X	X	X
112 18250	SPACER	X	X	X									
112 18251	SPACER				X	X	X	X	X	X	X	X	X
113 20918	GEAR 52T	X			X	X			X	X			
113 20917	GEAR 40T		X	X			X	X					X
113 F96470	GEAR										X	X	
114 14327	SNAP RING	X	X	X	X	X	X	X	X	X	X	X	X
115 16310	WASHER S.7, 93 MM	X	X	X									
115 16315	WASHER				X	X	X	X	X	X	X	X	X
116 16337	WASHER S.4, 76 MM				X	X	X	X	X	X	X	X	X
117 22254	NUT	X	X	X	X	X	X	X	X	X	X	X	X
118 14335	GASKET	X	X	X	X	X	X	X	X	X	X	X	X
119 18700	REAR HOUSING	X	X	X									
119 18786	REAR HOUSING				X	X	X	X	X	X	X	X	X
120 A3071	BEARING	X	X	X									
120 A2892	BEARING				X	X	X	X	X	X	X	X	X
121 15532	GASKET	X	X	X	X	X	X	X	X	X	X	X	X
124 21320	SNAP RING RETAINER	X	X	X	X	X	X	X	X	X			X
125 19974	INSERT VALVE	X	X	X	X	X	X	X	X	X	X	X	X
126 15719	PLUG	X	X	X	X	X	X	X	X	X	X	X	X
127 K-1945	SYNCHRONIZER KIT- (OLD)	X	X	X	X	X	X	X	X	X	X	X	X
127 K-1946	SYNCHRONIZER KIT-(NEW)	X	X	X	X	X	X	X	X	X	X	X	X
128 T20099	SYNCHRO CLUTCH ASSY (NEW)	X	X	X	X	X	X	X	X	X	X	X	X
129 K-1947	SYNCHRO KIT W/SLIDING CLUTCH (OLD)	X	X	X	X	X	X	X	X	X	X	X	X
129 K-1948	SYNCHRO KIT W/SLIDING CLUTCH (NEW)	X	X	X	X	X	X	X	X	X	X	X	X
130 S-1219	YOKE ASSY	X	X	X	X	X	X	X	X	X	X	X	X
131 K-1959	GEAR KIT - SPLITTER	X											
131 K-1960	GEAR KIT - SPLITTER		X	X									
131 K-1961	GEAR KIT - SPLITTER				X				X	X			
131 K-1962	GEAR KIT - SPLITTER					X	X						X
132 K-3209	IDLER SHAFT REPL. KIT	X	X	X	X	X	X	X	X	X	X	X	X

PARTS LISTED IN THIS CATALOG ARE NOT NECESSARILY MANUFACTURED BY THE ORIGINAL EQUIPMENT MANUFACTURER AND ANY REFERENCE TO THE TRADEMARKS OR PART NUMBERS OF OTHERS ARE FOR CROSS REFERENCE INFORMATIONAL PURPOSES ONLY. THE TRADEMARKS OF OTHERS REFERRED TO HEREIN ARE OWNED BY THEIR RESPECTIVE COMPANIES AND ARE NOT AFFILIATED IN ANY WAY WITH MIDWEST TRUCK & AUTO PARTS, INC.® MOTIVE GEAR® AND WORLD AMERICAN® ARE THE REGISTERED TRADEMARKS OF MIDWEST TRUCK & AUTO PARTS, INC.® USE OF THE ® IN CONNECTION WITH A MARK OF MIDWEST TRUCK & AUTO PARTS, INC.® INDICATES THAT THE MARK IS REGISTERED IN AT LEAST THE UNITED STATES. NO REPRESENTATION IS MADE WITH RESPECT TO THE SOURCE OF MANUFACTURE OF ANY PARTICULAR PART. © 2005, MIDWEST TRUCK & AUTO PARTS, INC.® ALL RIGHTS RESERVED.

# FULLER® 13 SPEED MODEL RTLO "B" 14613

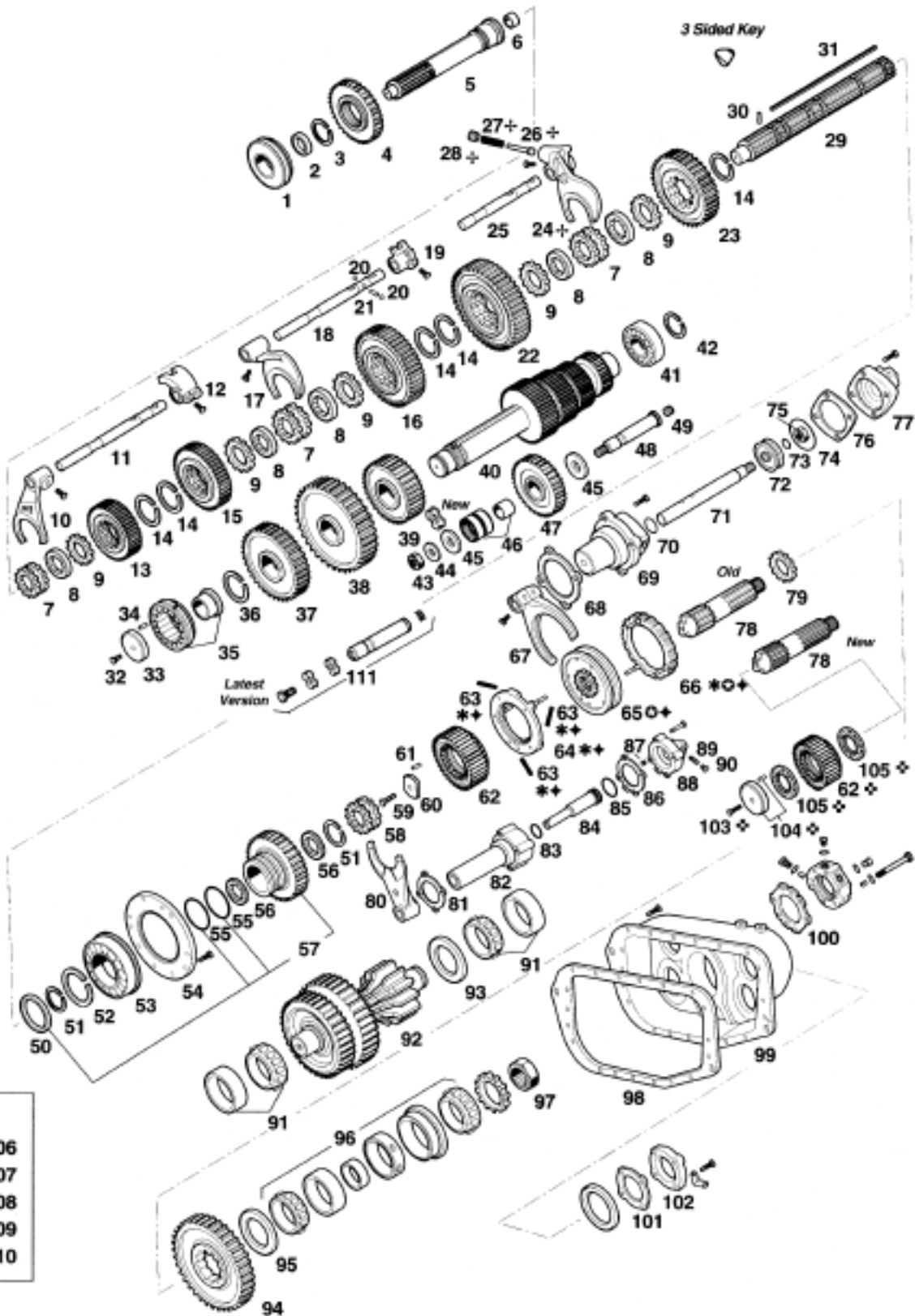

PARTS LISTED IN THIS CATALOG ARE NOT NECESSARILY MANUFACTURED BY THE ORIGINAL EQUIPMENT MANUFACTURER AND ANY REFERENCE TO THE TRADEMARKS OR PART NUMBERS OF OTHERS ARE FOR CROSS REFERENCE INFORMATIONAL PURPOSES ONLY. THE TRADEMARKS OF OTHERS REFERRED TO HEREIN ARE OWNED BY THEIR RESPECTIVE COMPANIES AND ARE NOT AFFILIATED IN ANY WAY WITH MIDWEST TRUCK & AUTO PARTS, INC.® MOTIVE GEAR® AND WORLD AMERICAN® ARE THE REGISTERED TRADEMARKS OF MIDWEST TRUCK & AUTO PARTS, INC.® USE OF THE ® IN CONNECTION WITH A MARK OF MIDWEST TRUCK & AUTO PARTS, INC.® INDICATES THAT THE MARK IS REGISTERED IN AT LEAST THE UNITED STATES. NO REPRESENTATION IS MADE WITH RESPECT TO THE SOURCE OF MANUFACTURE OF ANY PARTICULAR PART. © 2005, MIDWEST TRUCK & AUTO PARTS, INC.® ALL RIGHTS RESERVED.

# FULLER® 13 SPEED

FIG.	PART#	DESCRIPTION	RTLO" B" 14613
1	212SLV	BEARING	×
2	16463	SPACER	×
3	14750	SNAP RING	×
4	20458	GEAR MAIN DRIVE 48T	×
5	<b>INPUT SHAFTS (SEE PGS. 327-328)</b>		
6	16566	BUSHING	×
7	16118	SLIDING CLUTCH	×
8	4300830	WASHER (BLUE)	×
8	4300382	WASHER (WHITE)	×
8	4300383	WASHER (GREEN)	×
8	4300384	WASHER (ORANGE)	×
8	4300385	WASHER (PURPLE)	×
8	4300386	WASHER (YELLOW)	×
8	4300387	WASHER (BLACK)	×
9	14749	SPACER	×
10	16136	SHIFT YOKE	×
11	16134	YOKE BAR	×
12	14659	SHIFTING BLOCK	×
13	21587	GEAR M/S 58T	×
14	14750	SNAP RING	×
15	21589	GEAR M/S 24T	×
16	21591	GEAR M/S 60T	×
17	16135	SHIFT YOKE 2ND	×

FIG.	PART#	DESCRIPTION	RTLO" B" 14613
18	16133	YOKE BAR	×
19	14658	SHIFTING BLOCK	×
20	X-14-1200	BALL	×
21	1634	PIN	×
22	4300654	GEAR M/S 46T	×
23	16756	REVERSE GEAR M/S 46T	×
24	16131	REVERSE YOKE	×
25	16132	YOKE BAR	×
26	10019	PIN	×
27	6392	SPRING	×
28	8968	PLUG	×
29	S-1561	MAIN SHAFT ASSY 17T	×
30	62504	PIN 3X16	×
31	4300890	KEY	×
32	X-7-1005	BOLT 5/8"	×
33	19548	LOCKING DISK	×
34	62511	PIN	×
35	MS1309GEXR	BEARING	×
36	19198	SNAP RING	×
37	21586	GEAR C/S 69T	×
38	21588	GEAR C/S 60T	×
39	15953	GEAR C/S PTO 47T - LH PTO - LEFT	×

PARTS LISTED IN THIS CATALOG ARE NOT NECESSARILY MANUFACTURED BY THE ORIGINAL EQUIPMENT MANUFACTURER AND ANY REFERENCE TO THE TRADEMARKS OR PART NUMBERS OF OTHERS ARE FOR CROSS REFERENCE INFORMATIONAL PURPOSES ONLY. THE TRADEMARKS OF OTHERS REFERRED TO HEREIN ARE OWNED BY THEIR RESPECTIVE COMPANIES AND ARE NOT AFFILIATED IN ANY WAY WITH MIDWEST TRUCK & AUTO PARTS, INC.® MOTIVE GEAR® AND WORLD AMERICAN® ARE THE REGISTERED TRADEMARKS OF MIDWEST TRUCK & AUTO PARTS, INC.® USE OF THE ® IN CONNECTION WITH A MARK OF MIDWEST TRUCK & AUTO PARTS, INC.® INDICATES THAT THE MARK IS REGISTERED IN AT LEAST THE UNITED STATES. NO REPRESENTATION IS MADE WITH RESPECT TO THE SOURCE OF MANUFACTURE OF ANY PARTICULAR PART. © 2005, MIDWEST TRUCK & AUTO PARTS, INC.® ALL RIGHTS RESERVED.

# FULLER®

## 13 SPEED (Cont'd)

FIG.	PART#	DESCRIPTION	RTLO™B™ 14613
39	20840	GEAR C/S PTO 45T - RH PTO - (RIGHT)	×
40	A-6689	COUNTERSHAFT ASSY	×
41	MU1308TV	BEARING	×
42	14317	SNAP RING	×
43	X-1-1008	NUT	×
44	14283	WASHER	×
45	14282	WASHER (OLD)	×
45	4302982	WASHER (NEW)	×
46	FWA1830	BEARING	×
47	16757	REVERSE GEAR 27T	×
48	16405	REVERSE GEAR PIN	×
49	5202	PLUG	×
50	21320	SNAP RING RETAINER	×
51	16763	SNAP RING	×
52	16628	SNAP RING	×
53	118L	BEARING	×
54	16138	RETAINER RING	×
55	17453	RETAINER RING	×
56	21599	WASHER	×
57	K-3189	AUX. GEAR KIT	×
58	21930	SLIDING CLUTCH 29T	×
59	X-7-1005	BOLT	×

FIG.	PART#	DESCRIPTION	RTLO™B™ 14613
60	21606	RETAINER	×
61	62511	PIN	×
62	21931	GEAR M/S 38T	×
63	14897	SPRING	×
64	A-4938	SYNCHRONIZER RING	×
65	20323	SLIDING CLUTCH	×
66	A-4937	SYNCHRONIZER RING	×
67	16775	SHIFT YOKE	×
67	22823	SHIFT YOKE (LATEST)	×
68	14347	GASKET	×
69	16778	CYLINDER	×
70	14765	O-RING	×
71	4300183	YOKE BAR	×
72	14341	PISTON	×
73	14345	O-RING	×
74	14344	O-RING	×
75	X-1-1010	NUT	×
76	14349	GASKET	×
77	19690	CYLINDER COVER	×
78	21604	MAIN SHAFT - (OLD)	×
78	4302059	OUTPUT SHAFT - (NEW)	×
79	19203	SPACER	×
80	21607	SHIFT YOKE	×

PARTS LISTED IN THIS CATALOG ARE NOT NECESSARILY MANUFACTURED BY THE ORIGINAL EQUIPMENT MANUFACTURER AND ANY REFERENCE TO THE TRADEMARKS OR PART NUMBERS OF OTHERS ARE FOR CROSS REFERENCE INFORMATIONAL PURPOSES ONLY. THE TRADEMARKS OF OTHERS REFERRED TO HEREIN ARE OWNED BY THEIR RESPECTIVE COMPANIES AND ARE NOT AFFILIATED IN ANY WAY WITH MIDWEST TRUCK & AUTO PARTS, INC.® MOTIVE GEAR® AND WORLD AMERICAN® ARE THE REGISTERED TRADEMARKS OF MIDWEST TRUCK & AUTO PARTS, INC.® USE OF THE ® IN CONNECTION WITH A MARK OF MIDWEST TRUCK & AUTO PARTS, INC.® INDICATES THAT THE MARK IS REGISTERED IN AT LEAST THE UNITED STATES. NO REPRESENTATION IS MADE WITH RESPECT TO THE SOURCE OF MANUFACTURE OF ANY PARTICULAR PART. © 2005, MIDWEST TRUCK & AUTO PARTS, INC.® ALL RIGHTS RESERVED.

# FULLER®

## 13 SPEED (Cont'd)

FIG.	PART#	DESCRIPTION	RTLO" B" 14613
81	14632	GASKET	×
82	21609	CYLINDER	×
83	21208	O-RING	×
84	4300182	YOKE BAR	×
85	21209	O-RING	×
86	17073	GASKET	×
87	X-12-101	PLUG	×
88	21760	CYLINDER COVER	×
89	19974	INSERT VALVE	×
90	4301233	REDUCER BUSHING	×
91	ST4276	BEARING	×
92	A-5747	AUX. COUNTERSHAFT ASSY	×
93	4300184	WASHER	×
94	21918	GEAR M/S 50T	×
95	16772	WASHER	×
96	A2892	BEARING	×
97	22254	NUT	×
98	14335	GASKET	×
99	4300863	REAR COVER	×
100	15532	GASKET	×
101	4300186	GASKET	×
102	4300185	REAR COVER	×

FIG.	PART#	DESCRIPTION	RTLO" B" 14613
103	X-7-1005	BOLT	×
104	A-6340	LOCKING DISK	×
105	4302058	BEARING	×
106	K-2616	MAINSHAFT REPL. KIT	×
107	K-1946	SYNCHRONIZER KIT	×
108	T20099	SYNCHRO CLUTCH ASSY	×
109	K-1947	SYNCHRO KIT W/SLIDING CLUTCH (OLD)	×
109	K-1948	SYNCHRO KIT W/SLIDING CLUTCH (NEW)	×
110	S-1219	YOKE ASSY	×
111	K-3209	IDLER SHAFT REPL. KIT	×
<p><b>CALL YOUR SALES REP FOR BEARING &amp; SEAL KITS</b></p>			

PARTS LISTED IN THIS CATALOG ARE NOT NECESSARILY MANUFACTURED BY THE ORIGINAL EQUIPMENT MANUFACTURER AND ANY REFERENCE TO THE TRADEMARKS OR PART NUMBERS OF OTHERS ARE FOR CROSS REFERENCE INFORMATIONAL PURPOSES ONLY. THE TRADEMARKS OF OTHERS REFERRED TO HEREIN ARE OWNED BY THEIR RESPECTIVE COMPANIES AND ARE NOT AFFILIATED IN ANY WAY WITH MIDWEST TRUCK & AUTO PARTS, INC.® MOTIVE GEAR® AND WORLD AMERICAN® ARE THE REGISTERED TRADEMARKS OF MIDWEST TRUCK & AUTO PARTS, INC.® USE OF THE ® IN CONNECTION WITH A MARK OF MIDWEST TRUCK & AUTO PARTS, INC.® INDICATES THAT THE MARK IS REGISTERED IN AT LEAST THE UNITED STATES. NO REPRESENTATION IS MADE WITH RESPECT TO THE SOURCE OF MANUFACTURE OF ANY PARTICULAR PART. © 2005, MIDWEST TRUCK & AUTO PARTS, INC.® ALL RIGHTS RESERVED.