

EATON®

MODELS: RS461, RS521, RS581

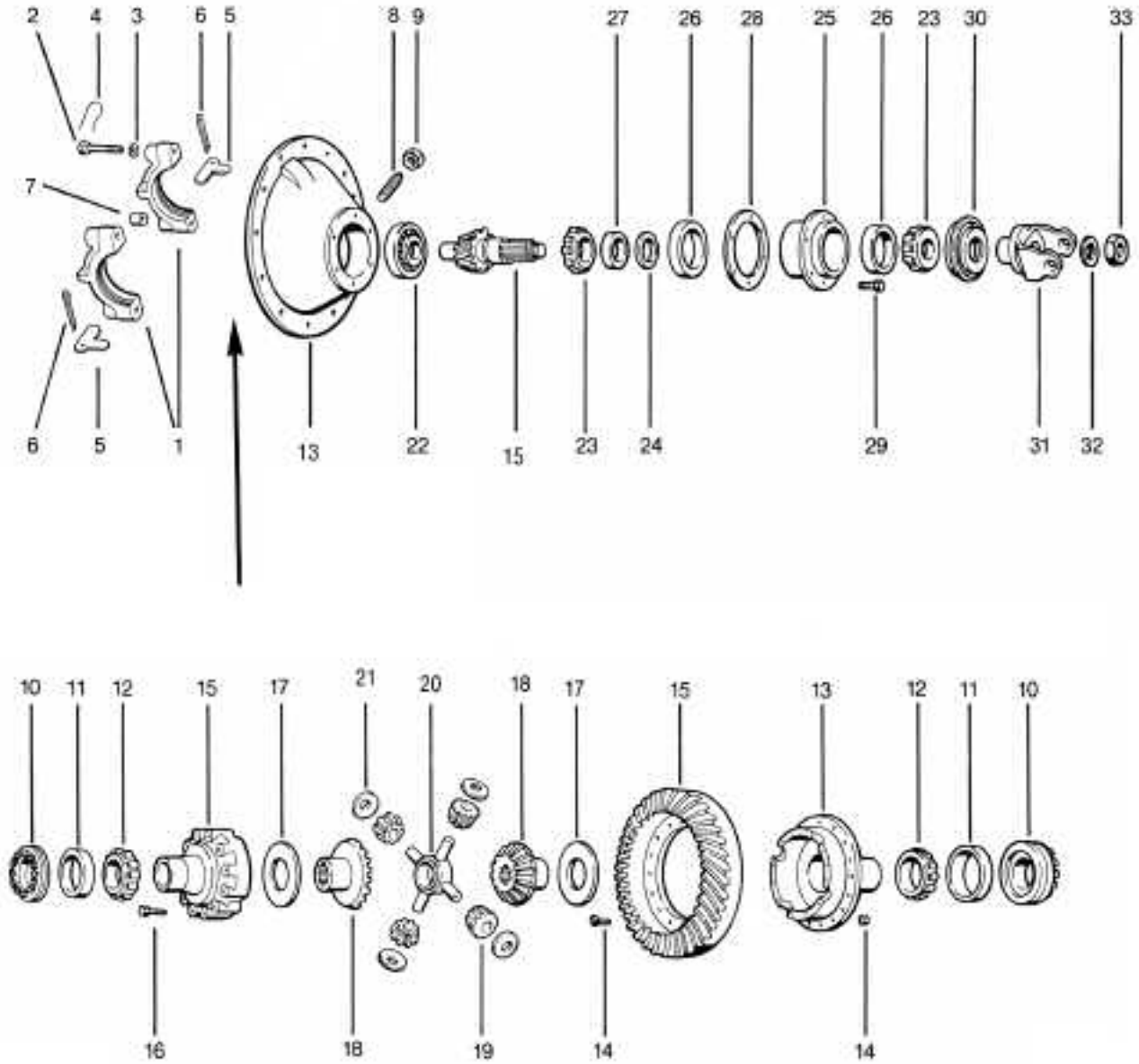

PARTS LISTED IN THIS CATALOG ARE NOT NECESSARILY MANUFACTURED BY THE ORIGINAL EQUIPMENT MANUFACTURER AND ANY REFERENCE TO THE TRADEMARKS OR PART NUMBERS OF OTHERS ARE FOR CROSS REFERENCE INFORMATIONAL PURPOSES ONLY. THE TRADEMARKS OF OTHERS REFERRED TO HEREIN ARE OWNED BY THEIR RESPECTIVE COMPANIES AND ARE NOT AFFILIATED IN ANY WAY WITH MIDWEST TRUCK & AUTO PARTS, INC.® MOTIVE GEAR® AND WORLD AMERICAN® ARE THE REGISTERED TRADEMARKS OF MIDWEST TRUCK & AUTO PARTS, INC.® USE OF THE ® IN CONNECTION WITH A MARK OF MIDWEST TRUCK & AUTO PARTS, INC.® INDICATES THAT THE MARK IS REGISTERED IN AT LEAST THE UNITED STATES. NO REPRESENTATION IS MADE WITH RESPECT TO THE SOURCE OF MANUFACTURE OF ANY PARTICULAR PART. © 2005, MIDWEST TRUCK & AUTO PARTS, INC.® ALL RIGHTS RESERVED.

EATON®

MODELS: RS461, RS521, RS581

ITEM NO.	PART NAME	QTY PER AXLE	RS461 RS521 RS581	REMARKS
	Bearing, Seal & Gasket Kit	1	RA18ER	
1	Diff. Carrier & Bearing Caps Carrier Casting No. 98493 (NSS)	1	122432	Includes Items 2-4, 7-9
2	Bearing Capscrew	4	32732	
3	Flat Washer	4	32912	
4	Lockwire	4	12563	
5	Bearing Cap Adjuster Lock	2	14275	
6	Cotter Pin	2	90876	
7	Dowel Bushing	2	32730	
8	Ring Gear Thrust Screw	1	126193	
9	Thrust Screw Jam Nut	1	210184	
10	Diff. Bearing Adjuster (RH)	1	21637	
	Diff. Bearing Adjuster (LH)	1	39448	
11	Diff. Bearing Cup (RH)	1	42384	
	Diff. Bearing Cup (LH)	1	42653	
12	Diff. Bearing Cone (RH)	1	42381	
	Diff. Bearing Cone (LH)	1	42652	
13	Diff. Case (Flanged Half) (NSS)	1	88501	Ratios 3.55-4.11
			126234	Ratios 4.33-6.17
	Diff. Case (RH) (NSS)	1	86777	
14	RING GEAR BOLT & NUT KIT	1	70745	Includes Item 14
	Bolt	16	67586	
	Nut	15	60600	
15	RING GEAR & DRIVE PINION SET	1	MATCHED PARTS: (SEE SEPARATE LISTING ON PAGE 53)	
	WHEEL DIFF. CASE KIT	1	98610	Ratios 3.55-4.11
	Includes Items 15-16	1	121845	Ratios 4.33-6.17
16	Diff. Case Capscrew	12	88503	
	WHEEL DIFF. SIDE GEAR & PINION KIT	1	114472	Includes Items 17-21
	WHEEL DIFF. KIT LESS SIDE GEARS	1	118749	Includes Items 17, 19-21
17	Side Gear Thrust Washer	2	27274	
18	Diff. Side Gear (36 Involute)	2	93401	
19	Side Pinion	4	86780	
20	Spider	1	86778	
21	Side Pinion Thrust Washer	4	86781	
22	Pinion Pilot Bearing	1	MUSB1308UM	
23	Pinion Bearing Cone (Inner)	1	78215C	
	Pinion Bearing Cone (Outer)	1	72212C	
24	Pinion Bearing Spacer	AR		CALL YOUR SALES REP
25	Pinion Bearing Cage & Cup Assy Includes Item 26	1	210592	Case (210591)
26	Pinion Bearing Cup (Inner)	1	78551	
	Pinion Bearing Cup (Outer)	1	72487	
27	Pinion Bearing Spacer Washer	1	31366	
28	Pinion Bearing Cage Shim	AR		
	.003"		67920	
	.005"		67921	
	.010"		67922	
	.020"		67923	
	.030"		67924	
29	Bearing Cage Capscrew	6	113327	
	OIL SEAL & SHIM KIT	1	122436	Includes Items 28, 30 & RTV
30	Oil Seal & Retainer	1	712937	
31	Input Yoke (Call your Sales Rep)	1		
32	Flat Washer	1	210509	
33	Pinion Nut	1	210508	
	Gasket Compound	AR	107276	

NSS = Not Sold Separately

PARTS LISTED IN THIS CATALOG ARE NOT NECESSARILY MANUFACTURED BY THE ORIGINAL EQUIPMENT MANUFACTURER AND ANY REFERENCE TO THE TRADEMARKS OR PART NUMBERS OF OTHERS ARE FOR CROSS REFERENCE INFORMATIONAL PURPOSES ONLY. THE TRADEMARKS OF OTHERS REFERRED TO HEREIN ARE OWNED BY THEIR RESPECTIVE COMPANIES AND ARE NOT AFFILIATED IN ANY WAY WITH MIDWEST TRUCK & AUTO PARTS, INC.® MOTIVE GEAR® AND WORLD AMERICAN® ARE THE REGISTERED TRADEMARKS OF MIDWEST TRUCK & AUTO PARTS, INC.® USE OF THE ® IN CONNECTION WITH A MARK OF MIDWEST TRUCK & AUTO PARTS, INC.® INDICATES THAT THE MARK IS REGISTERED IN AT LEAST THE UNITED STATES. NO REPRESENTATION IS MADE WITH RESPECT TO THE SOURCE OF MANUFACTURE OF ANY PARTICULAR PART. © 2005, MIDWEST TRUCK & AUTO PARTS, INC.® ALL RIGHTS RESERVED.

EATON®

MODELS: RS461, RS521, RS581

RING GEAR & PINION SETS

**REAR AXLE
MODEL: RS461, RS521, RS581**

<u>RATIO</u>	<u>PART#</u>	<u>TEETH COUNT</u>
3.55	122668	(39-11)
3.70	121887	(37-10)
3.90	123334	(39-10)
4.11	121888	(37-9)
4.33	121889	(39-9)
4.56	121890	(41-9)
4.88	121891	(39-8)
5.29	211335	(37-7)
5.43	121892	(38-7)
6.17	121893	(37-6)
6.50	212891	(39-6)

PARTS LISTED IN THIS CATALOG ARE NOT NECESSARILY MANUFACTURED BY THE ORIGINAL EQUIPMENT MANUFACTURER AND ANY REFERENCE TO THE TRADEMARKS OR PART NUMBERS OF OTHERS ARE FOR CROSS REFERENCE INFORMATIONAL PURPOSES ONLY. THE TRADEMARKS OF OTHERS REFERRED TO HEREIN ARE OWNED BY THEIR RESPECTIVE COMPANIES AND ARE NOT AFFILIATED IN ANY WAY WITH MIDWEST TRUCK & AUTO PARTS, INC.® MOTIVE GEAR® AND WORLD AMERICAN® ARE THE REGISTERED TRADEMARKS OF MIDWEST TRUCK & AUTO PARTS, INC.® USE OF THE ® IN CONNECTION WITH A MARK OF MIDWEST TRUCK & AUTO PARTS, INC.® INDICATES THAT THE MARK IS REGISTERED IN AT LEAST THE UNITED STATES. NO REPRESENTATION IS MADE WITH RESPECT TO THE SOURCE OF MANUFACTURE OF ANY PARTICULAR PART. © 2005, MIDWEST TRUCK & AUTO PARTS, Inc.™ ALL RIGHTS RESERVED.