

FULLER® 13 SPEED

MODEL RTLO-12713, RTLO-14713, RTLO-16713

Kits
 * = 110
 + = 111

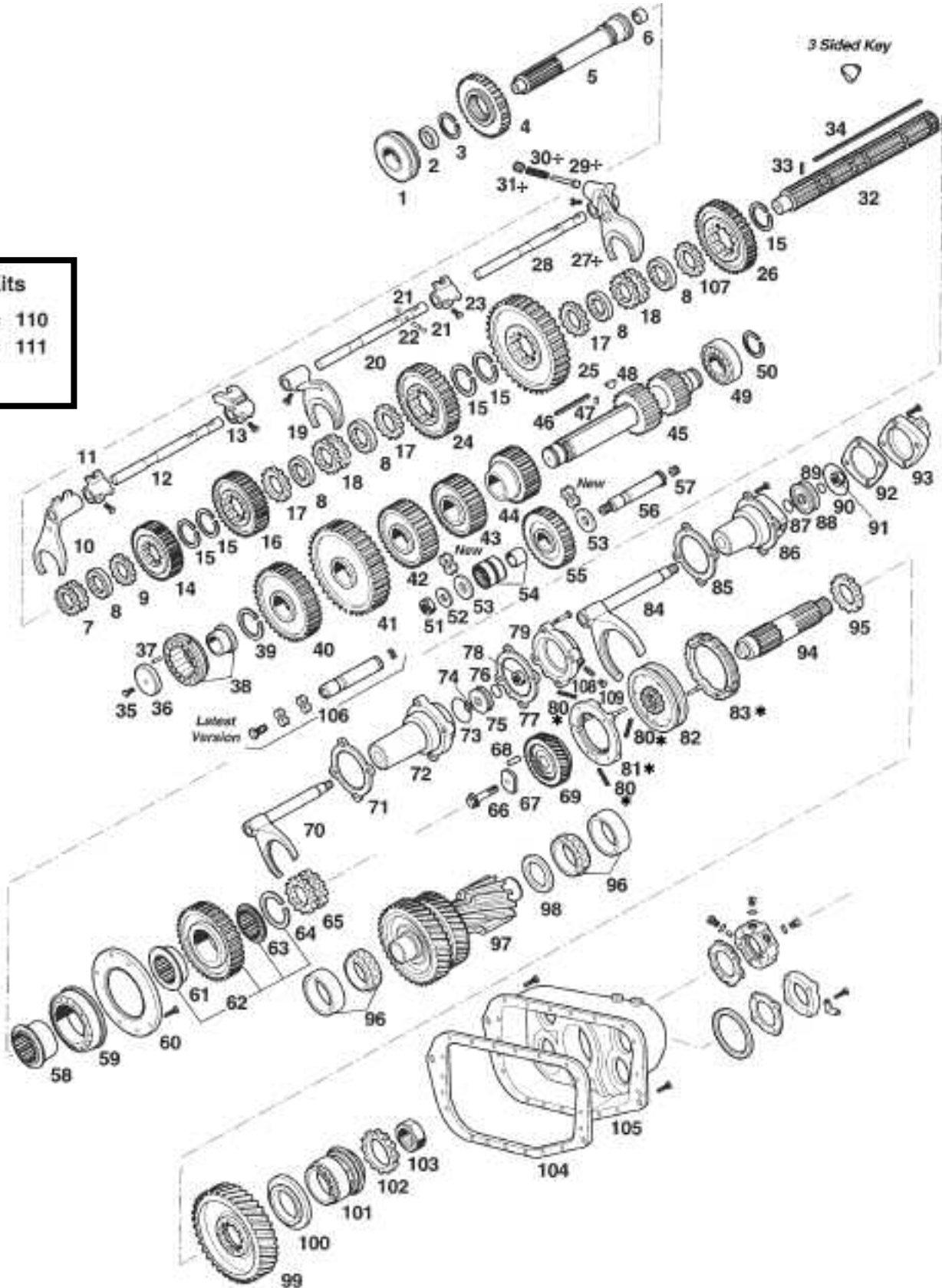

PARTS LISTED IN THIS CATALOG ARE NOT NECESSARILY MANUFACTURED BY THE ORIGINAL EQUIPMENT MANUFACTURER AND ANY REFERENCE TO THE TRADEMARKS OR PART NUMBERS OF OTHERS ARE FOR CROSS REFERENCE INFORMATIONAL PURPOSES ONLY. THE TRADEMARKS OF OTHERS REFERRED TO HEREIN ARE OWNED BY THEIR RESPECTIVE COMPANIES AND ARE NOT AFFILIATED IN ANY WAY WITH MIDWEST TRUCK & AUTO PARTS, INC.® MOTIVE GEAR® AND WORLD AMERICAN® ARE THE REGISTERED TRADEMARKS OF MIDWEST TRUCK & AUTO PARTS, INC.® USE OF THE ® IN CONNECTION WITH A MARK OF MIDWEST TRUCK & AUTO PARTS, INC.® INDICATES THAT THE MARK IS REGISTERED IN AT LEAST THE UNITED STATES. NO REPRESENTATION IS MADE WITH RESPECT TO THE SOURCE OF MANUFACTURE OF ANY PARTICULAR PART. © 2005, MIDWEST TRUCK & AUTO PARTS, INC.® ALL RIGHTS RESERVED.

FULLER® 13 SPEED

FIG.	PART#	DESCRIPTION	RTLO-12713	RTLO-14713	RTLO-16713
1	212SLV	BEARING	X	X	X
2	16463	SPACER	X	X	X
3	14750	SNAP RING	X	X	X
4	22959	GEAR MAIN DRIVE	X		
4	22961	GEAR MAIN DRIVE 52T		X	
4	4300238	GEAR MAIN DRIVE 52T			X
5	INPUT SHAFTS (SEE PGS. 327-328)				
6	16566	BUSHING	X	X	X
7	22026	SLIDING CLUTCH	X	X	X
8	4300830	WASHER (BLUE)	X	X	X
8	4300382	WASHER (WHITE)	X	X	X
8	4300383	WASHER (GREEN)	X	X	X
8	4300384	WASHER (ORANGE)	X	X	X
8	4300385	WASHER (PURPLE)	X	X	X
8	4300386	WASHER (YELLOW)	X	X	X
8	4300387	WASHER (BLACK)	X	X	X
9	22032	SPACER	X	X	X
10	20450	SHIFT YOKE	X	X	X
11	20120	SHIFTING BLOCK	X	X	X
12	18928	YOKE BAR	X	X	X
13	19063	SHIFTING BLOCK	X	X	X
14	23102	GEAR M/S 42T	X		
14	4300190	GEAR M/S 42T		X	X
15	14750	SNAP RING	X	X	X
16	19622	GEAR M/S 2ND SPEED 50T	X	X	X
17	14749	SPACER	X	X	X
18	16118	SLIDING CLUTCH	X	X	X
19	18922	SHIFT YOKE	X	X	X
20	18927	YOKE BAR	X	X	X
21	X-14-1200	BALL	X	X	X
22	1634	PIN	X	X	X
23	14658	SHIFTING BLOCK	X	X	X
24	21024	GEAR M/S 1ST SPEED 60T	X	X	

PARTS LISTED IN THIS CATALOG ARE NOT NECESSARILY MANUFACTURED BY THE ORIGINAL EQUIPMENT MANUFACTURER AND ANY REFERENCE TO THE TRADEMARKS OR PART NUMBERS OF OTHERS ARE FOR CROSS REFERENCE INFORMATIONAL PURPOSES ONLY. THE TRADEMARKS OF OTHERS REFERRED TO HEREIN ARE OWNED BY THEIR RESPECTIVE COMPANIES AND ARE NOT AFFILIATED IN ANY WAY WITH MIDWEST TRUCK & AUTO PARTS, INC.® MOTIVE GEAR® AND WORLD AMERICAN® ARE THE REGISTERED TRADEMARKS OF MIDWEST TRUCK & AUTO PARTS, INC.® USE OF THE ® IN CONNECTION WITH A MARK OF MIDWEST TRUCK & AUTO PARTS, INC.® INDICATES THAT THE MARK IS REGISTERED IN AT LEAST THE UNITED STATES. NO REPRESENTATION IS MADE WITH RESPECT TO THE SOURCE OF MANUFACTURE OF ANY PARTICULAR PART. © 2005, MIDWEST TRUCK & AUTO PARTS, INC.® ALL RIGHTS RESERVED.

FULLER®

13 SPEED (Cont'd)

FIG.	PART#	DESCRIPTION	RTLO-12713	RTLO-14713	RTLO-16713
24	4300240	GEAR M/S 60T			X
25	4300033	GEAR M/S 46T	X	X	
25	4300242	GEAR M/S			X
26	23653	REVERSE GEAR	X	X	X
27	16131	REVERSE YOKE	X	X	X
28	18926	YOKE BAR	X	X	X
29	10019	PIN	X	X	X
30	6392	SPRING	X	X	X
31	8968	PLUG	X	X	X
32	S-2562	MAIN SHAFT 17T	X	X	X
33	62504	PIN 3X16	X	X	X
34	4300120	KEY	X	X	X
35	X-7-1005	BOLT 5/8"	X	X	X
36	19548	LOCKING DISK	X	X	X
37	62511	PIN	X	X	X
38	MS1309GEXR	BEARING	X	X	X
39	19198	SNAP RING	X	X	X
40	21018	GEAR C/S 66T	X	X	
40	21018	GEAR C/S 66T			X
41	15953	GEAR C/S PTO 47T - LH PTO (LEFT)	X	X	X
41	20840	GEAR C/S PTO 45T - RH PTO (RIGHT)	X	X	X
42	21262	GEAR C/S 73T	X		
42	4300191	GEAR C/S 73T		X	X
43	21264	GEAR C/S 46T	X	X	X
44	21025	GEAR C/S 1ST 39T	X	X	
44	4300241	GEAR C/S 39T			X
45	K-2956	COUNTERSHAFT KIT	X	X	
45	K-2958	COUNTERSHAFT KIT			X
46	19673	KEY	X	X	X
47	62511	PIN	X	X	X
48	X-6-E	KEY	X	X	X
49	MU1308TV	BEARING	X	X	X
50	14317	SNAP RING	X	X	X

PARTS LISTED IN THIS CATALOG ARE NOT NECESSARILY MANUFACTURED BY THE ORIGINAL EQUIPMENT MANUFACTURER AND ANY REFERENCE TO THE TRADEMARKS OR PART NUMBERS OF OTHERS ARE FOR CROSS REFERENCE INFORMATIONAL PURPOSES ONLY. THE TRADEMARKS OF OTHERS REFERRED TO HEREIN ARE OWNED BY THEIR RESPECTIVE COMPANIES AND ARE NOT AFFILIATED IN ANY WAY WITH MIDWEST TRUCK & AUTO PARTS, INC.® MOTIVE GEAR® AND WORLD AMERICAN® ARE THE REGISTERED TRADEMARKS OF MIDWEST TRUCK & AUTO PARTS, INC.® USE OF THE ® IN CONNECTION WITH A MARK OF MIDWEST TRUCK & AUTO PARTS, INC.® INDICATES THAT THE MARK IS REGISTERED IN AT LEAST THE UNITED STATES. NO REPRESENTATION IS MADE WITH RESPECT TO THE SOURCE OF MANUFACTURE OF ANY PARTICULAR PART. © 2005, MIDWEST TRUCK & AUTO PARTS, INC.® ALL RIGHTS RESERVED.

FULLER®

13 SPEED (Cont'd)

FIG.	PART#	DESCRIPTION	RTLO-12713	RTLO-14713	RTLO-16713
51	X-1-1008	NUT	×	×	×
52	14283	WASHER	×	×	×
53	14282	WASHER - (OLD)	×	×	×
53	4302982	WASHER - (NEW)	×	×	×
54	FWA1830	BEARING	×	×	×
55	16757	REVERSE GEAR 27T	×	×	×
56	16405	REVERSE GEAR PIN	×	×	×
57	5202	PLUG	×	×	×
58	4302046	SPACER	×	×	×
59	5566503	BEARING	×	×	×
60	4300894	RETAINER RING	×	×	×
61	4300911	SPACER	×	×	×
62	K-2807	GEAR AUX. DRIVE	×	×	
62	K-2808	GEAR AUX. DRIVE			×
63	4303185	WASHER	×	×	×
64	4301254	SNAP RING	×	×	×
65	4300907	SLIDING CLUTCH	×	×	×
66	X-7-1007	BOLT 5/8"	×	×	×
67	4302334	LOCKING DISK	×	×	×
68	62511	PIN	×	×	×
69	4301838	GEAR 38T	×	×	
69	4302041	GEAR			×
70	A-6304	WELDED YOKE ASSY	×	×	
70	A-6303	WELDED YOKE ASSY			×
71	14632	GASKET	×	×	×
72	21609	CYLINDER	×	×	×
73	21208	O-RING	×	×	×
74	13653	O-RING	×	×	×
75	4301964	PISTON	×	×	×
76	21209	O-RING	×	×	×
77	17073	GASKET	×	×	×
78	X-1-805	NUT	×	×	×
79	4300927	CYLINDER COVER	×	×	×

PARTS LISTED IN THIS CATALOG ARE NOT NECESSARILY MANUFACTURED BY THE ORIGINAL EQUIPMENT MANUFACTURER AND ANY REFERENCE TO THE TRADEMARKS OR PART NUMBERS OF OTHERS ARE FOR CROSS REFERENCE INFORMATIONAL PURPOSES ONLY. THE TRADEMARKS OF OTHERS REFERRED TO HEREIN ARE OWNED BY THEIR RESPECTIVE COMPANIES AND ARE NOT AFFILIATED IN ANY WAY WITH MIDWEST TRUCK & AUTO PARTS, INC.® MOTIVE GEAR® AND WORLD AMERICAN® ARE THE REGISTERED TRADEMARKS OF MIDWEST TRUCK & AUTO PARTS, INC.® USE OF THE ® IN CONNECTION WITH A MARK OF MIDWEST TRUCK & AUTO PARTS, INC.® INDICATES THAT THE MARK IS REGISTERED IN AT LEAST THE UNITED STATES. NO REPRESENTATION IS MADE WITH RESPECT TO THE SOURCE OF MANUFACTURE OF ANY PARTICULAR PART. © 2005, MIDWEST TRUCK & AUTO PARTS, INC.® ALL RIGHTS RESERVED.

FULLER®

13 SPEED (Cont'd)

FIG.	PART#	DESCRIPTION	RTLO-12713	RTLO-14713	RTLO-16713
80	14897	SPRING	×	×	×
81	A-4938	SYNCHRONIZER RING	×	×	×
82	4303386	SLIDING CLUTCH	×	×	×
83	A-4937	SYNCHRONIZER RING	×	×	×
84	A-6188	WELDED YOKE ASSY	×	×	
84	A-6224	WELDED YOKE ASSY			×
85	14347	GASKET	×	×	×
86	430184	CYLINDER	×	×	×
87	14765	O-RING	×	×	×
88	14341	PISTON	×	×	×
89	14345	O-RING	×	×	×
90	14344	O-RING	×	×	×
91	X-1-1010	NUT	×	×	×
92	14349	GASKET	×	×	×
93	19690	CYLINDER COVER	×	×	×
94	4301079	MAIN SHAFT	×		
94	4301075	MAIN SHAFT		×	×
95	4301842	WASHER	×	×	×
96	ST4276	BEARING	×	×	
96	4301851	BEARING			×
97	A-5942	AUX. SHAFT	×	×	
97	A-6604	AUX. SHAFT			×
98	21342	WASHER	×	×	
98	4300897	WASHER			×
99	4300934	GEAR 56T	×	×	
99	4300940	GEAR 56T			×
100	4300912	SPACER	×	×	×
101	21355	BEARING	×		
101	21356	BEARING		×	×
102	20192	SPACER	×		
102	20191	SPACER		×	×
103	22254	NUT	×	×	×

PARTS LISTED IN THIS CATALOG ARE NOT NECESSARILY MANUFACTURED BY THE ORIGINAL EQUIPMENT MANUFACTURER AND ANY REFERENCE TO THE TRADEMARKS OR PART NUMBERS OF OTHERS ARE FOR CROSS REFERENCE INFORMATIONAL PURPOSES ONLY. THE TRADEMARKS OF OTHERS REFERRED TO HEREIN ARE OWNED BY THEIR RESPECTIVE COMPANIES AND ARE NOT AFFILIATED IN ANY WAY WITH MIDWEST TRUCK & AUTO PARTS, INC.® MOTIVE GEAR® AND WORLD AMERICAN® ARE THE REGISTERED TRADEMARKS OF MIDWEST TRUCK & AUTO PARTS, INC.® USE OF THE ® IN CONNECTION WITH A MARK OF MIDWEST TRUCK & AUTO PARTS, INC.® INDICATES THAT THE MARK IS REGISTERED IN AT LEAST THE UNITED STATES. NO REPRESENTATION IS MADE WITH RESPECT TO THE SOURCE OF MANUFACTURE OF ANY PARTICULAR PART. © 2005, MIDWEST TRUCK & AUTO PARTS, INC.® ALL RIGHTS RESERVED.

FULLER®
13 SPEED (Cont'd)

FIG.	PART#	DESCRIPTION	RTLO-12713	RTLO-14713	RTLO-16713
105	4300915	REAR COVER			×
106	K-3209	IDLER SHAFT REPL. KIT	×	×	×
107	4302047	SPACER	×	×	×
108	19974	INSERT VALVE	×	×	×
109	15719	PLUG	×	×	×
110	K-1946	SYNCHRONIZER KIT	×	×	×
111	S-1219	YOKE ASSY	×	×	×
112	K-1947	SYNCHRO KIT W/SLIDING CLUTCH (OLD)	×	×	×
112	K-1948	SYNCHRO KIT W/SLIDING CLUTCH (NEW)	×	×	×

CALL YOUR SALES REP FOR BEARING & SEAL KITS

PARTS LISTED IN THIS CATALOG ARE NOT NECESSARILY MANUFACTURED BY THE ORIGINAL EQUIPMENT MANUFACTURER AND ANY REFERENCE TO THE TRADEMARKS OR PART NUMBERS OF OTHERS ARE FOR CROSS REFERENCE INFORMATIONAL PURPOSES ONLY. THE TRADEMARKS OF OTHERS REFERRED TO HEREIN ARE OWNED BY THEIR RESPECTIVE COMPANIES AND ARE NOT AFFILIATED IN ANY WAY WITH MIDWEST TRUCK & AUTO PARTS, INC.® MOTIVE GEAR® AND WORLD AMERICAN® ARE THE REGISTERED TRADEMARKS OF MIDWEST TRUCK & AUTO PARTS, INC.® USE OF THE ® IN CONNECTION WITH A MARK OF MIDWEST TRUCK & AUTO PARTS, INC.® INDICATES THAT THE MARK IS REGISTERED IN AT LEAST THE UNITED STATES. NO REPRESENTATION IS MADE WITH RESPECT TO THE SOURCE OF MANUFACTURE OF ANY PARTICULAR PART. © 2005, MIDWEST TRUCK & AUTO PARTS, INC.® ALL RIGHTS RESERVED.