

EATON®

SINGLE AXLE 2-SPEED GEAR SETS

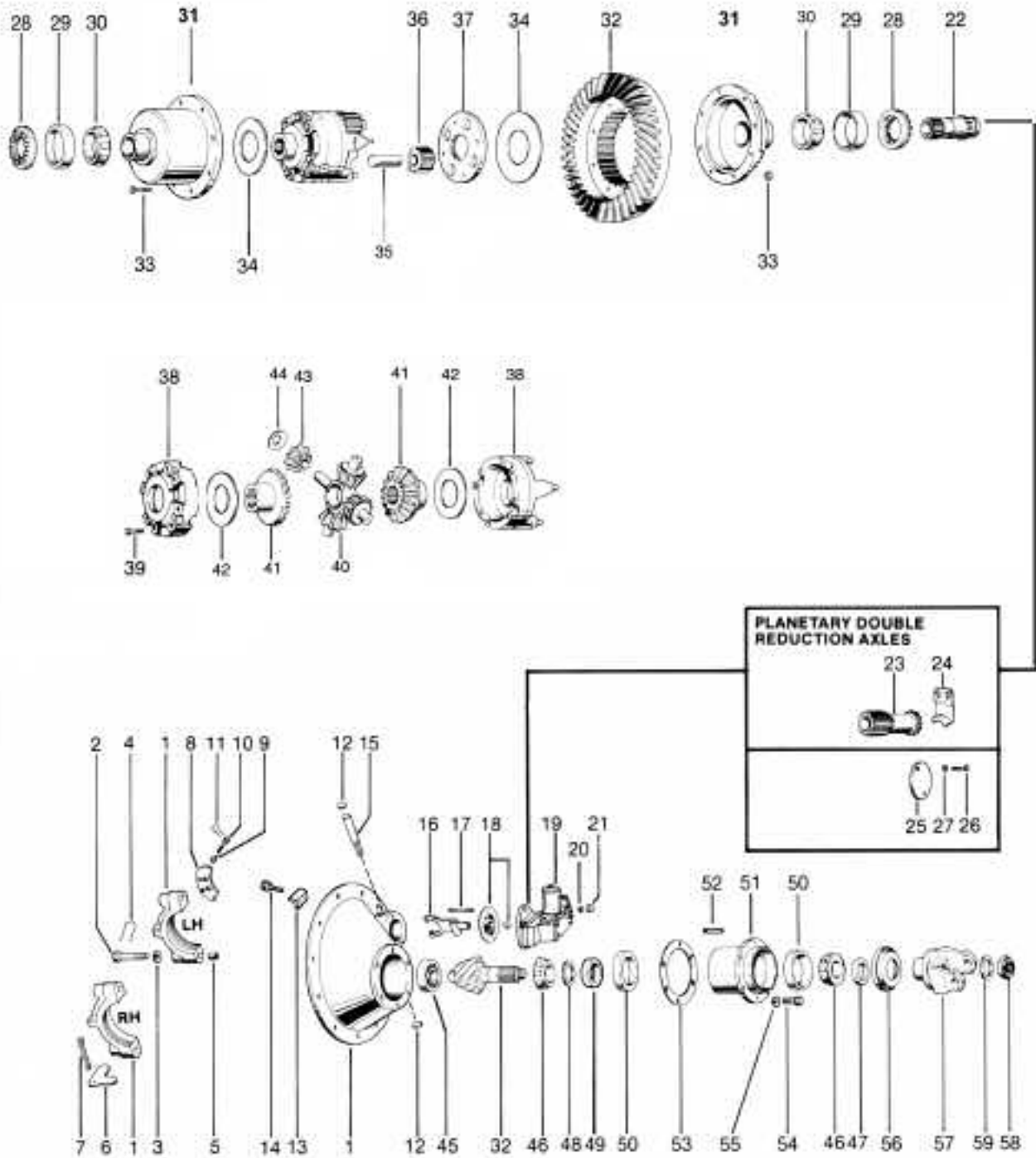

PARTS LISTED IN THIS CATALOG ARE NOT NECESSARILY MANUFACTURED BY THE ORIGINAL EQUIPMENT MANUFACTURER AND ANY REFERENCE TO THE TRADEMARKS OR PART NUMBERS OF OTHERS ARE FOR CROSS REFERENCE INFORMATIONAL PURPOSES ONLY. THE TRADEMARKS OF OTHERS REFERRED TO HEREIN ARE OWNED BY THEIR RESPECTIVE COMPANIES AND ARE NOT AFFILIATED IN ANY WAY WITH MIDWEST TRUCK & AUTO PARTS, INC.® MOTIVE GEAR® AND WORLD AMERICAN® ARE THE REGISTERED TRADEMARKS OF MIDWEST TRUCK & AUTO PARTS, INC.® USE OF THE ® IN CONNECTION WITH A MARK OF MIDWEST TRUCK & AUTO PARTS, INC.® INDICATES THAT THE MARK IS REGISTERED IN AT LEAST THE UNITED STATES. NO REPRESENTATION IS MADE WITH RESPECT TO THE SOURCE OF MANUFACTURE OF ANY PARTICULAR PART. © 2005, MIDWEST TRUCK & AUTO PARTS, INC.® ALL RIGHTS RESERVED.

SINGLE AXLE 2-SPEED GEAR SETS

ITEM NO.	PART NAME	QTY. PER AXLE	17201-21						35327
			15201	16244	17301-21	18201-21	18301-21	23221	
			15301	16344	21221	22221	26221	26321	
	Bearing, Seal & Gasket Kit	1	RA24R	RA23DR	RA1R	110635	RA72AR	110604	
		1	-----	-----	-----	-----	110572	-----	
		1	-----	-----	-----	-----	110598	-----	
1	Diff. Carrier & Bearing Caps Carrier Casting No. (NSS) 76929 (Includes Items 1-4, 12, 15, 17, 20, 21, 25 and Sealant) 76930 (Includes Items 1-4, 12, 15, 20, 21, 25) 67759 (Includes Items 1-5, 12, 15, 17, 20, 21, 25 and Sealant) 109365 (Includes Items 1-5, 12, 15, 17, 18, 20, 21, 25 and Sealant) 98590 (Includes Items 1-5, 9, 12, 15, 17, 18, 20, 21, 25 and Sealant)	1	76929 113641	76930 113643	67759 119856	109365 107493	98590 98496	98590 98496	
2	Bearing Capscrew	4	90036	14970	32732	32732	32732	32732	
3	Flat Washer	4	-----	-----	32912	32912	32912	32912	
4	Lockwire	2	12563	90536	90538	90538	12563	12563	
5	Dowel Bushing	2	-----	-----	32730	32730	32730	32730	
6	Bearing Cup Adjuster Lock (RH)	1	90186	13377	13377	13377	14275	14275	
7	Cotter Pin (RH)	1	90873	90873	90873	90873	90876	90876	
8	Bearing Cap Adjuster Lock (LH)	1	10602	14949	37745	37745	78926	78926	
9	Dowel Bushing (LH)	2	-----	-----	37746	37746	37746	37746	
10	Capscrew (LH)	2	126076	9820	37747	37747	12562	12562	
11	Lockwire (LH)	2	12563	90533	12563	12563	12563	12563	
12	Upper Expansion Plug	1	9797	9797	30703	30703	30703	30703	
	Lower Expansion Plug	1	9797	9797	9797	9797	9797	9797	
13	Oil Scraper (Not in 110598)	1	67814	67814	67814	-----	67814	-----	
14	Scraper Capscrew (Not in 110598)	2	67815	67815	67815	-----	67815	-----	
	2-SPEED ONLY PARTS								
15	Shift Fork Shaft Assembly	1	113800	113800	113801	113801	113801	-----	
	'O' Ring		113140	113140	113140	113140	113140	-----	
16	Shift Fork & Roller Assy	1	32326	32425	32613	32613	32679	-----	
17	Shift Fork Mounting Stud	2	119863	119863	119863	119863	119863	-----	
18	Shift Fork Seal & Spring Assy	1	119855	119855	119855	119855	119855	-----	
19	Shift Unit Assy.	1	CALL YOUR SALES REP						
20	Flat Washer	2	119857	119857	119857	119857	119857	-----	
21	Stud Nut	2	63028	63028	63028	63028	63028	-----	
	SLIDING CLUTCH SERVICE KIT (Includes Items 22, 28-LH, 34-LH, 37)	1	98089	95371	60608	60608	60609	-----	
22	Sliding Clutch	1	113599	113629	113596	113596	113593	-----	
	PDR ONLY PARTS								
	SUN GEAR SERVICE KIT (Includes Items 23-28-LH, 34-LH, 37)	1	-----	99552	62040	62040	62041	62041	
23	Sun Gear	6	113601	113631	113598	113598	113595	113595	
24	Sun Gear Retainer	1	45615	45325	43178	43178	43178	43178	
25	Shift Fork Opening Cover	1	45521	45521	45521	45521	45521	45521	
26	Stud/Screw	2	20807	20807	20807	119863	20807	20807	
27	Flat Washer	2	90415	90415	90415	119857	90415	90415	
28	Diff. Bearing Adjuster (RH)	1	10524	110243	110243	110243	21637	21637	
	Diff. Bearing Adjuster (LH)	1	74055	74022	56932	56932	56929	56929	
29	Diff. Bearing Cup (RH)	1	33472	493	493	439	42584	42584	
	Diff. Bearing Cup (LH)	1	493	42584	56650	56650	68712	68712	
30	Diff. Bearing Cone (RH)	1	33275	495A	497	497	42346	42381	
	Diff. Bearing Cone (LH)	1	498	42381	56425	56425	-----	-----	
	(W/Support Case 103537)	1	-----	-----	-----	-----	102660	102660	
	(W/Support Case 27950 NOTE 2)	1	-----	-----	-----	-----	21633	21633	

NSS = Not Sold Separately

PARTS LISTED IN THIS CATALOG ARE NOT NECESSARILY MANUFACTURED BY THE ORIGINAL EQUIPMENT MANUFACTURER AND ANY REFERENCE TO THE TRADEMARKS OR PART NUMBERS OF OTHERS ARE FOR CROSS REFERENCE INFORMATIONAL PURPOSES ONLY. THE TRADEMARKS OF OTHERS REFERRED TO HEREIN ARE OWNED BY THEIR RESPECTIVE COMPANIES AND ARE NOT AFFILIATED IN ANY WAY WITH MIDWEST TRUCK & AUTO PARTS, INC.® MOTIVE GEAR® AND WORLD AMERICAN® ARE THE REGISTERED TRADEMARKS OF MIDWEST TRUCK & AUTO PARTS, INC.® USE OF THE ® IN CONNECTION WITH A MARK OF MIDWEST TRUCK & AUTO PARTS, INC.® INDICATES THAT THE MARK IS REGISTERED IN AT LEAST THE UNITED STATES. NO REPRESENTATION IS MADE WITH RESPECT TO THE SOURCE OF MANUFACTURE OF ANY PARTICULAR PART. © 2005, MIDWEST TRUCK & AUTO PARTS, INC.® ALL RIGHTS RESERVED.

EATON®

SINGLE AXLE 2-SPEED GEAR SETS (Cont'd)

ITEM NO.	PART NAME	QTY. PER AXLE	17201-21 17301-21 18201-21 18301-21 21221 22221 21321 22321 23221 23321 26221 26321 35327						
			15201	16244	15301	16344	21221	22221	26221
31	Gear Support Case (RH)	1	20759	27860	110148	110148	21619	108138	
	Gear Support Case (LH)	1	13385	27859	27838	27838	106471	106471	
	(106471 includes 102660 Cone)								
32	RING GEAR & DRIVE PINION SET (NSS)		MATCHED PARTS: (SEE SEPARATE LISTING ON PAGE 43)						
33	RING GEAR BOLT & NUT KIT	1	121448	121449	87955	87955	87955	87955	
	Bolt	8	44355	44356	44358	44358	44358	44358	
	Nut	8	60597	60598	60599	60599	60599	60599	
	Kit 121448 contains 6 each bolts and nuts								
34	Gear Support Thrust Washer (RH)	1	20850	18346	27827	27827	18198	83726	
	Gear Support Thrust Washer (LH)	1	43268	43269	43270	43270	43271	43271	
35	Idler Pinion Pin	4	20821	14935	27861	27861	27953	106144	
36	Idler Pinion	4	74057	27875	27835	27835	27952	27952	
37	High-Speed Clutch Plate	1	74056	74023	56931	56931	56928	56928	
	WHEEL DIFF. CASE KIT	1	52112	NOTE 1	101878	101878	98584	109270	
	(Includes Items 38-39)								
38	Diff. Case w/clutch plate pin	1	408237	NOTE 1	98182	98182	98183	108146	
	Diff. Case (LH)		71880	NOTE 1	96278	96278	96280	108139	
	Diff. Case (RH)		71881	NOTE 1	96279	96279	96281	108140	
39	Diff. Case Capscrew	8	109237	109238	96283	96283	96284	96284	
	Diff. Case Capscrew	4	-----	-----	-----	-----	96285	96285	
	WHEEL DIFF. KIT (Includes Items 40-44)								
	Involute Side Gear	1	114467	114242	-----	114470	114474	109267	
	17 Series	1	-----	-----	114469	-----	-----	-----	
	18, 21 Series	1	-----	-----	114470	-----	-----	-----	
40	Spider	1	20766	25971	38289	38289	107371	108141	
41	Diff. Side Gear								
	22 Involute Splines	2	-----	-----	-----	-----	98257	-----	
	34 Involute Splines	2	110522	-----	-----	-----	110528	-----	
	36 Involute Splines	2	-----	110524	-----	-----	110528	-----	
	39 Involute Splines	2	-----	-----	110525	-----	-----	108143	
	41 Involute Splines	2	-----	-----	110527	110527	-----	-----	
	16 Straight Splines								
	(IHC 15 Series Only)	2	110510	102497	37072	-----	-----	-----	
	16 Angular Splines								
	(Chrysler® 15 Series Only)	2	110509	102498	-----	-----	-----	-----	
	19 Angular Splines	2	102511	-----	-----	-----	-----	-----	
42	Side Gear Thrust Washer	2	20850	18346	27827	27827	18198	83726	
43	Side Pinion	4	102512	102500	104139	104139	96900	108142	
44	Side Pinion Thrust Washer	4	25968	64467	27810	27810	18199	108145	
	WHEEL DIFF. KIT LESS SIDE GEARS								
	(Includes Items 42-44)	1	118746	118747	118748	118748	118750	118751	
45	Pinion Pilot Bearing	1	MU1305TDM	MUS1307UM	MUS1307UM	MUS1307UM	MUS1308UM	MUS1308UM	
46	Pinion Bearing Cone (Inner)	1	HM903249	55175C	55200C	72200C	78215C	78215C	
	Pinion Bearing Cone (Outer)	1	HM903249	55175C	55200C	55200C	72212C	72212C	
47	Flat Washer	1	12904	-----	-----	-----	-----	-----	
48	Pinion Bearing Spacer	AR			CALL YOUR SALES REP				
49	Spacer Washer	1	-----	-----	-----	-----	31366	31366	
50	Pinion Bearing Cup (Inner)	1	HM903210	55437	55437	72487	78551	78551	
	Pinion Bearing Cup (Outer)	1	HM903210	55437	55437	75487	72487	72487	
51	Pinion Bearing Cage & Cup Assy	1							
	(Cage 76896)	1	76897	-----	-----	-----	-----	-----	
	(Cage 75107) 16" Ring Gear	1	-----	-----	75108	-----	-----	-----	
	(Cage 75109) 16-1/2" Ring Gear	1	-----	75110	75110	-----	-----	-----	
	(Cage 107495)	1	-----	-----	-----	107496	-----	-----	
	(Cage 79245)	1	-----	-----	-----	-----	79246	79246	
52	Dowel Pin	1	90654	-----	-----	-----	-----	-----	

NSS = Not Sold Separately

PARTS LISTED IN THIS CATALOG ARE NOT NECESSARILY MANUFACTURED BY THE ORIGINAL EQUIPMENT MANUFACTURER AND ANY REFERENCE TO THE TRADEMARKS OR PART NUMBERS OF OTHERS ARE FOR CROSS REFERENCE INFORMATIONAL PURPOSES ONLY. THE TRADEMARKS OF OTHERS REFERRED TO HEREIN ARE OWNED BY THEIR RESPECTIVE COMPANIES AND ARE NOT AFFILIATED IN ANY WAY WITH MIDWEST TRUCK & AUTO PARTS, INC.® MOTIVE GEAR® AND WORLD AMERICAN® ARE THE REGISTERED TRADEMARKS OF MIDWEST TRUCK & AUTO PARTS, INC.® USE OF THE ® IN CONNECTION WITH A MARK OF MIDWEST TRUCK & AUTO PARTS, INC.® INDICATES THAT THE MARK IS REGISTERED IN AT LEAST THE UNITED STATES. NO REPRESENTATION IS MADE WITH RESPECT TO THE SOURCE OF MANUFACTURE OF ANY PARTICULAR PART. © 2005, MIDWEST TRUCK & AUTO PARTS, INC.® ALL RIGHTS RESERVED.

EATON®

2-SPEED GEAR SETS (Cont'd)

ITEM NO.	PART NAME	QTY. PER AXLE	17201-21 17301-21 18201-21 18301-21						23221 23321 26221 26321	35327
			15201 15301	16244 16344	21221 21321	22221 22321	11552	11558		
	OIL SEAL & SHIM KITS	1	115450 OR 114265	114104	114104	11552	11558	11582	11582	
53	Pinion Bearing Cage Shims .003" .005" .010" .020"	AR	75968 75969 75970 75971	43588 61991 43589 61994	43588 61991 43589 61994	107567 107568 107569 107570	67920 67921 67922 67923	67920 67821 67922 67923		
54	Bearing Cage Capscrew	6	113325	113325	113325	113325	113327	113327		
55	Lockwasher	6	-----	-----	-----	-----	90422	90422		
56	Oil Seal	1	722250	9773	9773	9773	712937	712937		
57	Input Yoke (Call Your Sales Rep)	1	-----	-----	-----	-----	-----	-----		
58	Pinion Nut Ratios 3.55-4.33 Ratios 4.56-7.17	1 1 1	95203 ----- -----	95204 ----- -----	----- 95206 95205	----- 95206 -----	----- 95262 -----	----- 95262 -----		
59	Flat Washer (With #95206 Nut) (With #95206 Nut)	1 1 1	23991 ----- -----	14354 ----- -----	----- 56864 4327	----- 56864 -----	----- ----- -----	----- ----- -----		
	Gasket Compound	1	107276	107276	107276	107276	107276	107276		

NOTE 1: Wheel Diff. Kit **51559** may be updated. If the diff. case needs replacement, the entire wheel diff. assembly may be upgraded. Upgraded kits vary by side gear.

UPGRADE

KIT NO.

121962

121963

121964

121965

SIDE GEAR

126000 (36 Involute)

210386 (30 Involute)

210387 (16 Angular)

210388 (16 Straight)

VEHICLE MFG.

Ford®, Navistar®, GMC®

Mack® Midliner®

Ford® (Before 2/1/86)

Navistar®, GMC® (Before 2/1/86)

The above kits contain the side gear specified, plus:

- 126001 Side Pinion
- 126002 Spider
- 126003 Side Pinion Thrust Washer
- 126004 Side Gear & Support Case Thrust Washer
- 126006 Diff. Case with Clutch Plate Pin
- 126007 Diff. Case
- 126008 Idler Pinion Pin
- 126009 Gear Support Case
- 126075 Capscrew
- 109238 Capscrew

NOTE 2: Earlier models used a 27950 case. This case is no longer available and has been superseded by 103527. However, the 103527 case does not have to be used when converting to the larger differential parts. Continue using the 27950 case and 21633 bearing if serviceable. If the 27950 case is unserviceable, order Parts Kit 106471. Kit 106471 contains the 103537 case and 102660 bearing, which must be used together.

PARTS LISTED IN THIS CATALOG ARE NOT NECESSARILY MANUFACTURED BY THE ORIGINAL EQUIPMENT MANUFACTURER AND ANY REFERENCE TO THE TRADEMARKS OR PART NUMBERS OF OTHERS ARE FOR CROSS REFERENCE INFORMATIONAL PURPOSES ONLY. THE TRADEMARKS OF OTHERS REFERRED TO HEREIN ARE OWNED BY THEIR RESPECTIVE COMPANIES AND ARE NOT AFFILIATED IN ANY WAY WITH MIDWEST TRUCK & AUTO PARTS, INC.® MOTIVE GEAR® AND WORLD AMERICAN® ARE THE REGISTERED TRADEMARKS OF MIDWEST TRUCK & AUTO PARTS, INC.® USE OF THE ® IN CONNECTION WITH A MARK OF MIDWEST TRUCK & AUTO PARTS, INC.® INDICATES THAT THE MARK IS REGISTERED IN AT LEAST THE UNITED STATES. NO REPRESENTATION IS MADE WITH RESPECT TO THE SOURCE OF MANUFACTURE OF ANY PARTICULAR PART. © 2005, MIDWEST TRUCK & AUTO PARTS, INC.® ALL RIGHTS RESERVED.

EATON®

2-SPEED AND PLANETARY DOUBLE REDUCTION

RING GEAR & PINION SETS

MODEL 15201, 15301 GEAR: 14-1/4"

GEAR RATIO	GEAR SET	TEETH COUNT
4.46/6.34	98754	(41-9)
5.14/7.16	98755	(36-7)
5.57/7.75	110180	(39-7)
5.86/8.15	113450	(41-7)
6.29/8.74	113451	(44-7)

MODEL 16244, 16344 GEAR: 15-1/2"

GEAR RATIO	GEAR SET	TEETH COUNT
4.11/5.72	107947	(37-9)
4.56/6.34	96797	(41-9)
4.88/6.78	96798	(39-8)
5.29/7.36	118928	(37-7)
5.57/7.75	96799	(39-7)
6.14/8.55	111395	(43-7)
6.57/9.14	113455	(46-7)
7.17/9.97	96802	(43-6)



MODEL 17201, 17301, 18201, 18301 GEAR: 16"

GEAR RATIO	GEAR SET	TEETH COUNT
3.70/5.05	96833	(37-10)
4.11/5.61	96834	(37-9)
4.33/5.91	96835	(39-9)
4.56/6.21	96836	(41-9)
4.88/6.65	96837	(39-8)
5.29/7.21	96838	(37-7)
5.57/7.60	96839	(39-7)

MODEL 17221, 17321, 18221, 18321 GEAR: 16-1/2"

GEAR RATIO	GEAR SET	TEETH COUNT
5.57/7.60	96840	(39-7)
6.14/8.38	96841	(43-7)
6.57/8.96	113467	(46-7)
7.17/9.77	96843	(43-6)

MODEL 21221, 21321 GEAR: 3.55/4.84-3.70/5.05 16" OTHERS: 16-1/2"

GEAR RATIO	GEAR SET	TEETH COUNT
3.55/4.84	111513	(39-11)
3.70/5.05	111514	(37-10)
3.90/5.31	111526	(39-10)
4.11/5.61	111515	(37-9)
4.33/5.91	111516	(39-9)
4.56/6.21	111517	(41-9)
4.88/6.65	111518	(39-8)
5.29/7.21	111519	(37-7)
5.57/7.60	111520	(39-7)
6.14/8.38	111521	(43-7)
6.50/8.86	111522	(39-6)
7.17/9.77	111523	(43-6)

MODEL: 22221, 22321 GEAR: 17"

GEAR RATIO	GEAR SET	TEETH COUNT
3.90/5.32	107557	(39-10)
4.11/5.61	107558	(37-9)
4.33/5.91	107559	(39-9)
4.62/6.31	107560	(37-8)
4.88/6.65	107561	(39-8)
5.29/7.21	107562	(37-7)
5.57/7.60	107563	(39-7)
6.17/8.40	107564	(37-6)
6.50/8.86	107565	(39-6)
7.17/9.77	107566	(43-6)

MODEL: 23221, 23321, 26221, 26321, 35327 GEAR: 18"

GEAR RATIO	GEAR SET	TEETH COUNT
3.70/5.04	98107	(37-10)
4.11/5.60	98108	(37-9)
4.33/5.90	98109	(39-9)
4.56/6.21	98110	(41-9)
4.88/6.64	98111	(39-8)
5.43/7.39	98112	(38-7)
6.17/8.40	98113	(37-6)
6.67/9.08	98114	(40-6)

PARTS LISTED IN THIS CATALOG ARE NOT NECESSARILY MANUFACTURED BY THE ORIGINAL EQUIPMENT MANUFACTURER AND ANY REFERENCE TO THE TRADEMARKS OR PART NUMBERS OF OTHERS ARE FOR CROSS REFERENCE INFORMATIONAL PURPOSES ONLY. THE TRADEMARKS OF OTHERS REFERRED TO HEREIN ARE OWNED BY THEIR RESPECTIVE COMPANIES AND ARE NOT AFFILIATED IN ANY WAY WITH MIDWEST TRUCK & AUTO PARTS, INC.® MOTIVE GEAR® AND WORLD AMERICAN® ARE THE REGISTERED TRADEMARKS OF MIDWEST TRUCK & AUTO PARTS, INC.® USE OF THE ® IN CONNECTION WITH A MARK OF MIDWEST TRUCK & AUTO PARTS, INC.® INDICATES THAT THE MARK IS REGISTERED IN AT LEAST THE UNITED STATES. NO REPRESENTATION IS MADE WITH RESPECT TO THE SOURCE OF MANUFACTURE OF ANY PARTICULAR PART. © 2005, MIDWEST TRUCK & AUTO PARTS, INC.® ALL RIGHTS RESERVED.

