

# ROCKWELL®

## SL/SQ100; SQHP FRONT

**NOTE:** ITEMS 1 THRU 13 NOT INCLUDED IN CARRIER ASSY.

**FORWARD DIFFERENTIAL  
CARRIER & THRU-SHAFT  
ASSEMBLY**

**TANDEM MODELS: SQHP,  
SQ-100, SQ-100P, SL-100,  
SL-100P, SQR-100, SQR-100P**

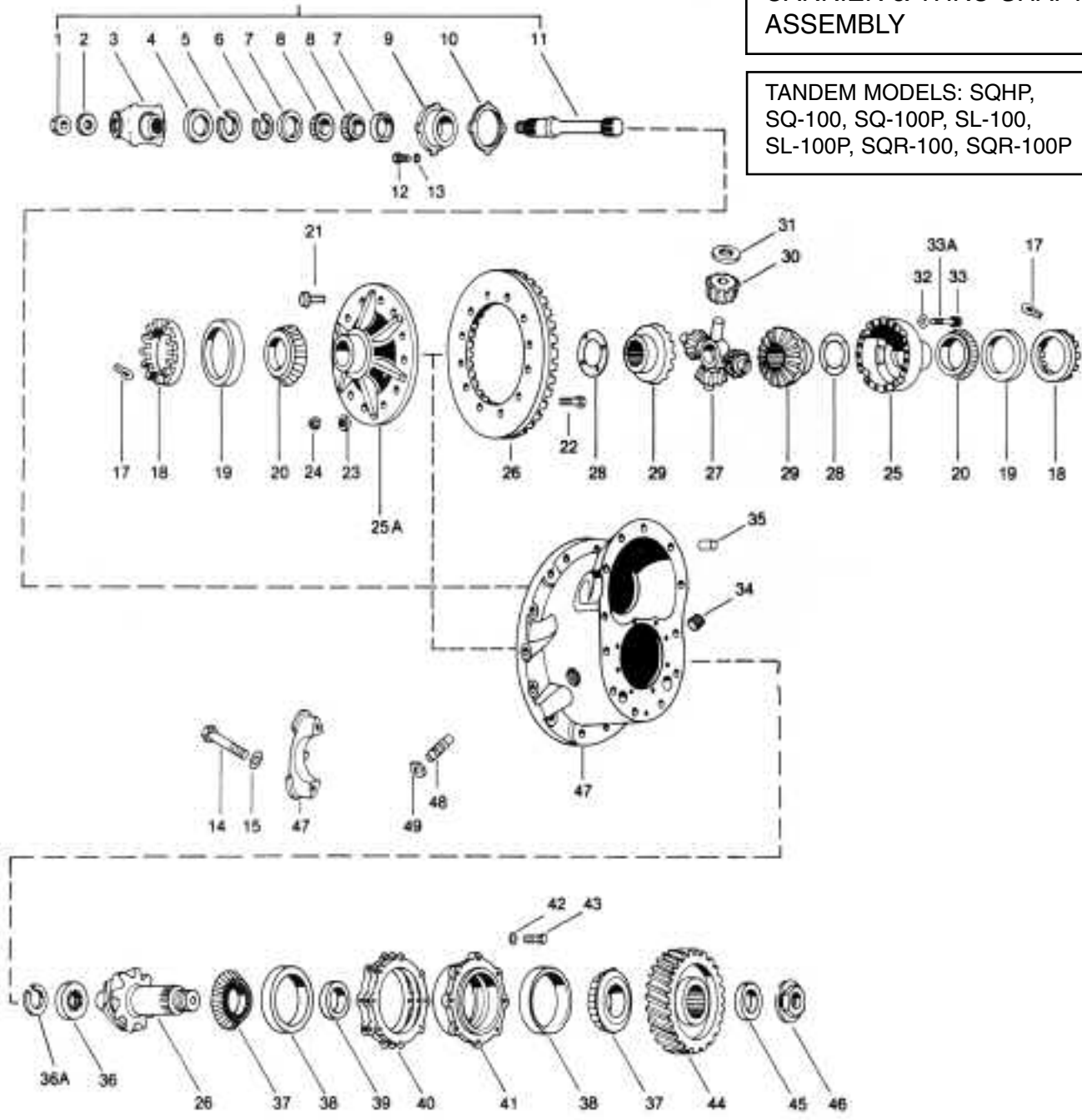

PARTS LISTED IN THIS CATALOG ARE NOT NECESSARILY MANUFACTURED BY THE ORIGINAL EQUIPMENT MANUFACTURER AND ANY REFERENCE TO THE TRADEMARKS OR PART NUMBERS OF OTHERS ARE FOR CROSS REFERENCE INFORMATIONAL PURPOSES ONLY. THE TRADEMARKS OF OTHERS REFERRED TO HEREIN ARE OWNED BY THEIR RESPECTIVE COMPANIES AND ARE NOT AFFILIATED IN ANY WAY WITH MIDWEST TRUCK & AUTO PARTS, INC.® MOTIVE GEAR® AND WORLD AMERICAN® ARE THE REGISTERED TRADEMARKS OF MIDWEST TRUCK & AUTO PARTS, INC.® USE OF THE ® IN CONNECTION WITH A MARK OF MIDWEST TRUCK & AUTO PARTS, INC.® INDICATES THAT THE MARK IS REGISTERED IN AT LEAST THE UNITED STATES. NO REPRESENTATION IS MADE WITH RESPECT TO THE SOURCE OF MANUFACTURE OF ANY PARTICULAR PART. © 2005, MIDWEST TRUCK & AUTO PARTS, INC.® ALL RIGHTS RESERVED.

# ROCKWELL®

## SL/SQ100; SQHP FRONT

ITEM	DESCRIPTION	QTY	PART NO.	REMARKS	
	<b>Bearing, Seal &amp; Gasket Kit</b>		RA194FR		
1	Nut - thru-shaft	1	1227Q901		
2	Washer - thru-shaft	1	1229A2653	(QRD/QRP/ QRF)	
3	Yoke - thru-shaft	1		<b>CALL YOUR SALES REP</b>	
4	Oil Seal Assy - thru-shaft bearing cage	1	473274N 4561V	Pre 8/83 Triple lip seal	
5	Snap Ring - thru-shaft	As req.		<b>CALL YOUR SALES REP</b>	
6	Snap Ring - thru-shaft	1	1829A859		
7	Cup - thru-shaft bearing	2	LM603011		
8	Cone - thru-shaft bearing	2	LM603049		
9, 7	Bearing Cage Assy - thru-shaft	1	A3226X596		
10	Gasket - thru-shaft bearing cage	1	2208C445		
11	Thru-shaft	1	3280T5688		
12	Capscrew - thru-shaft bearing cage	4	15X387	(QRD/QRP, QRF)	
13	Washer - thru-shaft bearing cage	4	1229K1597		
14	Capscrew - Diff. bearing cap	4	S21238-1 10X1023	Aluminum cover	
15	Washer - Diff. bearing cap	4	1229V1556		
16	Dowel pin - Diff. bearing cap	2	<b>See Item 47</b>	Not shown	
17	Cotter - Diff. bearing adj. ring	2	1199R2176		
18	Adj. ring - Diff. bearing	2	2214Z208		
19	Cup - Diff. bearing	2	JM716610		
20	Cone - Diff. bearing	2	JM716649		
21	Rivet - Bevel gear to case (opt.)	12	RV71013		
22	Bolt - Bevel gear to case	12	15X1626	Available in KIT 2306	
			QRD, QRP, QRF QHP, QD, QP, LD, LP	Available in KIT 570	
23	Washer - Bevel gear to case	12	1229U1503	Available in KIT 570	
24	Nut - Bevel gear to case	12	NL110-1	Available in KIT 570	
25~, 25A~ 32, 33, 33A	*Differential Case Assy. - Main	1	A28-3235D1174 A26-3235L1156 A19-3235C1173	Standard ratios Medium ratios Fast ratios	
25~, 25A~, 27, 28, 29, 30,31,32,33	*Differential Case and Nest Assy.	1	A18-3235D1174 A34-3235D1174 A44-3235D1174	Standard ratios	
25~, 25A~, 27, 28, 29, 30,31,32,33	*Differential Case and Nest Assy.	1	A17-3235L1156 A43-3235L1156 A51-3235L1156	Medium ratios	
25~, 25A~, 27, 28, 29, 30,31,32,33	*Differential Case and Nest Assy.	1	A13-3235C1173 A33-3235C1173 A43-3235C1173	Fast ratios	
26~	*Drive gear & pinion assy.	1	<b>See Page 113</b>		
27	Spider-diff.	1	3278S305		
28	Thrust washer - Diff. side gear	2	1229T1034		
29	Side gear - main differential	2	2234C783 2234D966 2234F1046	2.10" - 41 Spline 2.00" - 39 Spline 2.10" - 41 Spline	
30	Pinion diff.	4	2233U151 2233J1024		
31	Thrust Washer - Diff. pinion	4	1229R1032		
32	Washer - Diff. case	16	1229C1511		
33	Capscrew - Diff. case	16	S2826P-1		
33A	Thread locking liquid/diff. case	1	2297C3747	.34 oz. tube - <b>See NOTE on Page 112</b>	
34	Plug-filler	1	P212		
35	Dowel-helical gear cover to cover	2	1246M455		
36	Spigot bearing - drive pinion	1	RU1570UM		
36A	Lock ring - drive pinion	1	1229A1301		
37	Cone - drive pinion bearing	2	72212C		
38	Cup - drive pinion bearing	2	72487		
39	Shim spacer - drive pinion	As req.		<b>CALL YOUR SALES REP</b>	
40	Shim - Pinion forward bearing cage	.003 .005 .010	3 4 1	2203A6319 2203B6320 2203C6321	Available in KIT 1500

~ = Not serviced separately.

\* = Specify ratios. When changing ratios from standard to medium or fast, you must change differential

PARTS LISTED IN THIS CATALOG ARE NOT NECESSARILY MANUFACTURED BY THE ORIGINAL EQUIPMENT MANUFACTURER AND ANY REFERENCE TO THE TRADEMARKS OR PART NUMBERS OF OTHERS ARE FOR CROSS REFERENCE INFORMATIONAL PURPOSES ONLY. THE TRADEMARKS OF OTHERS REFERRED TO HEREIN ARE OWNED BY THEIR RESPECTIVE COMPANIES AND ARE NOT AFFILIATED IN ANY WAY WITH MIDWEST TRUCK & AUTO PARTS, INC.® MOTIVE GEAR® AND WORLD AMERICAN® ARE THE REGISTERED TRADEMARKS OF MIDWEST TRUCK & AUTO PARTS, INC.® USE OF THE ® IN CONNECTION WITH A MARK OF MIDWEST TRUCK & AUTO PARTS, INC.® INDICATES THAT THE MARK IS REGISTERED IN AT LEAST THE UNITED STATES. NO REPRESENTATION IS MADE WITH RESPECT TO THE SOURCE OF MANUFACTURE OF ANY PARTICULAR PART. © 2005, MIDWEST TRUCK & AUTO PARTS, INC.® ALL RIGHTS RESERVED.

# ROCKWELL®

## SL/SQ100, SQHP FRONT (Cont'd)

ITEM	DESCRIPTION	QTY	PART NO.	REMARKS
41, 38	Drive pinion cage & bearing	1	A3226R564	
	Cup assembly		A3226U749	Aluminum carrier
42	Washer - drive pinion bearing cage	7	1229C1511	
		8		Aluminum carrier
43	Capscrew - drive pinion bearing cage	7	S2812-2	
		8	15X1558	Aluminum carrier
44	Gear - helical driven	1	3892S3945	
45	Washer - drive pinion	1	1229N1730	
46	Nut-drive pinion	1	1227N898	
47, 14,	Diff. carrier & cap assy.	1	A2-3200R1032	
15, 16	Use with KIT 533 (Silastic)		A2-3200L1078	Aluminum carrier
47A	Adhesive - bearing cup	1	2297T4180	Not shown, 2-.5 cc tubes (1 tube per bearing)
48	Screw - thrust block adj.	1	15X1025	
49	Nut-drive gear thrust block screw	1	13X41	
50	Cone - Input shaft bearing cage	1	JM511946	
51	Cup - Input shaft bearing cage	1	JM511910	
52	Shim	1	2203R6518 2203S6519 2203T6520	Available in KIT 1500
53, 51	Input shaft bearing cage assy.	1	A3226M585	
54	Washer - Input shaft bearing cage	6	1229E1513	
55	Capscrew - Input shaft bearing cage	6	S2711-1	
56	Oil Seal - Input shaft	1	476023N 100495	Pre 8/83 Trip lip seal
57	Deflector - yoke	1	DEFR50-4	
58, 57	Input shaft yoke assy.	1		<b>CALL YOUR SALES REP</b>
59	Washer - Input shaft	1	1229T1736	
60	Nut - Input shaft	1	1227R902	
61	Washer - helical gear cover to carrier	12	1229C1511	
62	Capscrew - helical gear cover to cover	12 2 10	S2812-2 S2812-2 15X1558	Aluminum carrier
63	Gasket - helical gear cover to carrier	1	1199T3842	(Silastic)
64	Cover - helical gear	1	3280U8081 KIT 2268	After 8/83 Prior to 8/83
64A	Cover - helical gear	1	3266H970 KIT 2269	After 8/83 Prior to 8/83
64B	Tube - helical gear cover	1	2297V2284	QHP, LP/QP-100 Not shown - old style
64C	Plug - helical gear cover - Welch®	1	PW214	Not shown - old style
65	Plug - helical gear cover drain	1	P26	
66	Spring - push rod	1	2258U411	
67	Push rod	1	2244E83 2297X2494	After 8/83 Old style - Prior to 8/83
68, 69	Air shaft chamber assy.	1	A1-3261V308	Includes attaching hardware <b>(Item No. 20) SEE KIT 2266</b>
69	Capscrew - air shift chamber assy.	4	10X1334	Includes attaching hardware <b>(Item No. 20) SEE KIT 2266</b>
70, 71~	Shaft assy - pump drive	1	A1-2297B4240	<b>SEE KIT 1588</b>
72	Snap ring - pump shaft	1	1229G2763	Used with QHP, LP/QP-100 only.
73	Gear - pump drive	1	3892Z4368	Used with QHP, LP/QP-100 only.
74	Gear - pump driven	1	3892A4369	Used with QHP, LP/QP-100 only.
75	Shaft - pump idler	1	1199R3346	Used with QHP, LP/QP-100 only.
76, 79, 80, 81	Relief Valve pump cover assy.	1	A3266P510	Used with QHP, LP/QP-100 only.
77	Washer - pump cover	4	1229E1669	Used with QHP, LP/QP-100 only.
78	Capscrew - pump cover	2	S256-1	Used with QHP, LP/QP-100 only.
79	Ball-relief valve	1	1898E57	Used with QHP, LP/QP-100 only.
80	Spring-relief valve	1	2258A521	Used with QHP, LP/QP-100 only.
81	Plug-relief valve assy. with o-ring	1	A1199V3402	Used with QHP, LP/QP-100 only.
82	Adapter-filter	1	2297E2293	Used with QHP, LP/QP-100 only.
83	Washer-filter adapter	2	1229E1669	Used with QHP, LP/QP-100 only.
84	Capscrew-filter adapter	2	S2510-1	Used with QHP, LP/QP-100 only.

~ = Not serviced separately.

PARTS LISTED IN THIS CATALOG ARE NOT NECESSARILY MANUFACTURED BY THE ORIGINAL EQUIPMENT MANUFACTURER AND ANY REFERENCE TO THE TRADEMARKS OR PART NUMBERS OF OTHERS ARE FOR CROSS REFERENCE INFORMATIONAL PURPOSES ONLY. THE TRADEMARKS OF OTHERS REFERRED TO HEREIN ARE OWNED BY THEIR RESPECTIVE COMPANIES AND ARE NOT AFFILIATED IN ANY WAY WITH MIDWEST TRUCK & AUTO PARTS, INC.® MOTIVE GEAR® AND WORLD AMERICAN® ARE THE REGISTERED TRADEMARKS OF MIDWEST TRUCK & AUTO PARTS, INC.® USE OF THE ® IN CONNECTION WITH A MARK OF MIDWEST TRUCK & AUTO PARTS, INC.® INDICATES THAT THE MARK IS REGISTERED IN AT LEAST THE UNITED STATES. NO REPRESENTATION IS MADE WITH RESPECT TO THE SOURCE OF MANUFACTURE OF ANY PARTICULAR PART. © 2005, MIDWEST TRUCK & AUTO PARTS, INC.® ALL RIGHTS RESERVED.

# ROCKWELL®

## SL/SQ100, SQHP FRONT (Cont'd)

ITEM	DESCRIPTION	QTY	PART NO.	REMARKS
85	Filter-oil	1	3280V5040	Used with QHP, LP/QP-100 only.
86	Shield-oil filter	1	3280V6964	Used with QHP, LP/QP-100 only.
86A	Washer	4	1229E1669	Used with QHP, LP/QP-100 only.
87	Locknut-pump shield	2	NL25-1	
88	Stud-pump shield & pump cover	2	4X1707	
89	Cup - Input shaft rear bearing	1	JLM710910	
90	Cone - Input shaft rear bearing	1	JLM710949C	2234E1019 & JLM710949C available as A2234E1019 assy.
91	Differential side gear	1	2234E1019 MPS3344 MPS3345	2234E1019 & JLM710949C available as A2234E1019 assy. LD/QD-100 - Prior to 12/85 QHP, LP/QP-100 - Prior to 12/85
92A	Capscrew - Inter-axle diff.	8	S2524-1	Not shown. Available as KIT 1590
92B	Washer - Inter-axle diff.	16	1229E1669	Not shown. Available as KIT 1590
92C	Nut - Inter-axle diff.	8	NL25-1	Not shown. Available as KIT 1590
92D	Thread locking liquid/diff. case	1	2297C3747	.34 oz. tube - <b>SEE NOTE below.</b>
92A, 92B, 92C, 93, 94, 95, 96	Inter-axle diff. & nest assy. 2.00" - 39 Spline	1	A3235F1800	
92A, 92B, 92C, 93, 94 95, 96	Inter-axle diff. & nest assy. 2.10" - 41 Spline	1	A3-3235F1800 MPS3344 MPS3345	LD/QD-100 - 12/85 & Later QHP, LP/QP-100 - 12/85 & Later
96	Spider - Inter-axle diff. 2.00" - 39 Spline 2.10" - 41 Spline	1	3278H372 3278A1093	Effective 3/84. Effective 2/86 (welded inter-axle diff.)
97	Gear - helical drive	1	3892M4927 3892F4738	Effective 3/84 - Use with 1014-1015 shaft Effective 3/84 - Use with 110 shaft
98	Thrust Washer	1	1229H2764 1229M4069	Effective 3/84 - 2.25" I.D. Not interchangeable with 1229H2764, effective 2/86 Effective 2/86 (welded inter-axle diff.)
99, 99A 59, 60	Input Shaft	1	A1-3297A1015	QHP, LP/QP-100 only. 2.10" - 41 Spline with pump - Effective 12/85
99, 59, 60	Input Shaft 2.00" - 39 Spline 2.10" - 41 Spline Less Pump	1	A3297F110 A1-3297Z1014	LD/QD-100 only. Effective 3/84 LD/QD-100 only. Effective 2/86 (welded inter-axle diff.)
99A	Ball-Input shaft	1	1228K37	QHP, LP/QP-100 only. Not shown. Repl. 1898B70
100	Shift fork	1	A3296T150 3296E57 KIT 2268 KIT 2269	After 8/83 Old style - Prior to 8/83 QHP, LP/QP-100 - Prior to 8/83 LD/QD-100 - Prior to 8/83
101	Clutch collar - Input shaft	1	3280G5519	
102	Stop screw - push rod	1	S1812-1	
103	Locknut - stop screw	1	13X15	

### NOTE: THREAD LOCKING LIQUID/DIFFERENTIAL CASE HALVES

When assembling differential case halves in Rockwell International® axles, a thread locking adhesive should be used. The recommended procedure is as follows:

1. Wipe excess oil and residue from the threaded holes in the case. The holes should be relatively oil-free.
2. If **new bolts** are used, a yellow coating of Dri-Loc™ should appear on the threads. Assemble the case with these coated bolts to the required torque.
3. If the **original bolts** are reused or **regular bolts** without Dri-Loc™ are used, Rockwell® Part No. 2297C3747 should be used as a thread locking adhesive. **Apply the adhesive to the differential case holes only.** Thread the bolts and tighten to the required torque.

**IMPORTANT:** Do not apply Rockwell® Part No. 2297C3747 to Dri-Loc™ coated bolts. Refer to Rockwell® Service.

PARTS LISTED IN THIS CATALOG ARE NOT NECESSARILY MANUFACTURED BY THE ORIGINAL EQUIPMENT MANUFACTURER AND ANY REFERENCE TO THE TRADEMARKS OR PART NUMBERS OF OTHERS ARE FOR CROSS REFERENCE INFORMATIONAL PURPOSES ONLY. THE TRADEMARKS OF OTHERS REFERRED TO HEREIN ARE OWNED BY THEIR RESPECTIVE COMPANIES AND ARE NOT AFFILIATED IN ANY WAY WITH MIDWEST TRUCK & AUTO PARTS, INC.® MOTIVE GEAR® AND WORLD AMERICAN® ARE THE REGISTERED TRADEMARKS OF MIDWEST TRUCK & AUTO PARTS, INC.® USE OF THE ® IN CONNECTION WITH A MARK OF MIDWEST TRUCK & AUTO PARTS, INC.® INDICATES THAT THE MARK IS REGISTERED IN AT LEAST THE UNITED STATES. NO REPRESENTATION IS MADE WITH RESPECT TO THE SOURCE OF MANUFACTURE OF ANY PARTICULAR PART. © 2005, MIDWEST TRUCK & AUTO PARTS, INC.® ALL RIGHTS RESERVED.

# ROCKWELL®

## SL/SQ100 (2" - 39 SPLINE)

PART NUMBER	RATIO		AXLE
A39446-1	FAST	3.42	SL/SQ100 FRONT
A37278-2		3.55	
A37596-2		3.70	
A39170-1		3.73	
A38002-1		3.90	
A38836-1	MEDIUM	4.10	ALL QHP, QD/QP, LD/LP-100 FORWARD - REAR
A37404-1		4.33	
A37530-2		4.44	
A37540-2		4.63	
A37398-1	STANDARD	4.88	QRD RATIOS 3.42 TO 5.86
A37396-2		5.29	
A38824-1		5.86	
A38830-1		6.14	
A38240-1		6.83	
A38834-1		7.17	
A37258-2		7.80	

\* = Non-interchangeable. 3.70 or 3.73 ratios must be the same for both Forward-Rear and Rear-Rear axle ratios. (i.e. 3.73 Forward-Rear and 3.73 Rear-Rear).

\*\* = Available for SQ-100/P and SL-100/P only (with or without pump).

PARTS LISTED IN THIS CATALOG ARE NOT NECESSARILY MANUFACTURED BY THE ORIGINAL EQUIPMENT MANUFACTURER AND ANY REFERENCE TO THE TRADEMARKS OR PART NUMBERS OF OTHERS ARE FOR CROSS REFERENCE INFORMATIONAL PURPOSES ONLY. THE TRADEMARKS OF OTHERS REFERRED TO HEREIN ARE OWNED BY THEIR RESPECTIVE COMPANIES AND ARE NOT AFFILIATED IN ANY WAY WITH MIDWEST TRUCK & AUTO PARTS, INC.® MOTIVE GEAR® AND WORLD AMERICAN® ARE THE REGISTERED TRADEMARKS OF MIDWEST TRUCK & AUTO PARTS, INC.® USE OF THE ® IN CONNECTION WITH A MARK OF MIDWEST TRUCK & AUTO PARTS, INC.® INDICATES THAT THE MARK IS REGISTERED IN AT LEAST THE UNITED STATES. NO REPRESENTATION IS MADE WITH RESPECT TO THE SOURCE OF MANUFACTURE OF ANY PARTICULAR PART. © 2005, MIDWEST TRUCK & AUTO PARTS, INC.® ALL RIGHTS RESERVED.