

ROCKWELL®

SL/SQ100 REAR

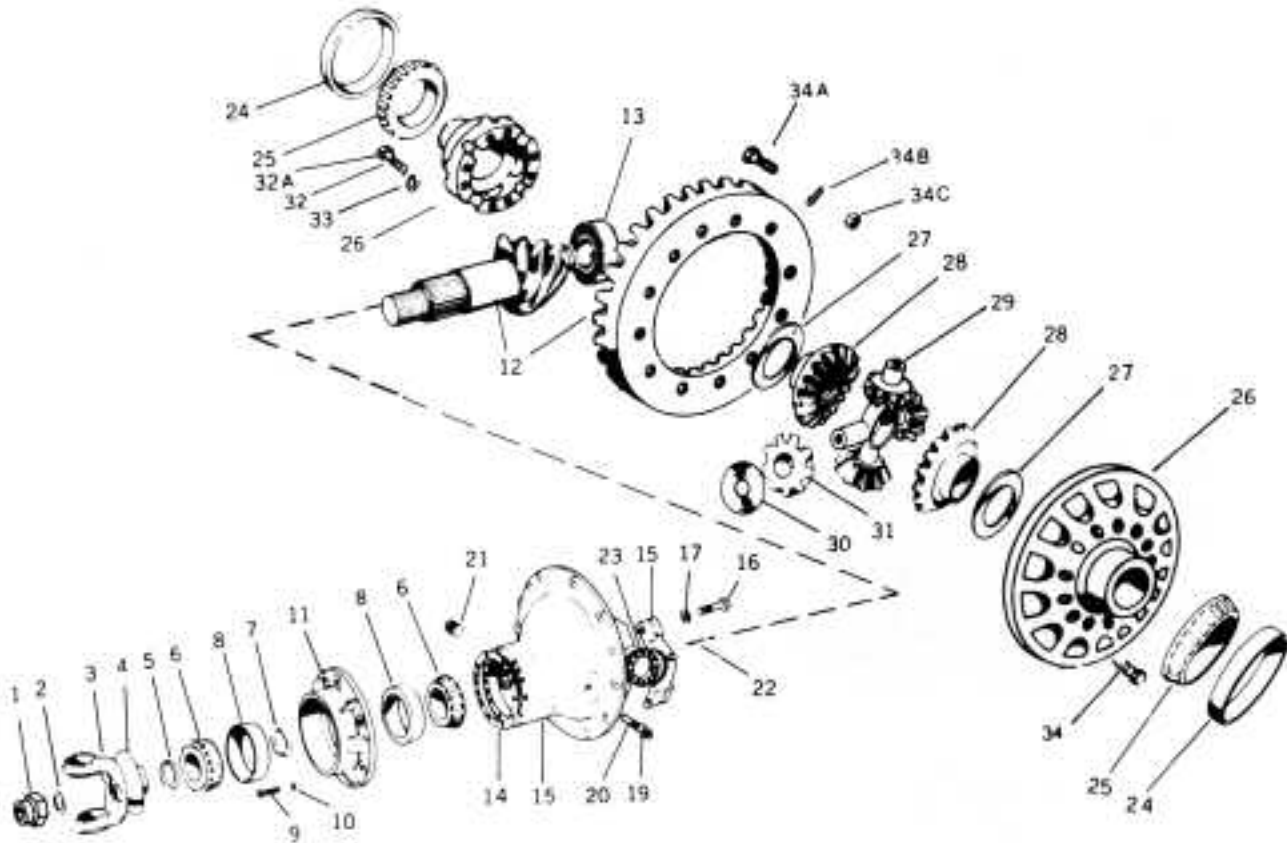

REAR-REAR DIFFERENTIAL CARRIER ASSEMBLY

PARTS LISTED IN THIS CATALOG ARE NOT NECESSARILY MANUFACTURED BY THE ORIGINAL EQUIPMENT MANUFACTURER AND ANY REFERENCE TO THE TRADEMARKS OR PART NUMBERS OF OTHERS ARE FOR CROSS REFERENCE INFORMATIONAL PURPOSES ONLY. THE TRADEMARKS OF OTHERS REFERRED TO HEREIN ARE OWNED BY THEIR RESPECTIVE COMPANIES AND ARE NOT AFFILIATED IN ANY WAY WITH MIDWEST TRUCK & AUTO PARTS, INC.® MOTIVE GEAR® AND WORLD AMERICAN® ARE THE REGISTERED TRADEMARKS OF MIDWEST TRUCK & AUTO PARTS, INC.® USE OF THE ® IN CONNECTION WITH A MARK OF MIDWEST TRUCK & AUTO PARTS, INC.® INDICATES THAT THE MARK IS REGISTERED IN AT LEAST THE UNITED STATES. NO REPRESENTATION IS MADE WITH RESPECT TO THE SOURCE OF MANUFACTURE OF ANY PARTICULAR PART. © 2005, MIDWEST TRUCK & AUTO PARTS, INC.® ALL RIGHTS RESERVED.

ROCKWELL®

SL/SQ100 REAR

ITEM	DESCRIPTION	QTY	PART NO.	REMARKS
	Bearing, Seal & Gasket Kit		RA194RBR	
1	Nut - yoke input	1	1227R902	
2	Washer - yoke input	1	1229T1736	
3, 4	Companion yoke & slinger assembly	1		CALL YOUR SALES REP
4	Deflector - yoke input	1	2297N3888	
5	Oil seal assembly	1	3905 4562V	Pre 8/83 Triple lip seal
6	Cone - Inner & outer bearing input	2	72212C	
7	Spacer - bearing cone	As req.		CALL YOUR SALES REP
8	Cup - Inner & outer bearing input	2	72487	
9	Capscrew - forward bearing cage	8	S2812-2	
10	Washer - forward bearing cup	8	1229C1511	
11, 8	Bearing cup & cage assy.	1	A3226Z806	
12~	* Drive gear & pinion assembly	1	See Page 123	
13	Bearing-spigot drive pinion	1	RU1570UM	
14	Shim - forward bearing cage	As req.	.003 .005 .010 2203C8115 2203D8116 2203E8117	
15, 15A, 16 17, 18	Differential carrier & cap assy. Use with KIT 533 (Silastic)	1	A2-3200N1314 A2-3200T1346	Aluminum carrier
15A	Adhesive - bearing cup	1	2297T4180	Not shown, 2-.5 cc tubes
16	Capscrew - differential bearing cap	4	S21238-1	
17	Washer - differential bearing cap	4	1229V1556	
18~	Dowel - differential bearing cap	2	See Item 15	Not shown
19	Locknut - thrust screw	1	13X41	
20	Screw - thrust drive gear	1	15X1025	
21	Plug-oil fill & inspection	1	P212	
22	Cotter pin-adjusting ring	2	1199R2176	
23	Adjusting ring - differential bearing	2	2214Z208	
24	Cup - bearing differential	2	JM716610	
25	Cone - bearing differential	2	JM716649	
26~, 26A~, 26,28,29,30, 31, 32, 33	* Differential case & nest assy.	1	QR-100 LR-100 QRR-100 A18-3235D1174 A34-3235D1174 A44-3235D1174	Standard ratios
26~, 26A~, 32, 33	* Differential case assy.	1	A28-3235D1174	
26~, 26A~, 26,28,29,30, 31, 32, 33	* Differential case & nest assy.	1	QR-100 LR-100 QRR-100 A17-3235L1156 A43-3235L1156 A51-3235L1156	Medium ratios
26~, 26A~, 32, 33	* Differential case assy.	1	A26-3235L1156	Medium ratio
26~, 26A~, 26,28,29,30, 31, 32, 33	* Differential case & nest assy.	1	QR-100 LR-100 QRR-100 A13-3235C1173 A33-3235C1173 A43-3235C1173	Fast ratios
26~, 26A~, 32, 33	* Differential case assy.	1	A19-3235C1173	Fast ratio
27	Washer - thrust-side gear	2	1229T1034	
28	Side gear - diff.	2	QR-100 LR-100 QRR-100 2234C783 2234D966 2234F1046	2.10" - 41 Spline 2.00" - 39 Spline 2.10" - 41 Spline
29	Spider - differential	1	3278S305	
30	Washer - thrust differential pinion	4	1229R1032	
31	Pinion - differential	4	QR/LR-100 QRR-100 2233U151 2233J1024	
32	Capscrew - diff. case	16	S2826P-1	Available in KIT 2467
32A	Thread locking liquid/differential case	1	2297C3747	.34 oz. tube - SEE NOTE.
33	Washer - differential case	16	1229C1511	
34	Rivet-diff. case to gear (opt.)	12	RV71013	
34A	Bolt-differential case to gear	12	QR-100, LR-100 QRR-100 15X1523 15X1626	Available as KIT 570. (SQR use KIT 2306)
34B	Washer - differential case to gear	12	1229U1503	
34C	Nut - differential case to gear	12	NL110-1	

~ = Not serviced separately.

* = Specify ratios. When changing ratios from standard to medium or fast, you must change differential cases.

PARTS LISTED IN THIS CATALOG ARE NOT NECESSARILY MANUFACTURED BY THE ORIGINAL EQUIPMENT MANUFACTURER AND ANY REFERENCE TO THE TRADEMARKS OR PART NUMBERS OF OTHERS ARE FOR CROSS REFERENCE INFORMATIONAL PURPOSES ONLY. THE TRADEMARKS OF OTHERS REFERRED TO HEREIN ARE OWNED BY THEIR RESPECTIVE COMPANIES AND ARE NOT AFFILIATED IN ANY WAY WITH MIDWEST TRUCK & AUTO PARTS, INC.® MOTIVE GEAR® AND WORLD AMERICAN® ARE THE REGISTERED TRADEMARKS OF MIDWEST TRUCK & AUTO PARTS, INC.® USE OF THE ® IN CONNECTION WITH A MARK OF MIDWEST TRUCK & AUTO PARTS, INC.® INDICATES THAT THE MARK IS REGISTERED IN AT LEAST THE UNITED STATES. NO REPRESENTATION IS MADE WITH RESPECT TO THE SOURCE OF MANUFACTURE OF ANY PARTICULAR PART. © 2005, MIDWEST TRUCK & AUTO PARTS, INC.® ALL RIGHTS RESERVED.

ROCKWELL®

SL/SQ-100 (Cont'd)

NOTE: THREAD LOCKING LIQUID/DIFFERENTIAL CASE HALVES

When assembling differential case halves in Rockwell International® axles, a thread locking adhesive should be used. The recommended procedure is as follows:

1. Wipe excess oil and residue from the threaded holes in the case. The holes should be relatively oil-free.
2. If **new bolts** are used, a yellow coating of Dri-Loc™ should appear on the threads. Assemble the case with these coated bolts to the required torque.
3. If the **original bolts** are reused or **regular bolts** without Dri-Loc™ are used, Rockwell® Part No. 2297C3747 should be used as a thread locking adhesive. **Apply the adhesive to the differential case holes only.** Thread the bolts and tighten to the required torque.

IMPORTANT: Do not apply Rockwell® Part No. 2297C3747 to Dri-Loc™ coated bolts. Refer to Rockwell® Service.

SL/SQ-100 (2" 39 SPLINE)

PART NUMBER	RATIO		AXLE	
A39424-1 **	FAST	3.42	SL/SQ-100 REAR	
A37326-1		3.55		
A38512-1 *		3.70 *		
A39168-1		3.73 *		
A38520-1		3.90		
A38730-1	MEDIUM	4.10	LR/QR-100P REAR-REAR	
A37382-1		4.33		
A37564-1		4.44		
A37566-1		4.63		
A37392-1	STANDARD	4.88		QRR RATIOS 3.42 TO 5.86
A37376-1		5.29		
A38822-1		5.86		
A38828-1		6.14		
A38526-1		6.83		
A38832-1		7.17		
A37306-2		7.80		

* = Non-interchangeable. 3.70 or 3.73 ratios must be the same for both Forward-Rear and Rear-Rear axle ratios. (i.e. 3.73 Forward-Rear and 3.73 Rear-Rear).

** = Available for SQ-100/P and SL-100/P only (with or without pump).

PARTS LISTED IN THIS CATALOG ARE NOT NECESSARILY MANUFACTURED BY THE ORIGINAL EQUIPMENT MANUFACTURER AND ANY REFERENCE TO THE TRADEMARKS OR PART NUMBERS OF OTHERS ARE FOR CROSS REFERENCE INFORMATIONAL PURPOSES ONLY. THE TRADEMARKS OF OTHERS REFERRED TO HEREIN ARE OWNED BY THEIR RESPECTIVE COMPANIES AND ARE NOT AFFILIATED IN ANY WAY WITH MIDWEST TRUCK & AUTO PARTS, INC.® MOTIVE GEAR® AND WORLD AMERICAN® ARE THE REGISTERED TRADEMARKS OF MIDWEST TRUCK & AUTO PARTS, INC.® USE OF THE ® IN CONNECTION WITH A MARK OF MIDWEST TRUCK & AUTO PARTS, INC.® INDICATES THAT THE MARK IS REGISTERED IN AT LEAST THE UNITED STATES. NO REPRESENTATION IS MADE WITH RESPECT TO THE SOURCE OF MANUFACTURE OF ANY PARTICULAR PART. © 2005, MIDWEST TRUCK & AUTO PARTS, INC.® ALL RIGHTS RESERVED.