

# ROCKWELL®

## SL/SQHD FORWARD-REAR

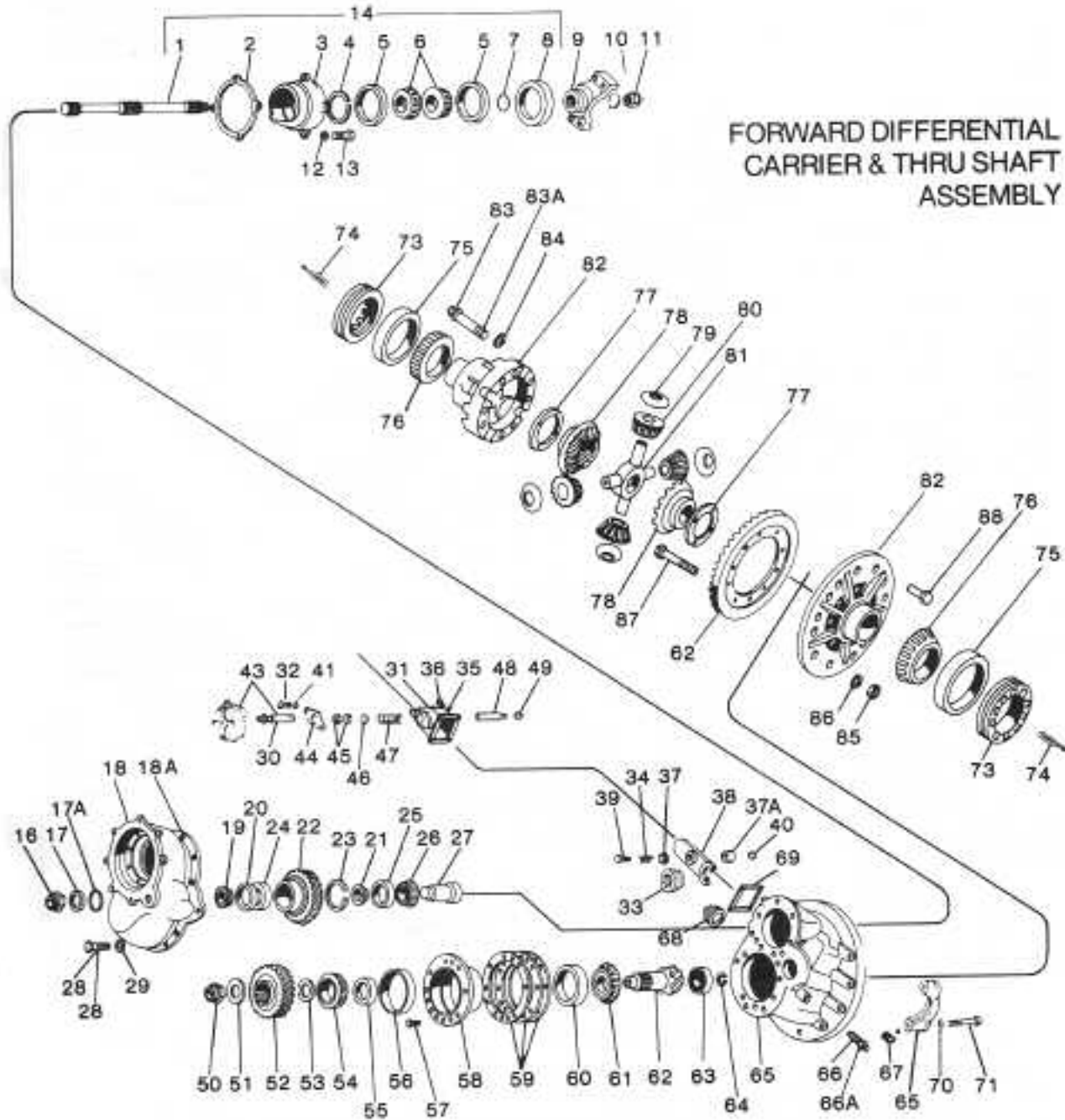

PARTS LISTED IN THIS CATALOG ARE NOT NECESSARILY MANUFACTURED BY THE ORIGINAL EQUIPMENT MANUFACTURER AND ANY REFERENCE TO THE TRADEMARKS OR PART NUMBERS OF OTHERS ARE FOR CROSS REFERENCE INFORMATIONAL PURPOSES ONLY. THE TRADEMARKS OF OTHERS REFERRED TO HEREIN ARE OWNED BY THEIR RESPECTIVE COMPANIES AND ARE NOT AFFILIATED IN ANY WAY WITH MIDWEST TRUCK & AUTO PARTS, INC.® MOTIVE GEAR® AND WORLD AMERICAN® ARE THE REGISTERED TRADEMARKS OF MIDWEST TRUCK & AUTO PARTS, INC.® USE OF THE ® IN CONNECTION WITH A MARK OF MIDWEST TRUCK & AUTO PARTS, INC.® INDICATES THAT THE MARK IS REGISTERED IN AT LEAST THE UNITED STATES. NO REPRESENTATION IS MADE WITH RESPECT TO THE SOURCE OF MANUFACTURE OF ANY PARTICULAR PART. © 2005, MIDWEST TRUCK & AUTO PARTS, INC.® ALL RIGHTS RESERVED.

# ROCKWELL®

## SL/SQHD FORWARD-REAR

ITEM	DESCRIPTION	QTY	PART NO.	REMARKS
	<b>Bearing, Seal &amp; Gasket Kit</b>		RA900FR	
1	Thru Shaft	1	A3880K921	Includes Item 11
2	Gasket	1	2208C445	
3, 5	Rear Bearing Cage & Cup Assy	1	A3226Q537	
1, 3, 4, 5, 6, 7, 8, 12	Rear Bearing Cage, oil seal, thru shaft, bearing & snap ring assy	1	A1-3226Q537	
4	Snap Ring - Thru Shaft	As req.		<b>CALL YOUR SALES REP</b>
5	Bearing Cup	2	LM603011	
6	Bearing Cone	2	LM603049	
7	Snap Ring - Thru Shaft	1	1829A859	
8	Oil Seal Assy - Thru Shaft	1	475322N	
9	Yoke Assy - Thru Shaft (Output)	1		<b>CALL YOUR SALES REP</b>
10	Washer - Thru Shaft	1	1229A2653	
11	Nut - Thru Shaft	1	1227Z936	
12	Washer - Thru Shaft Cage	4	1229K1597	
13	Capscrew - Thru Shaft Cage	4	S268-2	
14	KIT (pre-assembled)	1	<b>USE MPS 1842</b>	
16	Nut - Idler Gear Shaft	1	1227Z936	
17	Washer - Idler Gear Shaft	1	1229A2653	
17A	"O" Ring - Idler Gear Shaft	1	2208U463	
18	Case - Adapter (case only)	1	3280Y3977	
16, 17, 17A, 18, 20, 22, 23, 24, 25	Adapter Case & Idler Gear Assy	1	A3280Y3977	
18A	Gasket - Adapter Case (Silastic)	3 oz.	1199T3842	
19	Front Bearing Cone	1	31597	
20	Front Bearing Cup	1	31520	
21	Spacers - Front Bearing	As req.		<b>CALL YOUR SALES REP</b>
19, 20, 21, 22, 23, 24, 25	Idler Gear, bearing & spacer assy.	1	A1-3892D1824	
20, 22, 23, 24, 25	Idler Gear, bearing cup, spacer & ring assy.	1	A3892D1824	
23	Snap Ring - Idler Gear Bearing	1	1229N1470	
24	Spacer - Idler Gear Bearing	1	1244X726	
25	Rear Bearing Cup	1	31520	
26	Rear Bearing Cone	1	31597	
27	Shaft - Idler Gear	1	3280P2226	
28	Capscrew (Long)	2	SP1035	
	adapter case (Short)	8	S2812-2	Aluminum carriers
	(Short)	8	S2811-2	Malleable carriers
29	Washer - Adapter Case	10	1229C1511	
30~	Shift Shaft - Inter-axle	1	2297N768	<b>Part of Item 43</b>
31	Housing - Shift Shaft	1	3280D2526	
32	Capscrew - Shift Shaft Hsg. Mtg.	2	S268-2	
33	Collar - Shift Lock	1	3280X2520	
34	Spring - Shift Fork	1	2258G397	
35	Washer - Shift Hsg. Mtg.	4	WA-16	
36	Capscrew - Shift Hsg. Mtg.	4	S268-2	
37	Washer - Shift Fork Seat	1	1229M1599	
37A	Ball - Shift Fork Lock	1	1199V1712	
38	Shift Fork Assy.	1	A2297E811	
39	Bolt - Shift Fork	1	15X1306	
40	Nut - Shift Fork	1	NL-16-1	
41	Washer - Shift Shaft Chamber Mtg.	2	1229B1666	
30~, 41	Shift Chamber & Hsg. Assy. (complete)	1	A1-3280D2526	
43, 30~	Air Chamber & Shift Shaft Assy.	1	A3261C289	
44	Gasket - Shift Shaft Housing	1	2208M429	

~ = Not serviced separately.

PARTS LISTED IN THIS CATALOG ARE NOT NECESSARILY MANUFACTURED BY THE ORIGINAL EQUIPMENT MANUFACTURER AND ANY REFERENCE TO THE TRADEMARKS OR PART NUMBERS OF OTHERS ARE FOR CROSS REFERENCE INFORMATIONAL PURPOSES ONLY. THE TRADEMARKS OF OTHERS REFERRED TO HEREIN ARE OWNED BY THEIR RESPECTIVE COMPANIES AND ARE NOT AFFILIATED IN ANY WAY WITH MIDWEST TRUCK & AUTO PARTS, INC.® MOTIVE GEAR® AND WORLD AMERICAN® ARE THE REGISTERED TRADEMARKS OF MIDWEST TRUCK & AUTO PARTS, INC.® USE OF THE ® IN CONNECTION WITH A MARK OF MIDWEST TRUCK & AUTO PARTS, INC.® INDICATES THAT THE MARK IS REGISTERED IN AT LEAST THE UNITED STATES. NO REPRESENTATION IS MADE WITH RESPECT TO THE SOURCE OF MANUFACTURE OF ANY PARTICULAR PART. © 2005, MIDWEST TRUCK & AUTO PARTS, INC.® ALL RIGHTS RESERVED.

# ROCKWELL®

## SL/SQHD FORWARD-REAR (Cont'd)

ITEM	DESCRIPTION	QTY	PART NO.	REMARKS
45	Snap Ring - Shift Shaft	2	1229W1245	
46	Washer - Shift Shaft	1	1229R798	
47	Spring - Shift Chamber	1	2258U411	
48	Adjusting Bolt - Shift Chamber	1	15X851	
49	Nut - Shift Chamber Adjusting Bolt	1	13X163	
50	Nut-Drive Pinion	1	1227N898	
51	Washer - Drive Pinion Nut	1	1229N1730	
52, 50	Driven drop box gear & drive pinion nut assy.	1	A3892S4517 3892C4735 ^^	USED IN KIT 349 USED IN KIT 2117
53	Spacer-pinion bearing	1	1229S1449	Use with these ratios only: 3.55, 3.70, 3.90, 4.11, 4.33, 4.44, 4.63, 5.29, 5.83
54	Cone - Outer Bearing	1	72200C	
55	Spacer - Forward Bearing	As req.		<b>CALL YOUR SALES REP</b>
56	Cup - Outer Bearing	1	72487	
57	Capscrew - Pinion Bearing Cage	8	10X1027	Malleable carriers
		8	10X1028	Aluminum carriers
58	Drive Pinion Cage & Cup Assy.	1	A3226A131	
59	Shim	1	2203L7448	
	.003	3	2203K7447	
	.010	4	2203J7446	
	Shim	1	2203T8366	Use with these ratios only: 4.88, 6.17, 6.83, 7.20, 7.80, 8.60
60	Cup - Inner Bearing	1	72487	
61	Cone - Inner Bearing	1	72200C	
62~	Drive Gear & Pinion Assy.	1	<b>See Page 105</b>	
63	Bearing - Drive Pinion Rear	1	RU1570UM	
64	Lock Ring - Drive Pinion	1	1229A1301	
65~, 70, 71	Differential Carrier & Cap Assy.	1	A2-3200T800 A3-3200U801	Malleable Aluminum
66	Thrust Screw - Drive Gear	1	15X1025	
66A	Nut - Thrust Screw - Drive Gear	1	13X41	
67	Plug - Oil Inspection	1	1850T150	
68	Plug - Oil Filler Hole	1	P212	
69	Gasket - Shift Housing	1	2208D446	
70	Washer - Bearing Cap	4	1229V1556	
71	Capscrew - Bearing Cap	4	S21238-1	Malleable carriers
		4	10X1021	Aluminum carriers
77, 78, 79, 80, 81, 82~, 83, 84	Differential Case & Nest Assy.	1	B11-3235U619 #	Standard ratio
		1	A87-3235V620 #	Fast ratio
		1	B5-3235U619 ##	Standard ratio
		1	A84-3235V620 ##	Fast ratio
82~, 83, 84	Differential Case Assy.	1	B3-3235U619	Standard ratio
		1	A83-3235V620	Fast ratio
73	Adjusting Ring - Diff. Bearing	2	2214G215	
74	Cotter Pin Lock-Adjusting Ring	2	1199R2176	
75	Differential Bearing Cup	2	493	
76	Bearing - Cone	2	496	Standard ratio
		1	497	Fast ratio
77	Thrust Washer - Side Gear	2	1229T1034	
78	Side Gear Differential	2	2234X310 #	(2" - 21 Spline)
		2	2234X700 ##	(2-1/8" - 22 Spline)
79	Thrust Washer - Pinion	4	1229R1032	
80	Pinion - Differential	4	2233U151	
81	Spider - Differential	1	3278S305	

~ = Not serviced separately.

^^ = New gear - not interchangeable with A3892S4517 gear.

# = SLHD Only

## = SQHD Only

PARTS LISTED IN THIS CATALOG ARE NOT NECESSARILY MANUFACTURED BY THE ORIGINAL EQUIPMENT MANUFACTURER AND ANY REFERENCE TO THE TRADEMARKS OR PART NUMBERS OF OTHERS ARE FOR CROSS REFERENCE INFORMATIONAL PURPOSES ONLY. THE TRADEMARKS OF OTHERS REFERRED TO HEREIN ARE OWNED BY THEIR RESPECTIVE COMPANIES AND ARE NOT AFFILIATED IN ANY WAY WITH MIDWEST TRUCK & AUTO PARTS, INC.® MOTIVE GEAR® AND WORLD AMERICAN® ARE THE REGISTERED TRADEMARKS OF MIDWEST TRUCK & AUTO PARTS, INC.® USE OF THE ® IN CONNECTION WITH A MARK OF MIDWEST TRUCK & AUTO PARTS, INC.® INDICATES THAT THE MARK IS REGISTERED IN AT LEAST THE UNITED STATES. NO REPRESENTATION IS MADE WITH RESPECT TO THE SOURCE OF MANUFACTURE OF ANY PARTICULAR PART. © 2005, MIDWEST TRUCK & AUTO PARTS, INC.® ALL RIGHTS RESERVED.

# ROCKWELL®

## SL/SQHD FORWARD-REAR (Cont'd)

ITEM	DESCRIPTION	QTY	PART NO.	REMARKS
83	Bolt - Differential Case	16	S2826P-1	
84	Washer - Differential case	16	1229C1511	
85	Nut - Gear to case	12	NL110-1	USED IN KIT 570
86	Washer - Gear to case	12	1229U1503	
87	Bolt - Gear to case (bolted version)	12	15X1523	
88	Rivet - Gear to case (riveted version)	12	RV71013	
89	Nut - Input Yoke	1	1227J946	1-1/2" X 12 Course Thread
90	Yoke - Input Shaft	1		<b>CALL YOUR SALES REP</b>
91	Oil Seal Assy.	1	4563V	
92	Snap Ring	1	1229P1446	
93	Bearing - Front radial ball	1	211B	
94	Capscrew - Inter-axle housing	8	S2711-1	
95	Washer - Inter-axle housing	8	1229E1513	
96	Plug - Oil Filter	1	P212	
96A	Plug - Oil Drain	1	1850T150	
97	Housing - Inter-axle differential	1	3280V2518	Malleable carriers
		1	3280Y2573	Aluminum carriers
97A	Gasket - Inter-axle diff. housing (Silastic)	3 oz.	1199T3842	
91, 92, 93, 97	Housing Assy. Inter-axle diff.	1	A3280V2518	Malleable carriers
91, 92, 93, 97	Housing Assy. Inter-axle diff.	1	A3280Y2573	Aluminum case
98	Capscrew - Inter-axle diff. case	8	S2824A-1	
98A	Thread locking liquid/diff. case	1	2297C3747	34 oz. tube - <b>SEE NOTE BELOW.</b>
99	Spacer - Bearing	1	1244Y701	
89, 100, 110	Inter-axle diff. case assy.	1	A2-3235T1528	
89, 98, 100~, 101, 102, 103, 104, 105, 106, 107, 110	Inter-axle diff. case & nest assy. (Complete)	1	A1-3235T1528	
101	Thrust Washer - Forward side gear	1	1229J1622	
102	Side gear - forward	1	2234M325	
103	Side gear - rear	1	2234B340	
104	Spider - differential	1	3278M91	Available as KIT 2356
105	Pinion - differential	4	2233A105	
106	Thrust Washer - pinion	4	1229Q2877	
107	Thrust Washer - rear side gear	1	1229G1619	
108	Capscrew - Bearing Cage	6	S267-1	
109~	Cage - Bearing	1	3226F708	
109, 112	Cage & Cup Assy - Bearing	1	A3226F708	
110	Bushing - Bearing Cage	1	1225V880	Bronze
111	Shim - Bearing Cage	4	2203R3008	
		1	2203S3009	
112	Cup - front bearing	1	29630	
113	Cone - front bearing	1	29675	
114	Drive Gear - Inter-axle	1	3892P2044	
115	Cone - rear bearing	1	29675	
116	Cup - rear bearing	1	29630	

~ = Not serviced separately.

### NOTE: THREAD LOCKING LIQUID/DIFFERENTIAL CASE HALVES

When assembling differential case halves in Rockwell International® axles, a thread locking adhesive should be used. The recommended procedure is as follows:

1. Wipe excess oil and residue from the threaded holes in the case. The holes should be relatively oil-free.
2. If **new bolts** are used, a yellow coating of Dri-Loc™ should appear on the threads. Assemble the case with these coated bolts to the required torque.
3. If the **original** bolts are reused or **regular bolts** without Dri-Loc™ are used, Rockwell® Part No. 2297C3747 should be used as a thread locking adhesive. **Apply the adhesive to the differential case holes only.** Thread the bolts and tighten to the required torque.

**IMPORTANT:** Do not apply Rockwell® Part No. 2297C3747 to Dri-Loc™ coated bolts. Refer to Rockwell® Service.

PARTS LISTED IN THIS CATALOG ARE NOT NECESSARILY MANUFACTURED BY THE ORIGINAL EQUIPMENT MANUFACTURER AND ANY REFERENCE TO THE TRADEMARKS OR PART NUMBERS OF OTHERS ARE FOR CROSS REFERENCE INFORMATIONAL PURPOSES ONLY. THE TRADEMARKS OF OTHERS REFERRED TO HEREIN ARE OWNED BY THEIR RESPECTIVE COMPANIES AND ARE NOT AFFILIATED IN ANY WAY WITH MIDWEST TRUCK & AUTO PARTS, INC.® MOTIVE GEAR® AND WORLD AMERICAN® ARE THE REGISTERED TRADEMARKS OF MIDWEST TRUCK & AUTO PARTS, INC.® USE OF THE ® IN CONNECTION WITH A MARK OF MIDWEST TRUCK & AUTO PARTS, INC.® INDICATES THAT THE MARK IS REGISTERED IN AT LEAST THE UNITED STATES. NO REPRESENTATION IS MADE WITH RESPECT TO THE SOURCE OF MANUFACTURE OF ANY PARTICULAR PART. © 2005, MIDWEST TRUCK & AUTO PARTS, INC.® ALL RIGHTS RESERVED.

# ROCKWELL®

## SL/SQHD FORWARD-REAR CARRIER WITH 2" - 39 SPLINE

<u>DRIVE GEAR &amp; PINION ASSY</u>	<u>DRIVE GEAR, PINION &amp; HELICAL GEAR ASSY</u>	<u>RATIO</u>	<u>REMARKS</u>
A36028-20	A36028-21	3.55	FAST RATIOS
A37588-12	A37588-13	3.70	
A38006-9	A38006-10	3.90	Use Differential Case
A35818-23	A35818-24	4.11	Assembly
A36722-12	A36722-13	4.33	A83-3235V620
A35816-19	A35816-20	4.44	
A35814-16	A35814-17	4.63	
A36446-15	A36446-16	4.88	STANDARD RATIOS
A35812-20	A35812-21	5.29	
A35810-19	A35810-20	5.83	Use Differential Case
A35808-18	A35808-23	6.17	Assembly
A35806-21	A35806-22	6.83	B3-3235U619
A35804-18	A35804-23	7.20	
A35802-17	A35802-18	7.80	
A35800-17	A35800-18	8.60	

PARTS LISTED IN THIS CATALOG ARE NOT NECESSARILY MANUFACTURED BY THE ORIGINAL EQUIPMENT MANUFACTURER AND ANY REFERENCE TO THE TRADEMARKS OR PART NUMBERS OF OTHERS ARE FOR CROSS REFERENCE INFORMATIONAL PURPOSES ONLY. THE TRADEMARKS OF OTHERS REFERRED TO HEREIN ARE OWNED BY THEIR RESPECTIVE COMPANIES AND ARE NOT AFFILIATED IN ANY WAY WITH MIDWEST TRUCK & AUTO PARTS, INC.® MOTIVE GEAR® AND WORLD AMERICAN® ARE THE REGISTERED TRADEMARKS OF MIDWEST TRUCK & AUTO PARTS, INC.® USE OF THE ® IN CONNECTION WITH A MARK OF MIDWEST TRUCK & AUTO PARTS, INC.® INDICATES THAT THE MARK IS REGISTERED IN AT LEAST THE UNITED STATES. NO REPRESENTATION IS MADE WITH RESPECT TO THE SOURCE OF MANUFACTURE OF ANY PARTICULAR PART. © 2005, MIDWEST TRUCK & AUTO PARTS, INC.® ALL RIGHTS RESERVED.