

ROCKWELL®

SSHD FRONT

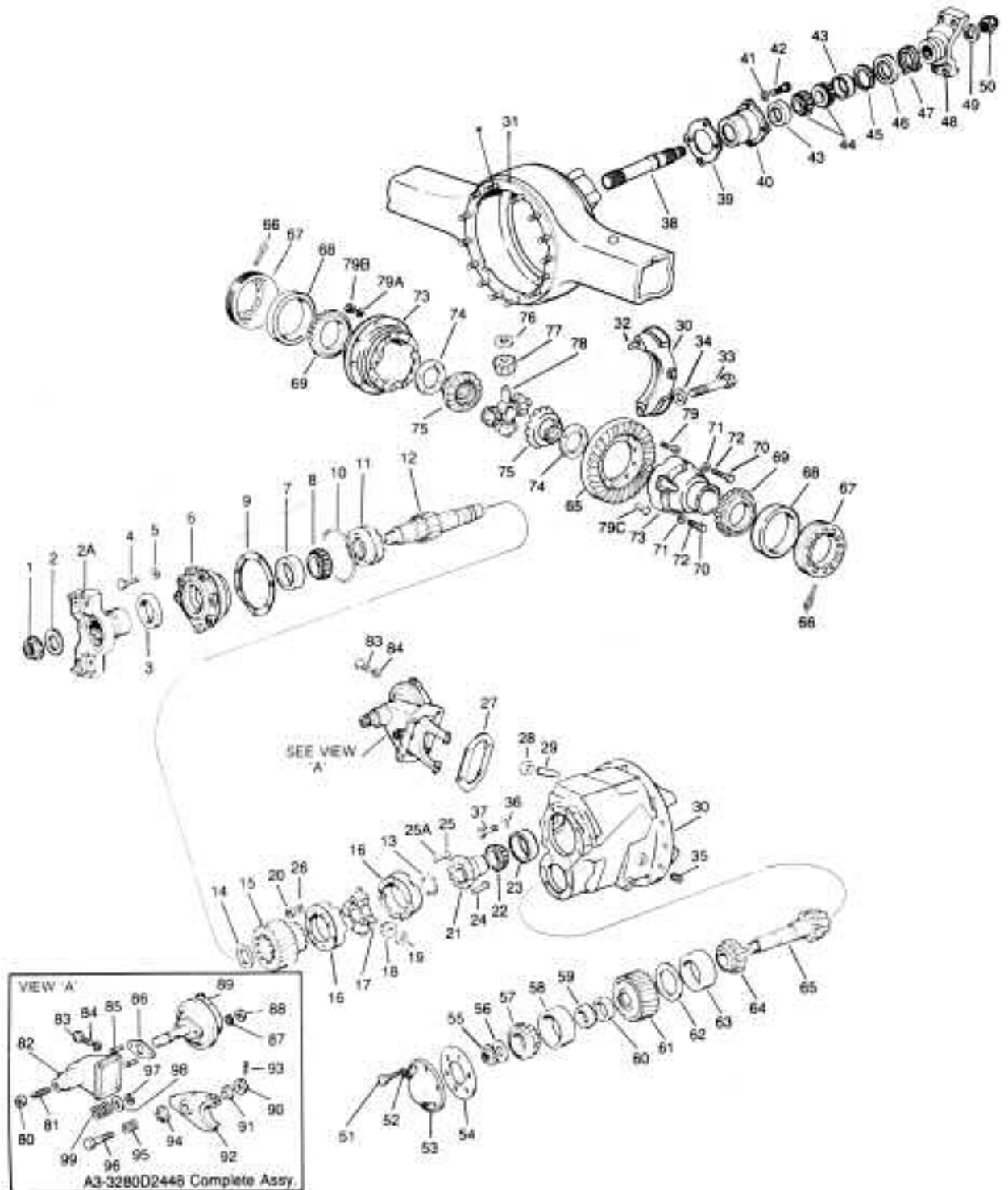

PARTS LISTED IN THIS CATALOG ARE NOT NECESSARILY MANUFACTURED BY THE ORIGINAL EQUIPMENT MANUFACTURER AND ANY REFERENCE TO THE TRADEMARKS OR PART NUMBERS OF OTHERS ARE FOR CROSS REFERENCE INFORMATIONAL PURPOSES ONLY. THE TRADEMARKS OF OTHERS REFERRED TO HEREIN ARE OWNED BY THEIR RESPECTIVE COMPANIES AND ARE NOT AFFILIATED IN ANY WAY WITH MIDWEST TRUCK & AUTO PARTS, INC.® MOTIVE GEAR® AND WORLD AMERICAN® ARE THE REGISTERED TRADEMARKS OF MIDWEST TRUCK & AUTO PARTS, INC.® USE OF THE ® IN CONNECTION WITH A MARK OF MIDWEST TRUCK & AUTO PARTS, INC.® INDICATES THAT THE MARK IS REGISTERED IN AT LEAST THE UNITED STATES. NO REPRESENTATION IS MADE WITH RESPECT TO THE SOURCE OF MANUFACTURE OF ANY PARTICULAR PART. © 2005, MIDWEST TRUCK & AUTO PARTS, INC.® ALL RIGHTS RESERVED.

ROCKWELL®

SSHD FRONT

ITEM	DESCRIPTION	QTY	CARRIER	CARRIER	CARRIER	REMARKS
			3200-M-585 PART NUMBER DATE 1/74	3200-R-1162 PART NUMBER DATE 1/76	3200-P-1420 PART NUMBER DATE 1/83	
	Bearing, Seal & Gasket Kit		RA172FR	RA172FAR	RA172FBR	
1	Nut - input shaft	1	1227D940	1227D940	1227D940	
2	Washer - input shaft nut	1		1229S1605	1229S1605	
2A	Yoke/flange-input shaft	1				CALL YOUR SALES REP
3	Oil seal-input shaft bearing cage	1	417487	416470N	100494	
4	Capscrew-input shaft bearing case	7	S2712-2	S2712-2	S2712-2	
5	Washer-inut shaft bearing cage	7	1229E1513	1229E1513	1229E1513	
6, 7	Bearing cage assy. - input shaft	7	3226M351	KIT 2427	KIT 2427	
7	Bearing cup-input shaft bearing cage	1	313 (Ball bearing assy.)	JH211710	JH211710	
8	Bearing cone-input shaft brg. cage	1		JH211749	JH211749	
9	Shim-input bearing cage	3 2 1	2203G4089 2203H4090	2203Q6803 2203R6804 2203S6805	2203Q6803 2203R6804 2203S6805	
10	O-ring input shaft bearing	1	5X591	5X591	5X591	
11	Clutch collar	1	MPS2259	KIT 2427	KIT 2427	
1, 12, 13	Input shaft assy.	1	A1-3280S5609	KIT 2498	KIT 2498	
13	Retainer - Input shaft (snap ring)	1	1229R1604 ^ 1229L4354 ^^	1229V2570 ^ 1229L4354 ^^	1229V2570 ^ 1229L4354 ^^	Used before 7/24/89 Used after 7/24/89
14	Thrust washer - input shaft gear	1	1229M2769R	1229M2769R	1229M2769R	
15	Gear - input drive	1	3892F1826	3892F1826	3892F1826	
16~, 20, 25, 26	Case assy., - Inter-axle diff.	1	A3235W751	A1-3235G1801	A1-3235G1801	
16~ thru 19, 20, 25, 26	Case & nest assy. Inter-axle diff.	1	Must purchase A3235W751 & Items 17, 18, 19, 20 and 21A separately	A2-3235F1800	A2-3235F1800	
17	Spider - Inter-axle diff.	1	3278Y129	3278V1088	3278V1088	
18	Pinion - Inter-axle diff.	4	2233W153	2233W153	2233W153	
19	Thrust washer - Inter-axle diff. pinion	4	1229T1606	1229T1606	1229T1606	
20	Nut - Inter-axle diff. case bolt	8		NL27-1	NL27-1	SEE KIT 389
21	Side gear - Inter-axle diff.	1	2234F604	2234M793	2234M793	
21A	Washer - side gear - Inter-axle diff.	1	1229N1600			Not shown.
22	Bearing cone - Inter-axle diff. rear	1	MU1015DCV (Ball bearing assy.)	JLM714149	JLM714149	
23	Bearing cup - Inter-axle diff. rear	1		JLM714110	JLM714110	
24	Rivet - Inter-axle diff. case	8		17X234	17X234	
25	Bolt - Inter-axle diff. case	8	S2722A-1	S2726-1	S2726-1	*SEE KIT 389
25A	Thread locking liquid/diff. case	1	2297C3747	2297C3747	2297C3747	.34 oz. tube - SEE NOTE following parts listing.
26	Washer - Inter-axle diff. case bolt	16	1229E1513	1229E1513	1229E1513	SEE KIT 389 .
27	Gasket - Shift housing	1	2208G501	2208G501	2208G501	
28	Nut	1	13X41	13X41	13X41	
29	Screw-thrust	1	15X1025	15X1025	15X1025	
30~, 33, 32~, 34	Carrier & cap assy.	1	MPS2255	A2-3200P1420	A2-3200P1420	
31	Gasket - carrier to hsg. (Silastic)	3 oz.	1199T3842	1199T3842	1199T3842	SEE KIT 533
32~	Dowel-bearing cap	4	1898Z1066	1898Z1066	1898Z1066	
33	Capscrew - Diff. bearing cap	4	S21444-1	S21444-1	S21444-1	
34	Washer - Diff. bearing cap	4	1229T1554	1229T1554	1229M1625	
35	Plug-filler	1	P212	P212	1250E473	
36	Washer - carrier to housing	14		1229U1503	1229U1503	
37	Capscrew - carrier to housing	8		S21014-1	S21014-1	

~ - Not serviced separately.

^ = 1229R1604 & 1229V2570 are required for square cut groove.

^^ = 1229L4354 is required for round cut groove.

* = Specify ratios. When changing ratios from standard to medium or fast, you must change differential cases.

PARTS LISTED IN THIS CATALOG ARE NOT NECESSARILY MANUFACTURED BY THE ORIGINAL EQUIPMENT MANUFACTURER AND ANY REFERENCE TO THE TRADEMARKS OR PART NUMBERS OF OTHERS ARE FOR CROSS REFERENCE INFORMATIONAL PURPOSES ONLY. THE TRADEMARKS OF OTHERS REFERRED TO HEREIN ARE OWNED BY THEIR RESPECTIVE COMPANIES AND ARE NOT AFFILIATED IN ANY WAY WITH MIDWEST TRUCK & AUTO PARTS, INC.® MOTIVE GEAR® AND WORLD AMERICAN® ARE THE REGISTERED TRADEMARKS OF MIDWEST TRUCK & AUTO PARTS, INC.® USE OF THE ® IN CONNECTION WITH A MARK OF MIDWEST TRUCK & AUTO PARTS, INC.® INDICATES THAT THE MARK IS REGISTERED IN AT LEAST THE UNITED STATES. NO REPRESENTATION IS MADE WITH RESPECT TO THE SOURCE OF MANUFACTURE OF ANY PARTICULAR PART. © 2005, MIDWEST TRUCK & AUTO PARTS, INC.® ALL RIGHTS RESERVED.

ROCKWELL®

SSHD FRONT (Cont'd)

ITEM	DESCRIPTION	QTY	CARRIER	CARRIER	CARRIER	REMARKS
			3200-M-585 PART NUMBER DATE 1/74	3200-R-1162 PART NUMBER DATE 1/76	3200-P-1420 PART NUMBER DATE 1/83	
38	Thru-shaft	1	A3280Z2444 (Includes Item 50)	3280L6720	3280L6720	
39	Gasket - thru-shaft bearing cage	1	2208C445	2208C445	2208C445	
40~, 43	Cage assy. thru-shaft bearing	1	A3226X180	A3226W699	A3226W699	
41	Washer - thru-shaft bearing cage	4	1229K1597	1229U1503	1229K1597	
42	Capscrew - thru-shaft brg. cage	4	S268-2	S268-2	S268-2	
43	Bearing cup - thru-shaft inner & outer	2	210 (Ball brg. assy.)	JLM104910	JLM104910	
44	Bearing cone - thru-shaft	2		LM104949	LM104949	
45	Snap Ring - thru-shaft	1	1229L1598			CALL YOUR SALES REP
46	Oil seal - thru-shaft bearing cage	1	475322N	475322N	4874N	
47	Thrust washer - thru-shaft brg.	1		1229C2057	1229C2057	
48	Yoke/flange - thru-shaft	1				CALL YOUR SALES REP
49	Washer - thru-shaft rear yoke	1		1229T1736	1229T1736	
50	Nut - thru-shaft rear yoke	1	1227A937	1227J946	1227J946	
51	Capscrew - drive pinion brg. cover	6	S266-1	S266-1	S266-1	
52	Washer - drive pinion brg. cover	6	1229C1017	1229C1017	1229C1017	
53	Cover - drive pinion bearing	1	3262H112	3262H112	3262H112	
54	Gasket - drive pinion brg. cover	1	2208F500	2208F500	2208F500	
55	Nut - drive pinion shaft	1	1227D940	1227D940	1227D940	
56	Washer - drive pinion shaft	1	1229S1605	1229S1605	1229S1605	
57	Bearing cone - drive pinion outer	1	65237	65237	65237	
58	Bearing cup - drive pinion outer	1	65500	65500	65500	
59	Spacer - drop gear box	1	1244G787	1244G787	1244G787	
60	Spacer - pinion bearing	As req.				CALL YOUR SALES REP
61	Gear-driven drop box	1	3892D1798	3892D1798	3892D1798	
62	Shim-drive	.003	2203F2788	2203F2788	2203F2788	
		.005	2203G2789	2203G2789	2203G2789	
		.010	2203H2790	2203H2790	2203H2790	
63	Bearing cup - drive pinion inner	1	H715311	H715311	H715311	
64	Bearing cone - drive pinion outer	1	H715343	H715343	H715343	
65~	Drive gear & pinion assy.	1				See Page 127
66	Cotter-diff. bearing adj. ring	2	1199M2457	1199M2457	1199M2457	
67	Adj. ring-diff. bearing	2	2214X50	2214X50	2214X50	
68	Bearing cup - diff.	2	47820	47820	47820	
69	Bearing cone - diff.	2	47890	47890	47890	
70	Capscrew diff. case	Short	S21020A-1	S21020A-1	S21020A-1	
		Long	S21028A-1	S21028A-1	S21028A-1	
71	Washer - diff. case capscrew	12	1229U1503	1229U1503	1229U1503	
72	Thread locking liquid/diff. case	1	2297C3747	2297C3747	2297C3747	.34 oz. tube - SEE NOTE following parts listing.
73~, 70, 72, 72	Diff. case assy. - main	1	A32-3235N1106	A32-3235N1106	A3235N1678	Standard ratio
		1	A39-3235Q1109	A39-3235Q1109	A3235Q1681	Fast ratio
70 thru 78	Diff. case & nest assy - main (for axle using 2-1/4" - 23 spline)	1	A4-3235N1106	A4-3235N1106	A3-3235N1678	Standard ratio
78	(for axle using 2-1/4" - 23 spline)	1	A6-3235Q1109	A6-3235Q1109	A3-3235Q1681	Fast ratio
70 thru 78	Diff. case & nest assy - main (for axle using 2-3/8" - 24 spline)	1	A1-3235N1106	A1-3235N1106	A1-3235N1678	Standard ratio
78	(for axle using 2-3/8" - 24 spline)	1	A1-3235Q1109	A1-3235Q1109	A1-3235Q1681	Fast ratio
74	Thrust washer - diff. side gear	2	1229E993	1229E993	1229E993	
75	Side gear 23 Spline	2	2234K271	2234K271	2234K271	No-Spin™ A3230V22
	main diff. 24 Spline	2	2234F344	2234F344	2234F344	No-Spin™ A3230W23
76	Thrust washer - diff. pinion	4	1229D992	1229D992	1229D992	
77	Pinion - diff.	4	2233U99	2233U99	2233U99	
78	Spider - diff.	1	3278A79	3278A79	3278A79	
79	Capscrew	12	15X1707	15X1707	15X1707	
79A	Washer - gear to case	12	1229U1503	1229U1503	1229U1503	
79B	Nut - gear to case	12	NL110-1	NL110-1	NL110-1	

~ - Not serviced separately.

^ = 1229R1604 & 1229V2570 are required for square cut groove.

^^ = 1229L4354 is required for round cut groove.

PARTS LISTED IN THIS CATALOG ARE NOT NECESSARILY MANUFACTURED BY THE ORIGINAL EQUIPMENT MANUFACTURER AND ANY REFERENCE TO THE TRADEMARKS OR PART NUMBERS OF OTHERS ARE FOR CROSS REFERENCE INFORMATIONAL PURPOSES ONLY. THE TRADEMARKS OF OTHERS REFERRED TO HEREIN ARE OWNED BY THEIR RESPECTIVE COMPANIES AND ARE NOT AFFILIATED IN ANY WAY WITH MIDWEST TRUCK & AUTO PARTS, INC.® MOTIVE GEAR® AND WORLD AMERICAN® ARE THE REGISTERED TRADEMARKS OF MIDWEST TRUCK & AUTO PARTS, INC.® USE OF THE ® IN CONNECTION WITH A MARK OF MIDWEST TRUCK & AUTO PARTS, INC.® INDICATES THAT THE MARK IS REGISTERED IN AT LEAST THE UNITED STATES. NO REPRESENTATION IS MADE WITH RESPECT TO THE SOURCE OF MANUFACTURE OF ANY PARTICULAR PART. © 2005, MIDWEST TRUCK & AUTO PARTS, INC.® ALL RIGHTS RESERVED.

ROCKWELL®

SSHD FRONT (Cont'd)

ITEM	DESCRIPTION	QTY	CARRIER	CARRIER	CARRIER
			3200-M-585	3200-R-1162	3200-P-1420
			PART NUMBER	PART NUMBER	PART NUMBER
			DATE 1/74	DATE 1/76	DATE 1/83
79C	Rivet - bevel gear to case	12	RV71016	RV71016	RV71016
80	Nut-jam	1	N18-1	N18-1	N18-1
81	Adj. screw - shift housing	1	S1811-1	3X338	3X338
82, 85	Shift housing assy.	1	A3280D2448	A3280D2448	A3280D2448
83	Capscrew - Shift housing	4	S268-2	S268-2	S268-2
84	Washer - Shift housing capscrew	4	1229C1017	1229C1017	1229C1017
85	Capscrew - chamber to housing	2	SN613-1	S268-2	S268-2
86	Gasket - chamber to housing	1	2208M429	2208M429	2208M429
87	Washer - chamber to housing stud	2	1229B1666	1229B1666	1229B1666
88	Nut - chamber to housing stud	2	N16-1	N16-1	N16-1
89	Chamber assy. - air shift	1	A3261C289	A3261C289	A3261C289
90	Nut - shift fork bolt	1	NL16-1	NL16-1	NL16-1
91	Ball - shift fork	1	1199V1712	1199V1712	1199V1712
92, 93~	Shift fork assy.	1	MPS2637	A1-2297D862	A1-2297D862
94	Washer - inner shift fork	1	1229E1513	1229M1599	1229M1599
95	Spring - shift fork	1	2258R408	2258R408	2258R408
96	Bolt - shift fork	1	15X1337	15X1337	15X1337
97	Washer - shift assy. lock	1	1229C1407	1229W1245	1229W1245
98	Washer - shift spring	1	1229R798	1229R798	1229R798
99	Spring - shift	1	2258L402	2258L402	2258L402

NOTE: THREAD LOCKING LIQUID/DIFFERENTIAL CASE HALVES

When assembling differential case halves in Rockwell International® axles, a thread locking adhesive should be used. The recommended procedure is as follows:

1. Wipe excess oil and residue from the threaded holes in the case. The holes should be relatively oil-free.
2. If **new bolts** are used, a yellow coating of Dri-Loc™ should appear on the threads. Assemble the case with these coated bolts to the required torque.
3. If the **original** bolts are reused or **regular bolts** without Dri-Loc™ are used, Rockwell® Part No. 2297C3747 should be used as a thread locking adhesive. **Apply the adhesive to the differential case holes only.** Thread the bolts and tighten to the required torque.

IMPORTANT: Do not apply Rockwell® Part No. 2297C3747 to Dri-Loc™ coated bolts. Refer to Rockwell® Service.

SSHD (ALL MODELS FORWARD-REAR WITH 2 5/8" - 26 SPLINE - EXCEPT PUMP VERSION) *

PART NUMBER	RATIO		AXLE
	FAST	STANDARD	
A40160-1	FAST	3.73	SHD, THD, and UHD
A40162-1		3.90	
A40164-1		4.10	
A40170-1		4.30	
A40036-1		4.56	
A40172-1		4.63	
A40176-1	STANDARD	4.89	
A40178-1		5.29	
A40046-1		5.38	
A40180-1		5.57	
A40182-1		6.14	
A40306-1		6.83	
A40502-1		7.40	

~ - Not serviced separately.

* = NOTE: The above gear sets are to be used with the optional oil pump only, and are not interchangeable with 3200R1162 or 3200P1420 carrier.

PARTS LISTED IN THIS CATALOG ARE NOT NECESSARILY MANUFACTURED BY THE ORIGINAL EQUIPMENT MANUFACTURER AND ANY REFERENCE TO THE TRADEMARKS OR PART NUMBERS OF OTHERS ARE FOR CROSS REFERENCE INFORMATIONAL PURPOSES ONLY. THE TRADEMARKS OF OTHERS REFERRED TO HEREIN ARE OWNED BY THEIR RESPECTIVE COMPANIES AND ARE NOT AFFILIATED IN ANY WAY WITH MIDWEST TRUCK & AUTO PARTS, INC.® MOTIVE GEAR® AND WORLD AMERICAN® ARE THE REGISTERED TRADEMARKS OF MIDWEST TRUCK & AUTO PARTS, INC.® USE OF THE ® IN CONNECTION WITH A MARK OF MIDWEST TRUCK & AUTO PARTS, INC.® INDICATES THAT THE MARK IS REGISTERED IN AT LEAST THE UNITED STATES. NO REPRESENTATION IS MADE WITH RESPECT TO THE SOURCE OF MANUFACTURE OF ANY PARTICULAR PART. © 2005, MIDWEST TRUCK & AUTO PARTS, INC.® ALL RIGHTS RESERVED.