

CM40

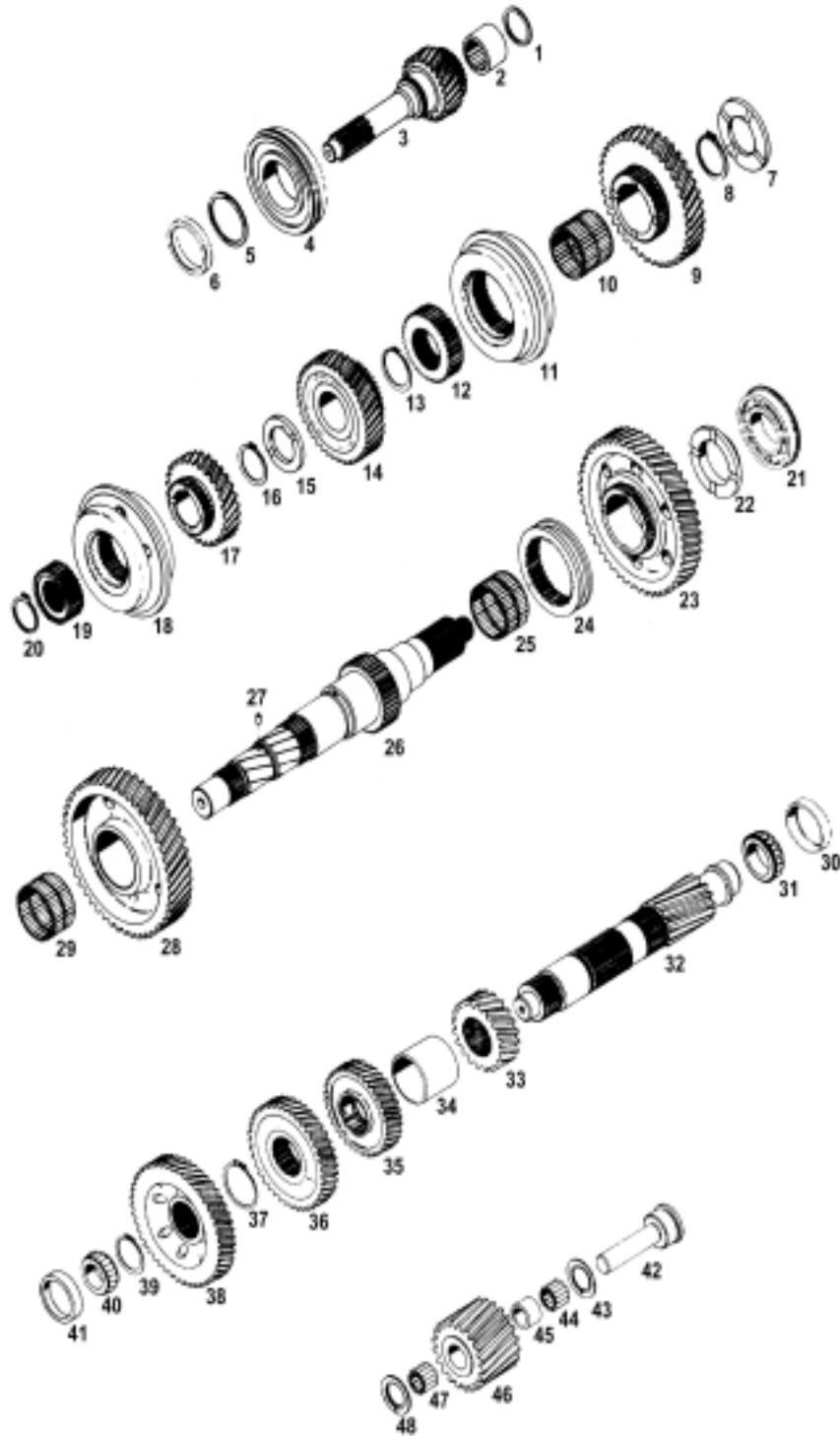

PARTS LISTED IN THIS CATALOG ARE NOT NECESSARILY MANUFACTURED BY THE ORIGINAL EQUIPMENT MANUFACTURER AND ANY REFERENCE TO THE TRADEMARKS OR PART NUMBERS OF OTHERS ARE FOR CROSS REFERENCE INFORMATIONAL PURPOSES ONLY. THE TRADEMARKS OF OTHERS REFERRED TO HEREIN ARE OWNED BY THEIR RESPECTIVE COMPANIES AND ARE NOT AFFILIATED IN ANY WAY WITH MIDWEST TRUCK AND AUTO PARTS, INC.™ MOTIVE GEAR® AND WORLD AMERICAN® ARE THE REGISTERED TRADEMARKS OF MIDWEST TRUCK AND AUTO PARTS, INC.™ NO REPRESENTATION IS MADE WITH RESPECT TO THE SOURCE OF MANUFACTURE OF ANY PARTICULAR PART. © 2005, MIDWEST TRUCK AND AUTO PARTS, INC.™ ALL RIGHTS RESERVED.

SPICER® CM-40

FIGURE	DESCRIPTION	OEM NO.	WORLD AMERICAN #
1	SNAP RING	40-381-6	40-381-6
2	POCKET BEARING	500962	500962
3	MAIN DRIVE GEAR (24T)	40-35-12	40-35-12
	MAIN DRIVE GEAR (24T)	40-35-22	40-35-22
7	THRUST WASHER	40-47-2	40-47-2
8	SNAP RING	40-381-4	40-381-4
9	M/S 2ND GEAR (38T)	40-8-5	40-8-5
10	BEARING	550968	F95407
11	2/3 SYNCHRONIZER (313471X)	313764X	313764X
12	M/S CLUTCH GEAR	40-466-2	40-466-2
13	SNAP RING	40-381-3	40-381-3
14	M/S 3RD GEAR (39T)	40-8-3	40-8-3R
	M/S 3RD GEAR (39T)	40-8-17	40-8-17
15	THRUST WASHER	40-47-3	40-47-3
16	SNAP RING	40-381-2	40-381-2
17	M/S 4TH GEAR (28T)	40-8-1	40-8-1
	M/S 4TH GEAR (26T)	40-8-11	40-8-11
	M/S 4TH GEAR (28T)	40-8-19	40-8-19
	M/S 4TH GEAR (26T)	40-8-21	40-8-21
18	4/5 SYNCHRONIZER (313472X OR 313558X)	313775X	313775X
19	M/S CLUTCH GEAR (49-466-2) - 33T	49-466-2	49-466-2
20	SNAP RING	40-381-1	40-381-1
22	THRUST WASHER	313605X	313605X
23	CLUTCH COLLAR	40-465-11	40-465-11
	M/S REVERSE GEAR (46T)	40-8-9	40-8-9
24	CLUTCH COLLAR	40-465-1	313685-3X
25	BEARING	550963	F13290
26	MAIN SHAFT	40-362-1	40-362-1
27	PIN-THRUST WASHER LOCK	545087	545087
28	M/S 1ST GEAR (46T)	40-8-7	40-8-7R
29	BEARING	550963	F93290
31	BEARING	550966	550966
32	COUNTERSHAFT	40-30-1	40-30-1
33	C/S 2ND GEAR (20T)	40-196-5	40-196-5
34	SPACER	40-37-1	40-37-1
35	C/S 3RD GEAR (36T)	40-196-3	40-196-3
36	C/S 4TH GEAR (40T) - FOR 4054-A	40-196-1	40-196-1
	C/S 4TH GEAR (42T) - FOR 4054-D	40-196-7	40-196-7
37	SNAP RING	40-381-5	40-381-5
38	C/S DRIVE GEAR (49T)	40-1-1	40-1-1
39	SNAP RING	40-381-3	40-381-3
40	BEARING CONE	550964	550964
41	BEARING CUP	550965	550965
42	SHAFT	40-60-1	40-60-1
43	THRUST WASHER	974W	974W
44	BEARING	550886	WJ162116
45	SPACER	97-37-1	97-37-1
46	REVERSE IDLER GEAR (21T)	40-5-1	40-5-1
47	BEARING	550886	WJ162116
48	THRUST WASHER	974W	974W
N/A	NUT (501200)	263-90	222960
N/A	GASKET KIT	312475-40X	312475-40XR
N/A	SMALL PARTS KIT	313024-14X	313024-14X



PARTS LISTED IN THIS CATALOG ARE NOT NECESSARILY MANUFACTURED BY THE ORIGINAL EQUIPMENT MANUFACTURER AND ANY REFERENCE TO THE TRADEMARKS OR PART NUMBERS OF OTHERS ARE FOR CROSS REFERENCE INFORMATIONAL PURPOSES ONLY. THE TRADEMARKS OF OTHERS REFERRED TO HEREIN ARE OWNED BY THEIR RESPECTIVE COMPANIES AND ARE NOT AFFILIATED IN ANY WAY WITH MIDWEST TRUCK AND AUTO PARTS, INC.™ MOTIVE GEAR® AND WORLD AMERICAN® ARE THE REGISTERED TRADEMARKS OF MIDWEST TRUCK AND AUTO PARTS, INC.™ NO REPRESENTATION IS MADE WITH RESPECT TO THE SOURCE OF MANUFACTURE OF ANY PARTICULAR PART. © 2005, MIDWEST TRUCK AND AUTO PARTS, INC.™ ALL RIGHTS RESERVED.