

CM55

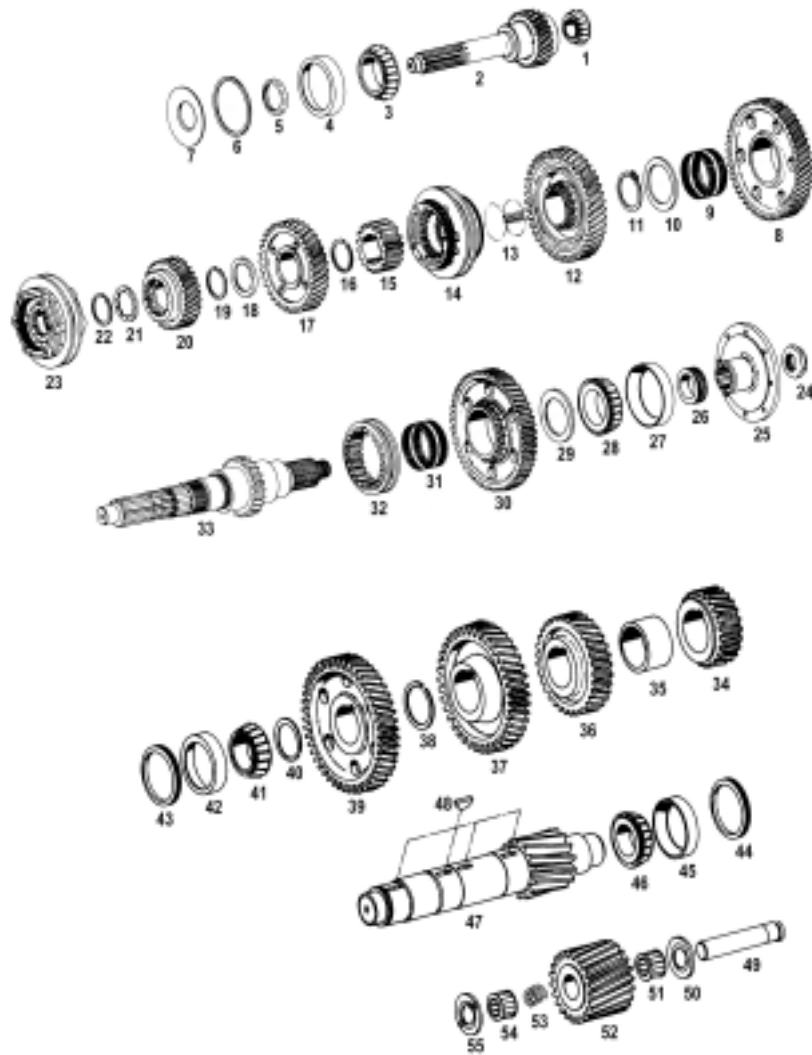

SPICER® CM55

FIGURE	DESCRIPTION	OEM NO.	WORLD AMERICAN #
1	BEARING	550931	2580T
2	MAIN DRIVE GEAR (23T) - 1.5" - FOR 5552	53-35-1	53-35-1
	MAIN DRIVE GEAR (24T) - 1.75" - FOR 5852	53-35-14	53-35-14
	MAIN DRIVE GEAR (24T) - 1.5" - FOR 5852	53-35-15	53-35-15-1XR
	MAIN DRIVE GEAR (24T) - 1.5" - FOR 5852	53-35-19	53-35-19-1XR
	MAIN DRIVE GEAR (23T) - 1.75" - FOR 5552	53-35-2	53-35-2-1XR
	MAIN DRIVE GEAR (24T) - 1.5" - FOR 5852	53-35-20	53-35-20-1X
	MAIN DRIVE GEAR (23T) - 1.75" - FOR 5552	53-35-3	53-35-3-1XR
	MAIN DRIVE GEAR (23T) - 1.5" - FOR 5552	53-35-9	53-35-1XR
3	BEARING	550930	550930
4	BEARING CUP	550929	550929
5	BAFFLE	47-468-2	47-468-2
6	SPACER / SHIM	47-228-2-2	47-228-2-2
7	BAFFLE	47-468-1	47-468-1
8	M/S 1ST GEAR (42T)	53-8-9	53-8-9R

PARTS LISTED IN THIS CATALOG ARE NOT NECESSARILY MANUFACTURED BY THE ORIGINAL EQUIPMENT MANUFACTURER AND ANY REFERENCE TO THE TRADEMARKS OR PART NUMBERS OF OTHERS ARE FOR CROSS REFERENCE INFORMATIONAL PURPOSES ONLY. THE TRADEMARKS OF OTHERS REFERRED TO HEREIN ARE OWNED BY THEIR RESPECTIVE COMPANIES AND ARE NOT AFFILIATED IN ANY WAY WITH MIDWEST TRUCK AND AUTO PARTS, INC.™ MOTIVE GEAR® AND WORLD AMERICAN® ARE THE REGISTERED TRADEMARKS OF MIDWEST TRUCK AND AUTO PARTS, INC.™ NO REPRESENTATION IS MADE WITH RESPECT TO THE SOURCE OF MANUFACTURE OF ANY PARTICULAR PART. © 2005, MIDWEST TRUCK AND AUTO PARTS, INC.™ ALL RIGHTS RESERVED.

SPICER® CM55 (cont'd)

FIGURE	DESCRIPTION	OEM NO.	WORLD AMERICAN #
9	BEARING	550932	F81205
10	THRUST WASHER	330866	330866
11	SNAP RING	27-381-5	27-381-5
12	M/S 2ND GEAR (36T) 5552A, 5552D, 5852A B/S 2741653	53-8-10	53-8-10R
	M/S 2ND GEAR (36T) 5552A, 5552D, 5852A A/S 2741643	53-8-24	53-8-24
13	NEEDLE ROLLER KIT	59-482-1	59-482-1
14	3/4 SYNCHRONIZER (18T)	313459X	313459X
	2/3 SYNCHRONIZER (40T)	313536X	313536X
15	SYNCHRO HUB 2ND & 3RD	53-466-1	53-466-1
	SYNCHRO HUB 2ND & 3RD	59-466-3	59-466-3
16	SNAP RING	46-381-1	46-381-1
17	M/S 3RD GEAR (35T) 5552D, 5852A B/S 2741653	53-8-14	53-8-14
	M/S 3RD GEAR (37T) 5552A B/S 2741653	53-8-16	53-8-16
	M/S 3RD GEAR (38T) 5552C B/S 2741653	53-8-18	53-8-18
	M/S 3RD GEAR (35T) 5552D, 5852A A/S 2741653	53-8-26	53-8-26R
	M/S 3RD GEAR (37T) 5552A A/S 2741653	53-8-28	53-8-28R
18	THRUST WASHER	330818	330818
19	SNAP RING	53-381-2	53-381-2
20	M/S 4TH GEAR (27T) 5552D, 5852A	53-8-21	53-8-21
	M/S 4TH GEAR (29T) 5552A, 5552C	53-8-22	53-8-22
21	THRUST WASHER	1016W	1016W
22	SNAP RING	53-381-2	53-381-2
23	4/5 SYNCHRONIZER	313453X	313453XR
	4/5 SYNCHRONIZER	313535X	313535X
24	NUT (501200) - 222960	263-90	222960
27	BEARING CUP	550929	550929
28	BEARING	550930	550930
29	THRUST WASHER	330867	330867
30	M/S REVERSE GEAR (42T)	53-8-1	53-8-1R
31	BEARING	550932	F81205
32	CLUTCH COLLAR	47-465-1	47-465-1
33	MAIN SHAFT - 2.00" - 40 SPLINES	53-362-3	53-362-3R
34	C/S 2ND GEAR (18T) 5552B, C	53-196-1	53-196-1
	C/S 2ND GEAR (19T) 5552A, 5552D, 5852A	53-196-3	53-196-3R
35	BUSHING	46-37-5	46-37-5
36	C/S 3RD GEAR (32T) 5552A	46-196-13	46-196-13
	C/S 3RD GEAR (34T) 5552D, 5852A	46-196-17	46-196-17
	C/S 3RD GEAR (31T) 5552C	46-196-21	46-196-21
	C/S 3RD GEAR (30T) 5552B	46-196-29	46-196-29
37	C/S 4TH GEAR (39T) 5552B	46-196-35	46-196-35
	C/S 4TH GEAR (41T) 5552A, 5552C	46-196-38	46-196-38R
	C/S 4TH GEAR (43T) 5552D, 5852A	46-196-40	46-196-40R
38	SNAP RING	82-381-1	82-381-1
39	C/S DRIVE GEAR (47T) 5552A, 5552B, 5552C, 5552D	47-1-1	47-1-1R
	C/S DRIVE GEAR (45T) 5852A	47-1-3	47-1-3
40	SNAP RING	46-381-1	46-381-1
41	BEARING	550927	25584
42	BEARING CUP	550375	550375
43	SPACER	47-37-3	47-37-3
44	SHIM - .005" THICK	47-228-3	47-228-3
45	BEARING CUP	550375	550375
46	COUNTERSHAFT (12T)	550927	25584

PARTS LISTED IN THIS CATALOG ARE NOT NECESSARILY MANUFACTURED BY THE ORIGINAL EQUIPMENT MANUFACTURER AND ANY REFERENCE TO THE TRADEMARKS OR PART NUMBERS OF OTHERS ARE FOR CROSS REFERENCE INFORMATIONAL PURPOSES ONLY. THE TRADEMARKS OF OTHERS REFERRED TO HEREIN ARE OWNED BY THEIR RESPECTIVE COMPANIES AND ARE NOT AFFILIATED IN ANY WAY WITH MIDWEST TRUCK AND AUTO PARTS, INC.™ MOTIVE GEAR® AND WORLD AMERICAN® ARE THE REGISTERED TRADEMARKS OF MIDWEST TRUCK AND AUTO PARTS, INC.™ NO REPRESENTATION IS MADE WITH RESPECT TO THE SOURCE OF MANUFACTURE OF ANY PARTICULAR PART. © 2005, MIDWEST TRUCK AND AUTO PARTS, INC.™ ALL RIGHTS RESERVED.

SPICER® CM55 (cont'd)

FIGURE	DESCRIPTION	OEM NO.	WORLD AMERICAN #
47	BEARING	53-30-3	53-30-3
48	C/S KEY	50008-37	SP50008-37
49	SHAFT	63-60-1	63-60-1
50	THRUST WASHER	974W	974W
51	BEARING	550886	550886
52	REVERSE IDLER GEAR	59-5-1	59-5-1
53	SPACER	97-37-1	97-37-1
54	BEARING	550886	550886
55	THRUST WASHER	974W	974W
N/A	BEARING KIT - 313400-45X	180	T180R
N/A	SPACER KIT	3123240-3X	3123240-3X
N/A	GASKET KIT - 312475-28X	312475-28X	312475-28X
N/A	SMALL PARTS KIT - 313024-13X	313024-13X	313024-13X
N/A	WASHER	53-205-1	53-205-1



PARTS LISTED IN THIS CATALOG ARE NOT NECESSARILY MANUFACTURED BY THE ORIGINAL EQUIPMENT MANUFACTURER AND ANY REFERENCE TO THE TRADEMARKS OR PART NUMBERS OF OTHERS ARE FOR CROSS REFERENCE INFORMATIONAL PURPOSES ONLY. THE TRADEMARKS OF OTHERS REFERRED TO HEREIN ARE OWNED BY THEIR RESPECTIVE COMPANIES AND ARE NOT AFFILIATED IN ANY WAY WITH MIDWEST TRUCK AND AUTO PARTS, INC.™ MOTIVE GEAR® AND WORLD AMERICAN® ARE THE REGISTERED TRADEMARKS OF MIDWEST TRUCK AND AUTO PARTS, INC.™ NO REPRESENTATION IS MADE WITH RESPECT TO THE SOURCE OF MANUFACTURE OF ANY PARTICULAR PART. © 2005, MIDWEST TRUCK AND AUTO PARTS, INC.™ ALL RIGHTS RESERVED.