

FS5005

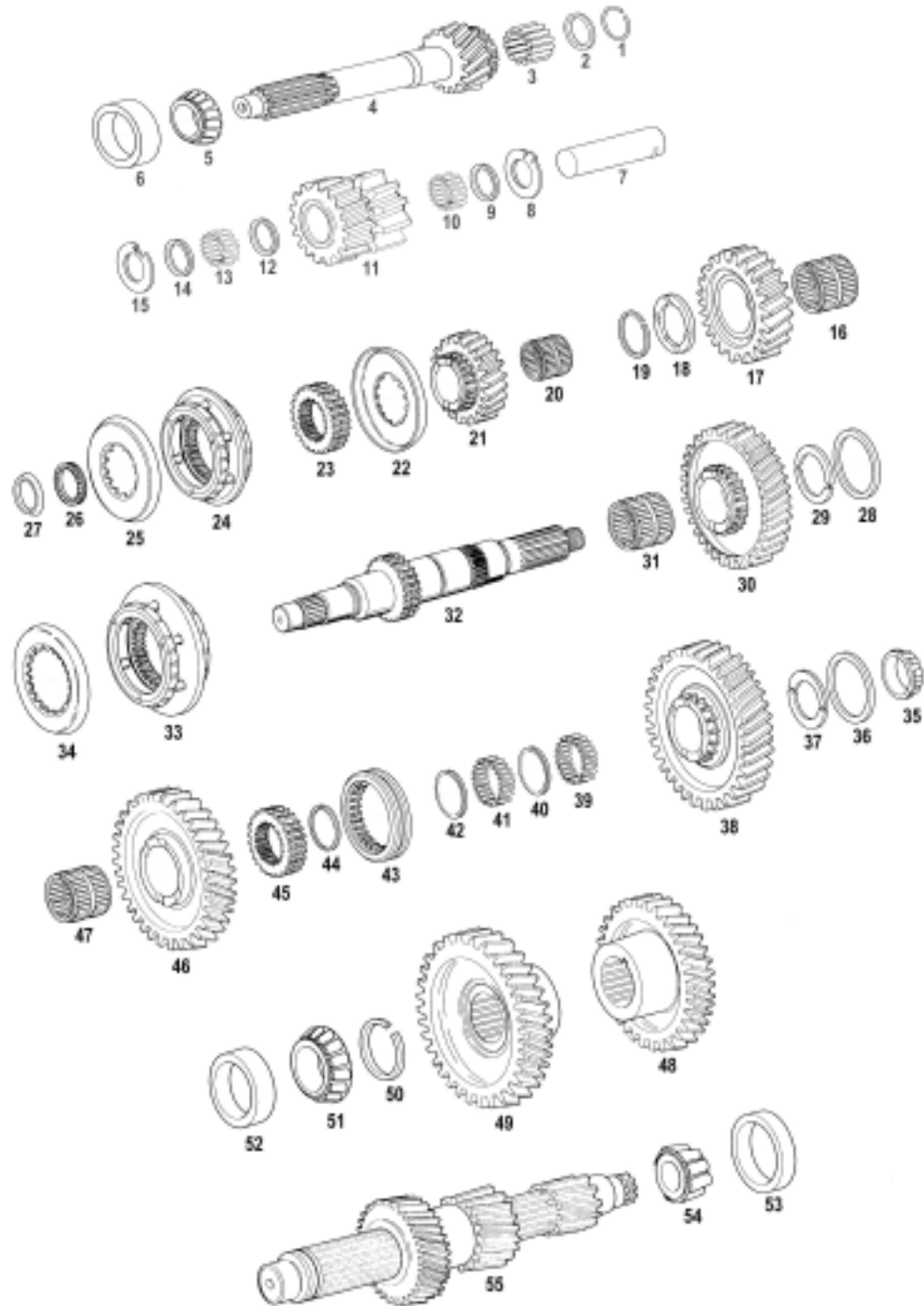

EATON/FULLER® FS5005 SERIES

FIGURE	DESCRIPTION	OEM#	WORLD AMERICAN #
1	SNAP RING	235416	235416
2	WASHER (A, B)	235415	235415
3	NEEDLE BEARING	235414	235414
4	MAIN DRIVE GEAR (A)	235353	WT326-16
	MAIN DRIVE GEAR (A)	235354	WT326-16A
	MAIN DRIVE GEAR (B, C)	235432	WT326-16C
	MAIN DRIVE GEAR (A)	235351	WT326-16D
	MAIN DRIVE GEAR (A)	235648	235648
	MAIN DRIVE GEAR (B, C)	235649	235649
	MAIN DRIVE GEAR (A)	235433	WT326-16G

PARTS LISTED IN THIS CATALOG ARE NOT NECESSARILY MANUFACTURED BY THE ORIGINAL EQUIPMENT MANUFACTURER AND ANY REFERENCE TO THE TRADEMARKS OR PART NUMBERS OF OTHERS ARE FOR CROSS REFERENCE INFORMATIONAL PURPOSES ONLY. THE TRADEMARKS OF OTHERS REFERRED TO HEREIN ARE OWNED BY THEIR RESPECTIVE COMPANIES AND ARE NOT AFFILIATED IN ANY WAY WITH MIDWEST TRUCK AND AUTO PARTS, INC.™ MOTIVE GEAR® AND WORLD AMERICAN® ARE THE REGISTERED TRADEMARKS OF MIDWEST TRUCK AND AUTO PARTS, INC.™ NO REPRESENTATION IS MADE WITH RESPECT TO THE SOURCE OF MANUFACTURE OF ANY PARTICULAR PART. © 2005, MIDWEST TRUCK AND AUTO PARTS, INC.™ ALL RIGHTS RESERVED.

EATON/FULLER® FS5005 SERIES

FIGURE	DESCRIPTION	OEM#	WORLD AMERICAN #
5	BEARING CONE	1314773	M802048
	BEARING CONE	235418	M804049
6	BEARING CUP	1314774	M802011
	BEARING CUP	235417	M804010
7	BEARING CUP	203609	WT215-35B
8	WASHER	240023	240023
9	SPACER	235413	235413
10	NEEDLE BEARING	235412	QA47838
11	IDLER GEAR	235392	WT326-10
12	SPACER	235413	235413
13	NEEDLE BEARING	235412	QA47838
14	SPACER	235413	235413
15	WASHER	240023	240023
16	BEARING	239653	F94490
17	M/S 3RD GEAR	239352	WT326-18B
	M/S 3RD GEAR	239346	WT326-18C
18	WASHER	23127	23127
19	RETAINING RING	224069	224069
20	BEARING	239651	F94488
21	M/S 4TH GEAR	239353	WT326-11B
	M/S 4TH GEAR	239347	WT326-11C
22	CLUTCH HUB 4/5	239350	WT326-2.5A
	CLUTCH HUB 4/5	23694	23694
23	4/5 SYNCHRONIZER CUP	228296	WT305-14
24	4/5 SYNCHRONIZER	237054	AWT305-2.5
	4/5 SYNCHRONIZER	A-5401	AWT305-2.5
25	4/5 SYNCHRONIZER CUP	228296	WT305-14
26	BEARING	235382	FA35688
27	BEARING RACE	235383	TR235383
28	OIL SEAL	235379	235379
29	SPLIT WASHER (2)	235378	235378
30	M/S 2ND GEAR	235366	WT326-31
31	BEARING	239653	F94490
32	MAINSHAFT	23696	K2291
33	2/3 SYNCHRONIZER	237053	AWT305-80
	2/3 SYNCHRONIZER	A-5693	AWT305-80
34	2/3 SYNCHRONIZER CUP	228306	WT305-83
35	CONE	237227	237227
36	OIL SEAL	235375	235375
37	SPLIT WASHER (2)	235374	235374
38	M/S 1ST GEAR	235363	WT326-12
	BEARING CONE	235364	WT326-12A
39	BEARING	235376	FC66464
40	SNAP RING	235431	235431
41	BEARING	235376	FC66464
42	SNAP RING	235431	235431
43	SLIDING CLUTCH	235373	WT326-15
44	RETAINING RING	235372	235372
45	CLUTCH HUB 1ST/REV.	235371	WT326-2.5
46	M/S REVERSE GEAR	235365	WT326-36
47	BEARING	239653	F94490
48	C/S 4TH GEAR (A, B)	4301183	4301183
	C/S 4TH GEAR (C)	4301184	4301184
49	C/S 5TH GEAR (A)	4301181	4301181
	C/S 5TH GEAR (B, C)	4301182	4301182
50	SNAP RING	224024	224024
51	BEARING CONE	791943	25590
52	BEARING CUP	654166	654166
53	BEARING CUP	654166	654166
54	BEARING CONE	791943	25590
55	COUNTERSHAFT (A)	4301185	4301185
	COUNTERSHAFT (C)	4301187	4301187
N/A	STEEL BALL (2)	10J06	10J06
N/A	SMALL PARTS KIT (K2132)	K-2132	K2132
N/A	GASKET KIT	K2085	GS326-55
N/A	BEARING REPAIR KIT	K2122	T395GR
N/A	BEARING REPAIR KIT	K2123	T395HR

PARTS LISTED IN THIS CATALOG ARE NOT NECESSARILY MANUFACTURED BY THE ORIGINAL EQUIPMENT MANUFACTURER AND ANY REFERENCE TO THE TRADEMARKS OR PART NUMBERS OF OTHERS ARE FOR CROSS REFERENCE INFORMATIONAL PURPOSES ONLY. THE TRADEMARKS OF OTHERS REFERRED TO HEREIN ARE OWNED BY THEIR RESPECTIVE COMPANIES AND ARE NOT AFFILIATED IN ANY WAY WITH MIDWEST TRUCK AND AUTO PARTS, INC.™ MOTIVE GEAR® AND WORLD AMERICAN® ARE THE REGISTERED TRADEMARKS OF MIDWEST TRUCK AND AUTO PARTS, INC.™ NO REPRESENTATION IS MADE WITH RESPECT TO THE SOURCE OF MANUFACTURE OF ANY PARTICULAR PART. © 2005, MIDWEST TRUCK AND AUTO PARTS, INC.™ ALL RIGHTS RESERVED.