

FS5106 - FS6206

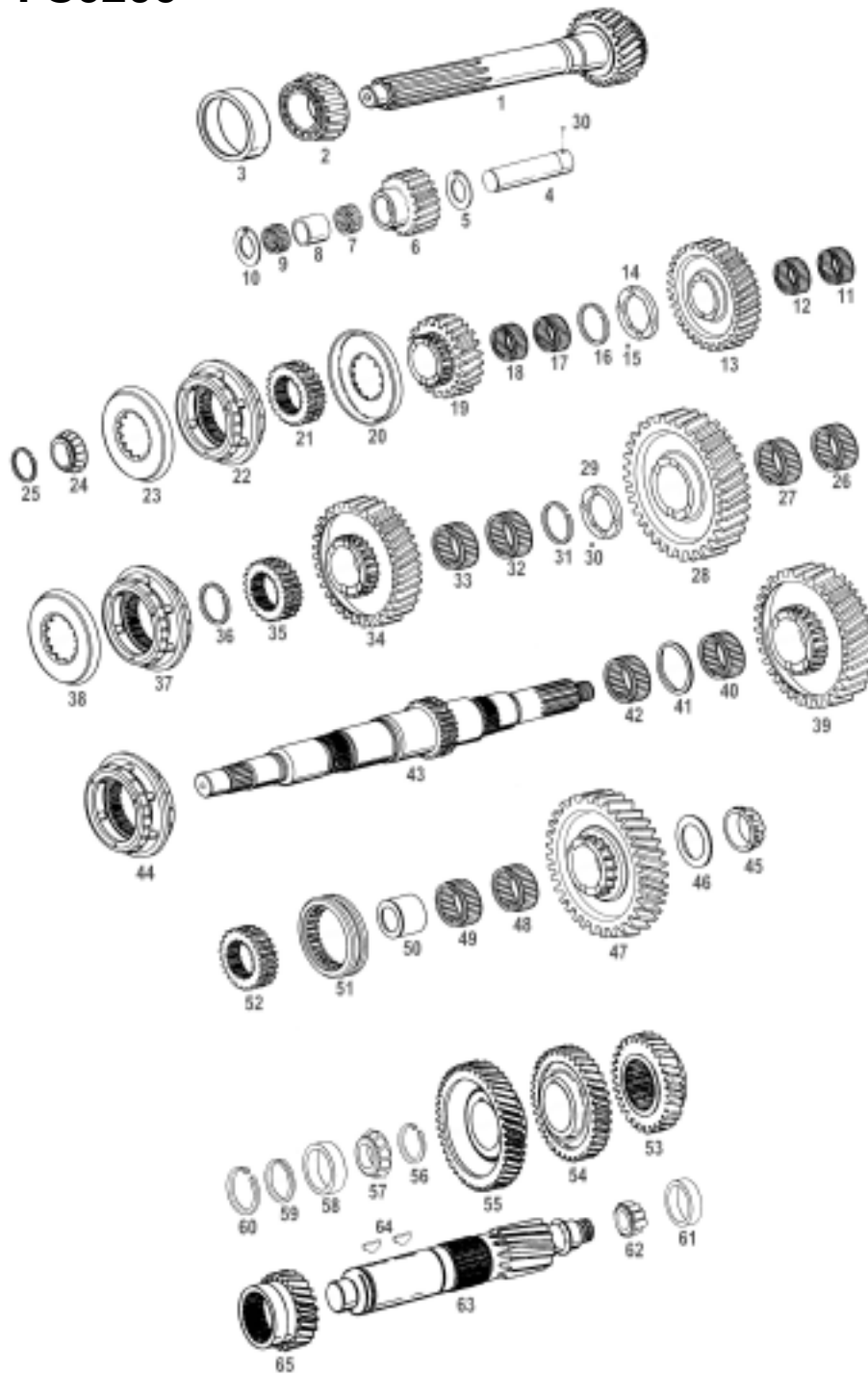

EATON/FULLER® FS5106, FS6206

FIGURE	DESCRIPTION	OEM NO.	WORLD AMERICAN #
1	MAIN DRIVE GEAR MAIN DRIVE GEAR	21898 3316257	21898 3316257
2	BEARING CONE	742259	39590
3	BEARING CUP	675250	39520
4	IDLER SHAFT REV.	3315672	3315672
5	WASHER	3315673	3315673
6	REVERSE IDLER GEAR	3315753	3315753
7	BEARING	3315674	K40X48X20

PARTS LISTED IN THIS CATALOG ARE NOT NECESSARILY MANUFACTURED BY THE ORIGINAL EQUIPMENT MANUFACTURER AND ANY REFERENCE TO THE TRADEMARKS OR PART NUMBERS OF OTHERS ARE FOR CROSS REFERENCE INFORMATIONAL PURPOSES ONLY. THE TRADEMARKS OF OTHERS REFERRED TO HEREIN ARE OWNED BY THEIR RESPECTIVE COMPANIES AND ARE NOT AFFILIATED IN ANY WAY WITH MIDWEST TRUCK AND AUTO PARTS, INC.™ MOTIVE GEAR® AND WORLD AMERICAN® ARE THE REGISTERED TRADEMARKS OF MIDWEST TRUCK AND AUTO PARTS, INC.™ NO REPRESENTATION IS MADE WITH RESPECT TO THE SOURCE OF MANUFACTURE OF ANY PARTICULAR PART. © 2005, MIDWEST TRUCK AND AUTO PARTS, INC.™ ALL RIGHTS RESERVED.

EATON/FULLER® FS5106, FS6206 (cont'd)

FIGURE	DESCRIPTION	OEM NO.	WORLD AMERICAN #
8	SPACER	3315676	3315676
9	BEARING	3315674	K40X48X20
10	WASHER	3315673	3315673
11	BEARING	4124075	K55X60X20
12	BEARING	4124075	K55X60X20
13	M/S 4TH GEAR	3315715	3315715
14	WASHER	3315727	3315727
15	STEEL BALL	T10J-06	T10J06
16	SNAP RING	3315728	3315728
17	BEARING	3315737	K50X55X20
18	BEARING	3315737	K50X55X20
19	M/S 5TH GEAR	3315720	3315720
20	SYNCHRO CUP	228306	WT305-83
21	CLUTCH GEAR 5TH & 6TH	3315738	3315738
22	SYNCHRONIZER 5TH & 6TH	A-5693	AWT305-80
23	SYNCHRO CUP	228306	WT305-83
24	BEARING	710787	31594
25	SNAP RING	3315798	3315798
26	BEARING	3315703	K70X76X20A
27	BEARING	3315703	K70X76X20A
28	M/S 2ND GEAR	3315705	3315705
29	WASHER	3315719	3315719
30	STEEL BALL	T10J-06	T10J06
31	SNAP RING	3315717	3315717
32	BEARING	3315722	K65X70X20
33	BEARING	3315722	K65X70X20
34	M/S 3RD GEAR	22075	22075
35	CLUTCH HUB	3315723	3315723
36	SNAP RING	3315725	3315725
37	3/4TH SYNCHRONIZER - 6206	A-5725	A5725
	3/4TH SYNCHRONIZER - 5106	A-5692	A5692
38	SYNCHRO CUP	3315730	3315730
39	M/S 1ST GEAR	3315700	3315700
40	BEARING	3315703	K70X76X20A
41	SPACER	3315702	3315702
42	BEARING	3315703	K70X76X20A
43	MAINSHAFT	23301	23301
44	2/3RD SYNCHRONIZER	A-5721	A5721
45	BEARING CONE	5202047	5202047
46	WASHER	3315704	3315704
47	M/S REVERSE GEAR	3315692	3315692
48	BEARING	3315703	K70X76X20A
49	BEARING	3315703	K70X76X20A
50	BUSHING	3315698	3315698
51	SLIDING CLUTCH	3315694	3315694
52	CLUTCH HUB REV	3315696	3315696
53	C/S 4TH GEAR	3315747	3315747
54	C/S 5TH GEAR	3315745	3315745
55	C/S DRIVE GEAR	3315743	3315743
56	SNAP RING	3315751	3315751
57	BEARING CONE	791943	25590
58	BEARING CUP	1313645	25522
59	WASHER	3315687	3315687
60	SNAP RING	3315686	3315686
61	BEARING CUP	660181	3720
62	BEARING CONE	658981	3782
63	COUNTERSHAFT	3315740	3315740
64	C/S KEY	230292	230292
65	C/S 3RD GEAR	22076	22076
N/A	SMALL PART KIT	K2012	K2012
N/A	GASKET KIT	K2181	K2181
N/A	BEARING KIT	K2041	K2041

PARTS LISTED IN THIS CATALOG ARE NOT NECESSARILY MANUFACTURED BY THE ORIGINAL EQUIPMENT MANUFACTURER AND ANY REFERENCE TO THE TRADEMARKS OR PART NUMBERS OF OTHERS ARE FOR CROSS REFERENCE INFORMATIONAL PURPOSES ONLY. THE TRADEMARKS OF OTHERS REFERRED TO HEREIN ARE OWNED BY THEIR RESPECTIVE COMPANIES AND ARE NOT AFFILIATED IN ANY WAY WITH MIDWEST TRUCK AND AUTO PARTS, INC.™ MOTIVE GEAR® AND WORLD AMERICAN® ARE THE REGISTERED TRADEMARKS OF MIDWEST TRUCK AND AUTO PARTS, INC.™ NO REPRESENTATION IS MADE WITH RESPECT TO THE SOURCE OF MANUFACTURE OF ANY PARTICULAR PART. © 2005, MIDWEST TRUCK AND AUTO PARTS, INC.™ ALL RIGHTS RESERVED.