

# FS6305

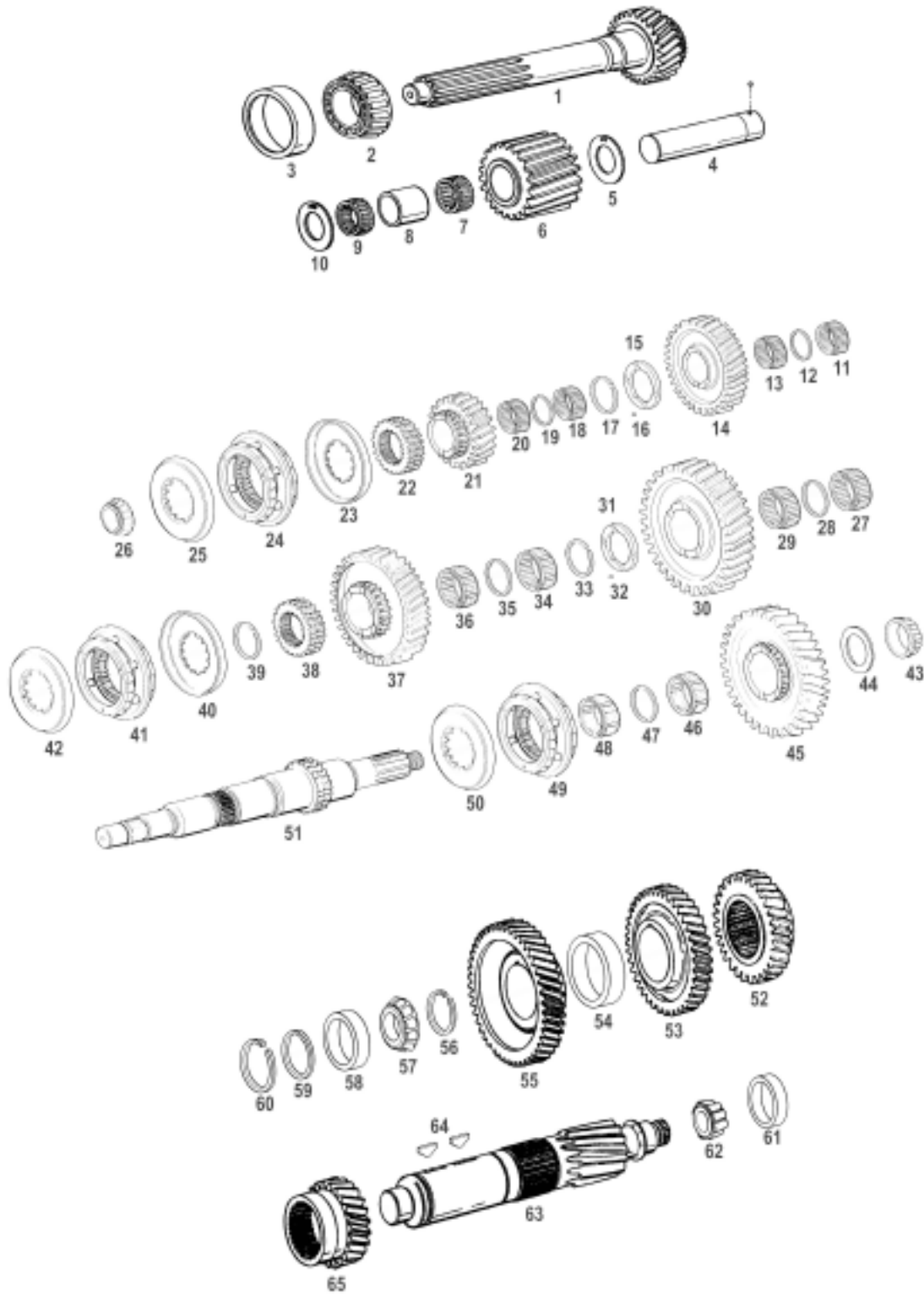

PARTS LISTED IN THIS CATALOG ARE NOT NECESSARILY MANUFACTURED BY THE ORIGINAL EQUIPMENT MANUFACTURER AND ANY REFERENCE TO THE TRADEMARKS OR PART NUMBERS OF OTHERS ARE FOR CROSS REFERENCE INFORMATIONAL PURPOSES ONLY. THE TRADEMARKS OF OTHERS REFERRED TO HEREIN ARE OWNED BY THEIR RESPECTIVE COMPANIES AND ARE NOT AFFILIATED IN ANY WAY WITH MIDWEST TRUCK AND AUTO PARTS, INC.™ MOTIVE GEAR® AND WORLD AMERICAN® ARE THE REGISTERED TRADEMARKS OF MIDWEST TRUCK AND AUTO PARTS, INC.™ NO REPRESENTATION IS MADE WITH RESPECT TO THE SOURCE OF MANUFACTURE OF ANY PARTICULAR PART. © 2005, MIDWEST TRUCK AND AUTO PARTS, INC.™ ALL RIGHTS RESERVED.

# EATON/FULLER® FS6305 SERIES

FIGURE	DESCRIPTION	OEM#	WORLD AMERICAN #
1	MAIN DRIVE GEAR (1.75")	4301750	4301750
	MAIN DRIVE GEAR (1.75")	4301748	4301748
2	BEARING CONE	742259	39590
3	BEARING CUP	675250	39520
4	REVERSE IDLER GEAR	3315672	3315672
5	WASHER	3315673	3315673
6	REVERSE IDLER GEAR	3316163	3316163
7	BEARING	3315674	K40X48X20
8	SPACER	3315676	3315676
9	BEARING	3315674	K40X48X20
10	WASHER	3315673	3315673
11	BEARING	4124075	K55X60X20
12	SPACER	21740	21740
13	BEARING	4124075	K55X60X20
14	M/S 3RD GEAR	4301761	4301761
15	WASHER	3315727	3315727
16	STEEL BALL	10JO6	10JO6
17	SNAP RING	3315728	3315728
18	BEARING	3315737	K50X55X20
19	SPACER	21741	21741
20	BEARING	3315737	K50X55X20
21	M/S 4TH GEAR (A)	4301759	4301759
	M/S 4TH GEAR (B)	4301760	4301760
22	4/5 CLUTCH HUB	4301766	4301766
23	4/5 SYNCHRONIZER CUP	4301467	4301467
24	4/5 SYNCHRONIZER	A-6137	A6137
25	4/5 SYNCHRONIZER CUP	4301467	4301467
26	BEARING CONE	710787	31594
27	BEARING	3315703	K70X76X20A
28	SPACER	21738	21738
29	BEARING	3315703	K70X76X20A
30	M/S 1ST GEAR	4301763	4301763
31	WASHER	3315719	3315719
32	STEEL BALL	10JO6	10JO6
33	SNAP RING	3315717	3315717
34	BEARING	3315722	K65X70X20
35	SPACER	21739	21739
36	BEARING	3315722	K65X70X20
37	M/S 2ND GEAR	4301762	4301762
38	2/3 HUB GEAR	4301765	4301765
39	SNAP RING	3315725	3315725
40	2/3 SYNCHRONIZER CUP	4301466	4301466
41	2/3 SYNCHRONIZER	A-6156	A6156
42	2/3 SYNCHRONIZER CUP	4301466	4301466
43	BEARING CONE	5557003	5557003
44	WASHER	3315704	3315704
45	M/S REVERSE GEAR	4301764	4301764
46	BEARING	3315703	K70X76X20A
47	SPACER	21738	21738
48	BEARING	3315703	K70X76X20A
49	1ST/REV SYNCHRONIZER	A-6154	A6154
50	1ST/REV SYNCHRONIZER CUP	4301465	4301465
51	MAINSHAFT	4301758	4301758

PARTS LISTED IN THIS CATALOG ARE NOT NECESSARILY MANUFACTURED BY THE ORIGINAL EQUIPMENT MANUFACTURER AND ANY REFERENCE TO THE TRADEMARKS OR PART NUMBERS OF OTHERS ARE FOR CROSS REFERENCE INFORMATIONAL PURPOSES ONLY. THE TRADEMARKS OF OTHERS REFERRED TO HEREIN ARE OWNED BY THEIR RESPECTIVE COMPANIES AND ARE NOT AFFILIATED IN ANY WAY WITH MIDWEST TRUCK AND AUTO PARTS, INC.™ MOTIVE GEAR® AND WORLD AMERICAN® ARE THE REGISTERED TRADEMARKS OF MIDWEST TRUCK AND AUTO PARTS, INC.™ NO REPRESENTATION IS MADE WITH RESPECT TO THE SOURCE OF MANUFACTURE OF ANY PARTICULAR PART. © 2005, MIDWEST TRUCK AND AUTO PARTS, INC.™ ALL RIGHTS RESERVED.

# EATON/FULLER® FS6305 SERIES (cont'd)

FIGURE	DESCRIPTION	OEM#	WORLD AMERICAN #
52	C/S 3RD GEAR (A, B)	3316200	3316200
53	C/S 4TH GEAR (A)	3316198	3316198
54	SPACER	3316251	3316251
55	C/S 5TH GEAR (A, B)	3316196	3316196
56	SNAP RING	3315751	3315751
57	BEARING CONE	791943	25590
58	BEARING CUP	1313645	25522
59	WASHER	3315687	3315687
60	SNAP RING	3315686	3315686
61	BEARING CONE	658981	3782
62	BEARING CUP	660181	3720
63	COUNTERSHAFT	3316194	3316194
64	KEY (2)	230292	230292
65	C/S 2ND GEAR (A, B)	3316202	3316202
N/A	SMALL PARTS KIT	K-7026	K7026
N/A	GASKET KIT	K-7028	K7028
N/A	BEARING REPAIR KIT	K-7035	K7035



PARTS LISTED IN THIS CATALOG ARE NOT NECESSARILY MANUFACTURED BY THE ORIGINAL EQUIPMENT MANUFACTURER AND ANY REFERENCE TO THE TRADEMARKS OR PART NUMBERS OF OTHERS ARE FOR CROSS REFERENCE INFORMATIONAL PURPOSES ONLY. THE TRADEMARKS OF OTHERS REFERRED TO HEREIN ARE OWNED BY THEIR RESPECTIVE COMPANIES AND ARE NOT AFFILIATED IN ANY WAY WITH MIDWEST TRUCK AND AUTO PARTS, INC.™ MOTIVE GEAR® AND WORLD AMERICAN® ARE THE REGISTERED TRADEMARKS OF MIDWEST TRUCK AND AUTO PARTS, INC.™ NO REPRESENTATION IS MADE WITH RESPECT TO THE SOURCE OF MANUFACTURE OF ANY PARTICULAR PART. © 2005, MIDWEST TRUCK AND AUTO PARTS, INC.™ ALL RIGHTS RESERVED.