

FSM-5005

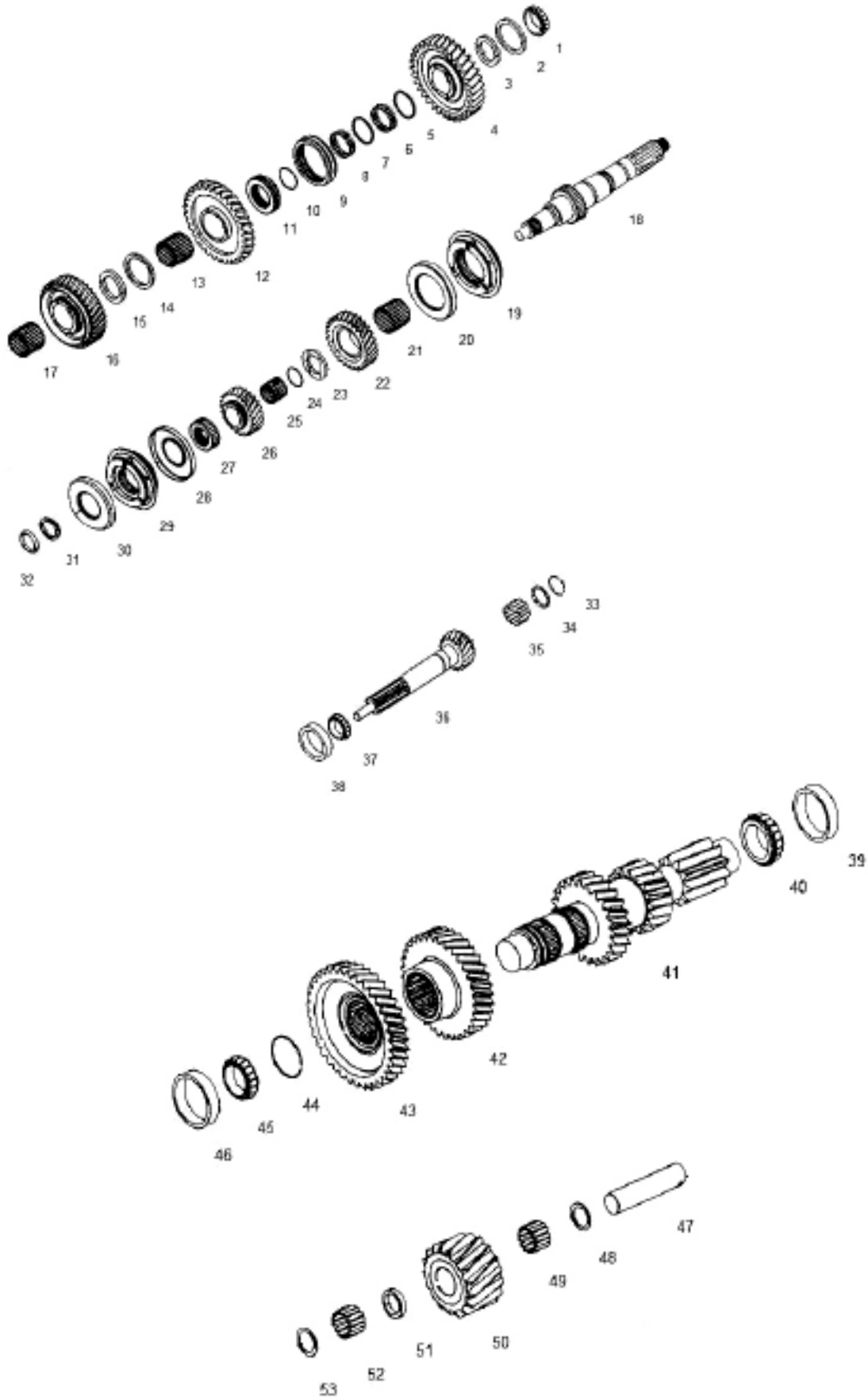

PARTS LISTED IN THIS CATALOG ARE NOT NECESSARILY MANUFACTURED BY THE ORIGINAL EQUIPMENT MANUFACTURER AND ANY REFERENCE TO THE TRADEMARKS OR PART NUMBERS OF OTHERS ARE FOR CROSS REFERENCE INFORMATIONAL PURPOSES ONLY. THE TRADEMARKS OF OTHERS REFERRED TO HEREIN ARE OWNED BY THEIR RESPECTIVE COMPANIES AND ARE NOT AFFILIATED IN ANY WAY WITH MIDWEST TRUCK AND AUTO PARTS, INC.™ MOTIVE GEAR® AND WORLD AMERICAN® ARE THE REGISTERED TRADEMARKS OF MIDWEST TRUCK AND AUTO PARTS, INC.™ NO REPRESENTATION IS MADE WITH RESPECT TO THE SOURCE OF MANUFACTURE OF ANY PARTICULAR PART. © 2005, MIDWEST TRUCK AND AUTO PARTS, INC.™ ALL RIGHTS RESERVED.

TREMEC® FSM-5005

FIGURE	DESCRIPTION	OEM#	WORLD AMERICAN #
1	BEARING CONE	28580A	237227
2	OIL SEAL	235375	235375
3	SPLIT WASHER (2)	235374	235374
4	M/S 1ST GEAR	EO4 0121 AA	5005M-12
5	SNAP RING	235431	235431
6	BEARING	235376	235376
7	SNAP RING	235431	235431
8	BEARING	235376	235376
9	SLIDING CLUTCH	MC4 0058 AA	5005M-15
10	RETAINING RING	235372	235372
11	CLUTCH HUB 1ST/REV.	MC4 0056 AA	5005M-81
12	M/S REVERSE GEAR	EO4 0055 AA	5005M-36
13	BEARING	F94490	239653
14	OIL SEAL	235379	235379
15	SPLIT WASHER (2)	SE4 0064 AA	SE4 0064 AA
16	M/S 2ND GEAR	EO4 0542 AA	5005M-31
17	BEARING	F94490	239653
18	MAINSHAFT	TEFP0145	5005M-2
19	2/3 SYNCHRONIZER	EE4 0069 AA	5005M-2.5
20	2/3 SYNCHRONIZER CUP	CS4 0077 AA	5005M-83
21	BEARING	239653	239653
22	M/S 3RD GEAR	EO4 0122 AB	5005M-18
	M/S 3RD GEAR	EO4 0144 AA	5005M-18A
23	WASHER	SE4 0075 AA	SE4 0075 AA
24	RETAINING RING	224069	224069
25	BEARING	BA4 0062 AA	BA4 0062 AA
26	M/S 4TH GEAR	EO4 0123 AA	5005M-11
	M/S 4TH GEAR	EO4 0145 AA	5005M-11A
27	CLUTCH HUB 4TH/5TH	TEMZ0146	5005M-2.5
28	4/5 SYNCHRONIZER CUP	CS4 0541 AA	5005M-14
29	4/5 SYNCHRONIZER	EE4 0079 AA	5005M-80
30	4/5 SYNCHRONIZER CUP	CS4 0541 AA	5005M-14
31	BEARING	235382	96828
32	BEARING RACE	235383	235383
33	SNAP RING	235416	235416
34	WASHER	235415	235415
35	NEEDLE BEARING	235414	235414
36	MAIN DRIVE GEAR	TEFM0394	5005M-16
	MAIN DRIVE GEAR	TEFM0396	5005M-16A

PARTS LISTED IN THIS CATALOG ARE NOT NECESSARILY MANUFACTURED BY THE ORIGINAL EQUIPMENT MANUFACTURER AND ANY REFERENCE TO THE TRADEMARKS OR PART NUMBERS OF OTHERS ARE FOR CROSS REFERENCE INFORMATIONAL PURPOSES ONLY. THE TRADEMARKS OF OTHERS REFERRED TO HEREIN ARE OWNED BY THEIR RESPECTIVE COMPANIES AND ARE NOT AFFILIATED IN ANY WAY WITH MIDWEST TRUCK AND AUTO PARTS, INC.™ MOTIVE GEAR® AND WORLD AMERICAN® ARE THE REGISTERED TRADEMARKS OF MIDWEST TRUCK AND AUTO PARTS, INC.™ NO REPRESENTATION IS MADE WITH RESPECT TO THE SOURCE OF MANUFACTURE OF ANY PARTICULAR PART. © 2005, MIDWEST TRUCK AND AUTO PARTS, INC.™ ALL RIGHTS RESERVED.

TREMEC® FSM-5005 (cont'd)

FIGURE	DESCRIPTION	OEM#	WORLD AMERICAN #
37	BEARING CONE	235418	235418
38	BEARING CUP	235417	235417
39	BEARING CUP	6554166	25520
40	BEARING CONE	791943	25590
41	COUNTERSHAFT	TE4 0125 AB	5005M-3
	COUNTERSHAFT	TE4 0147 AA	5005M-3C
42	C/S 4TH GEAR	EO4 0127 AB	5005M-44A
	C/S 4TH GEAR	EO4 0149 AA	5005M-44A
43	C/S 5TH GEAR	EO4 0126 AA	5005M-9
44	SNAP RING	791943	224024
45	BEARING CONE	791943	25590
46	BEARING CUP	6554166	25520
47	IDLER SHAFT	BR4 0018 AA	5005M-35
48	SPACER	SE4 0020 AA	SE4 0020 AA
49	NEEDLE BEARING	BA4 0021 AA	BA4 0021 AA
50	IDLER GEAR	EL4 0083 AA	5005M-10
51	SPACER	235413	235413
52	NEEDLE BEARING	BA4 0021 AA	BA4 0021 AA
53	SPACER	SE4 0020 AA	SE4 0020 AA



PARTS LISTED IN THIS CATALOG ARE NOT NECESSARILY MANUFACTURED BY THE ORIGINAL EQUIPMENT MANUFACTURER AND ANY REFERENCE TO THE TRADEMARKS OR PART NUMBERS OF OTHERS ARE FOR CROSS REFERENCE INFORMATIONAL PURPOSES ONLY. THE TRADEMARKS OF OTHERS REFERRED TO HEREIN ARE OWNED BY THEIR RESPECTIVE COMPANIES AND ARE NOT AFFILIATED IN ANY WAY WITH MIDWEST TRUCK AND AUTO PARTS, INC.™ MOTIVE GEAR® AND WORLD AMERICAN® ARE THE REGISTERED TRADEMARKS OF MIDWEST TRUCK AND AUTO PARTS, INC.™ NO REPRESENTATION IS MADE WITH RESPECT TO THE SOURCE OF MANUFACTURE OF ANY PARTICULAR PART. © 2005, MIDWEST TRUCK AND AUTO PARTS, INC.™ ALL RIGHTS RESERVED.